

Submitted by:		Date:
Type:	Project:	
Ordering Info:		

High Performance 3" Aperture (HP-3) Wall Mount

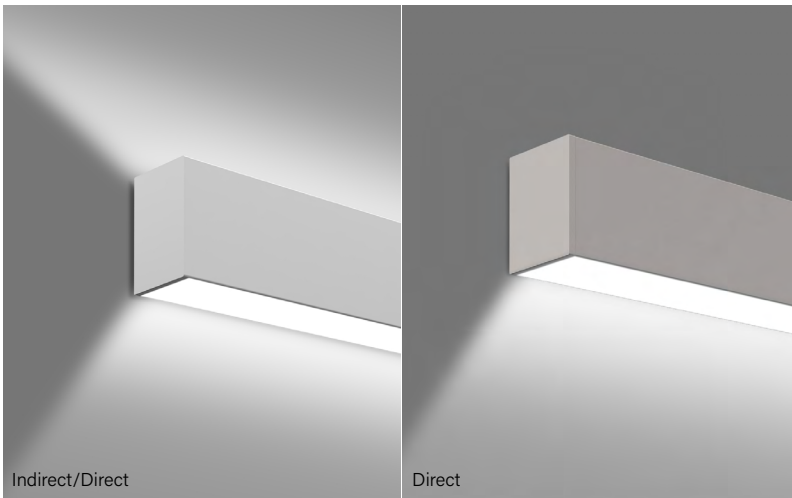

Signal White is standard finish

HP-3 is a compact, streamlined, 3-inch-wide linear luminaire with recycled aluminum housing, advanced optics, and mid-power LEDs. It features an innovative assembly design, an easy-to-use joiner for continuous runs, and seamless installation. Backed by a 10-year warranty, it is available in 179 RAL color options to suit any project.

This product is enrolled in the International Living Future Institute (ILFI) Declare 2.0 Program and is third-party verified with options achieving **Red List Approved** and **Red List Declared** status.

CROSS SECTIONS

Indirect/Direct

Flush Uplight Diffuser (standard)

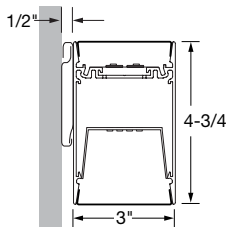

Flush Downlight Diffuser (standard)

Direct

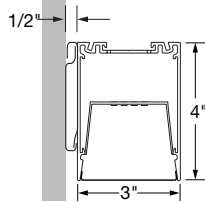

Flush Downlight Diffuser (standard)

OPTIC OPTIONS

Standard Uplight Flush Optic (F)

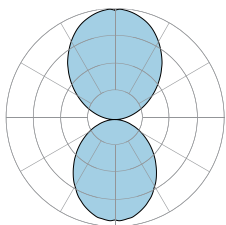

Standard Downlight Flush Optic (F)

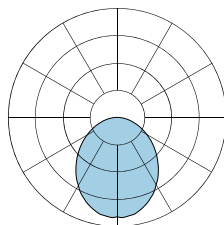

Standard Downlight Flush Optic (F)

ALSO AVAILABLE IN

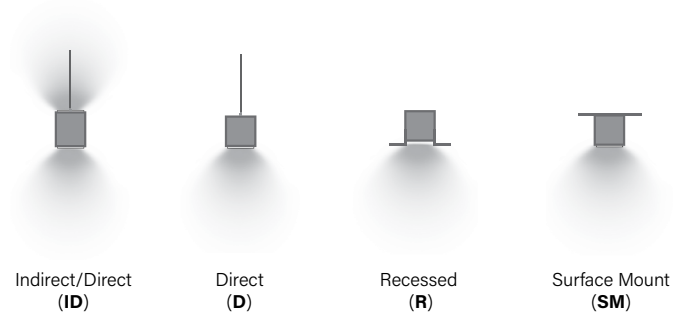

Declare.



Submitted by:		Date:
Type:	Project:	
Ordering Info:		

High Performance 3" Aperture (HP-3) Wall Mount

Ordering Guide Example: HP - 3 - WM - ID - 36' - S - S - 835 - F - F - 96LG - 120 - DC - FC-10% - FA50 - C1 - FE - SW - LGD18W - OBO - CP - SQ4

BODY TYPE

OUTPUT AND LED TYPE

Platform	Series Name	Luminaire Type	Luminaire Distribution	Total Length of Run	Uplight Output (Flush) - ID Only	Downlight Output (Flush) ¹
HP - High Performance	3	WM - Wall Mount	ID - Indirect/Direct D - Direct	Minimum 2' section length. Increments accurate to 1/16" (±1/32"), standard. 12' maximum section length. Use Configuration section to specify size and shape.	S - Standard (678 lm/ft) B - Boosted (848 lm/ft) H - High (955 lm/ft) V - Very High (1221 lm/ft) TL - Tailored: _____ lm/ft*	S - Standard (578 lm/ft) B - Boosted (723 lm/ft) H - High (814 lm/ft) V - Very High (1040 lm/ft) TL - Tailored: _____ lm/ft*

Lumen provided above are for Flush lens only, see pg. 11 for WW lumens.
* Specify Tailored lm/ft of outputs between Standard (S) and Very High (V). Consult factory for tailored lumen output outside of this range.

OUTPUT AND LED TYPE

MECHANICAL/OPTICAL OPTIONS

ELECTRICAL OPTIONS

LED CRI/CCT	Uplight Optics - ID Only	Downlight Optics	Reflector System	Voltage
830 - 80 CRI, 3000K 835 - 80 CRI, 3500K 840 - 80 CRI, 4000K 930 - 90 CRI, 3000K ¹ 935 - 90 CRI, 3500K ¹ 940 - 90 CRI, 4000K ¹ 8TW - 80 CRI, Tunable White ¹ 9TW - 90 CRI, Tunable White ¹	F - Flush (standard) TG - Top Glow ASY-L - Asymmetric Left Optic ASY-R - Asymmetric Right Optic WSO - Widespread Optic	F - Flush (standard) BG - Bottom Glow DAO-L - Downlight Asymmetric Optic Left DAO-R - Downlight Asymmetric Optic Right DSO - Downlight Spread Optic	96LG - 96 Low Gloss White	120 - 120 Voltage 277 - 277 Voltage 347 - 347 Voltage (OTi only)
				Circuiting²
				SC - Single Circuit* One single circuit in a run DC - Dual Circuit* Independent control of up and down separately in an I/D style fixture MC - Multi-Circuit* More than one switch leg or zone. Factory shop drawings required * Battery, Night Light and Emergency to Generator circuits are in addition to the normal luminaire circuit(s)

ELECTRICAL OPTIONS

MOUNTING OPTIONS

OTHER OPTIONS

Driver Selection	Mounting Method	Endcap Style	Emergency Style (Optional) <small>See page 5 Backup Battery table</small>
0-10V Driver Options FC-10% - 0-10V 10% (standard) FC-1% - 0-10V 1% OTi-10% - EldoLED OTi, 0-10V 10% ³ OTi-1% - EldoLED OTi, 0-10V 1% ³ ELD-10V-0% - EldoLED SOLOdrive, 0-10V 0.1% 10V-TW-10% - EldoLED OTi, 0-10V 10% (Tunable White) DALI Driver Options FC-DALI-1% - DALI 1% DXL-DALI-1% - EldoLED Dexas, 1% ELD-DALI-0% - EldoLED SOLOdrive, 0.1% ELD-DALI-TW - EldoLED DUALdrive LightShape, 0.1% (Tunable White) DMX Driver Options ELD-DMX - EldoLED POWERdrive, 0.1% ELD-DMX-TW - EldoLED POWERdrive, 0.1% (Tunable White) Lutron Driver Options LUT-ES1 - Lutron, Ecosystem 1% LUT-TW - Lutron LD2 Dali-2 1% (Tunable White) <small>See Page 3 for additional driver options and details</small>	MB - Mounting Bracket	FE - Flat Endcap (standard) Finish SW - Signal White (standard) FB - Finelite Black (15 day lead time) SA - Satin Aluminum (15 day lead time) MM01 - Gray Elm ⁴ MM02 - White Oak ⁴ MM03 - Teak ⁴ MM04 - Walnut ⁴ #### - RAL Color Code ⁴ Material Mimic (MM) RLA & RLD pending	LGD18W - Legrand 18W Brand Battery Back up LGD10W - Legrand 10W Brand Battery Back up BSL310LP - Bodine Battery Back up Low Profile BSL10T3 - Bodine Battery Back up Low Profile Compact EM/GEN - Emergency to Generator NL - Night Light GTD - Generator Transfer Device ALCR - Automatic Load Control Relay <small>See Backup Battery table on page 5 for fitment limitations</small>

OTHER OPTIONS

Integrated Sensor (Optional)	Special Options (Optional)
OB01 - WS FS-305 w/ FS-L6 lens on/off (max mounting height 8") OCC Sensor OB02 - WS FS-305 w/ FS-L3W lens on/off (max mounting height 20") OCC Sensor OB03 - WS FS-305D w/ FS-L6 lens Dim to 50% (max mounting height 8") OCC Sensor OB04 - WS FS-305D w/ FS-L3W lens Dim to 50% (max mounting height 20") OCC Sensor OBD - Daylight W601 - Wattstopper Wireless Sensor ⁵ CLM - Wattstopper Plus RF <small>See Backup Battery table on page 5 for fitment limitations</small>	SLM - Wattstopper Plus Sensor RE7 - nLight Occupancy & Daylight ⁶ NE7 - nLight Occupancy ⁶ AOCC-W - Lutron Athena Sensor ⁷ (Device Color White) AOCC-B - Lutron Athena Sensor ⁷ (Device Color Black) ARF-W - Lutron Athena RF ⁷ (Device Color White) ARF-B - Lutron Athena RF ⁷ (Device Color Black) VOCC - Lutron Vive Sensor ⁸ VRF - Lutron Vive RF ⁸ CP - Chicago Plenum ⁹ RLA - Red List Approved ¹⁰ RLD - Red List Declared ¹⁰

¹ DLC not available

² Contact factory for switching options

³ Add DTO to gain "Dim to Off" functionality (FC-10% - DTO, FC-1% - DTO)

⁴ 20 business days lead time for MM and color

⁵ LMFS-601 w/ 0-10V driver(s) and LMFI-111, up to 6 drivers may be connected.

⁶ LMFS-601 w/ Dali driver, only 1 driver can be connected.

⁷ Contact Factory

⁸ 0-10V Drivers - AOCC up to 10 drivers may be connected; ARF up to 40 driver may be connected

⁹ DALI Drivers - AOCC & ARF up to 4 drivers can be connected

¹⁰ Lutron Vive Integrated Sensors require a DALI driver. Contact factory for Indirect Distribution.

¹¹ Only available with C1, C2, and C3 mounting hardware with Finelite Gridbox

¹² Refer to page 5 for Declare Program Overview information

Submitted by:		Date:
Type:	Project:	
Ordering Info:		

High Performance 3" Aperture (HP-3) Wall Mount

SUPPLEMENTARY DRIVER PAGE

0-10V Driver Options

FC-10%	Factory Choice, 0-10V 10% Dimming (Linear)
FC-10%-DTO	Factory Choice, 0-10V 10% Dimming, Dim-to-Off (Linear)
FC-1%	Factory Choice, 0-10V 1% Dimming (Linear)
FC-1%-DTO	Factory Choice, 0-10V 1% Dimming, Dim-to-Off (Linear)
ELD-10V-0%	EldoLED SOLOdrive, 0-10V 0.1% Dimming (Linear)
ELD-10V-1%	EldoLED ECOdrive, 0-10V 1% Dimming (Linear)
10V-TW-10%	EldoLED OTi, 0-10V 10% Dimming, <i>Tunable White</i> (Linear)
10V-TW-10%-DTO	EldoLED OTi, 0-10V 10% Dimming, Dim-to-Off, <i>Tunable White</i> (Linear)
OTi-10%	EldoLED OTi, 0-10V 10% Dimming (Linear)
OTi-10%-DTO	EldoLED OTi, 0-10V 10% Dimming, Dim-to-Off (Linear)
OTi-1%	EldoLED OTi, 0-10V 1% Dimming (Linear)
OTi-1%-DTO	EldoLED OTi, 0-10V 1% Dimming, Dim-to-Off (Linear)

DALI Driver Options

FC-DALI-1%	Factory Choice, DALI 1% Dimming (Logarithmic)
DXL-DALI-1%	EldoLED Dexal, DALI 1% Dimming (Logarithmic)
ELD-DALI-0%	EldoLED SOLOdrive, DALI 0.1% Dimming (Logarithmic)
ELD-DALI-1%	EldoLED ECOdrive, DALI 1% Dimming (Logarithmic)
ELD-DALI-TW	EldoLED DUALdrive Light Shape, DALI 0.1% Dimming, <i>Tunable White</i> (Logarithmic Dimming , Linear CCT Control)

DMX Driver Options

ELD-DMX	EldoLED POWERdrive, DMX 0.1% Dimming (8 Bit, 1CH) (Linear)
ELD-DMX-16	EldoLED POWERdrive, DMX 0.1% Dimming (16 Bit, 2CH) (Linear)
ELD-DMX-TW	EldoLED POWERdrive, DMX 0.1% Dimming, <i>Tunable White</i> (8 Bit, 2CH - CH1 Warm / CH2 Cool) (Linear)
ELD-DMX-TW16	EldoLED POWERdrive, DMX 0.1% Dimming, <i>Tunable White</i> (16 Bit, 4CH - CH1, 2 Warm / CH3, 4 Cool) (Linear)

Lutron Driver Options

LUT-ES1	Lutron, Ecosystem 1% Dimming
LUT-TW	Lutron LD2 Dali-2 1%, <i>Tunable White</i>

Submitted by:		Date:
Type:	Project:	
Ordering Info:		

High Performance 3" Aperture (HP-3) Wall Mount

SPECIFICATIONS

BODY TYPE

CONSTRUCTION: Precision-cut 6063-T6 extruded recycled aluminum body. Internal joiner system, plug-together wiring, standard.

LENGTHS: Any length, 2' minimum, in increments down to 1/16" (±1/32"). 12' maximum section length.

OUTPUT AND LED TYPE

LIGHT OUTPUT: Four lumen packages available, Standard (S), Boosted Standard (B), High (H), and Very High (V). For lengths 3' and greater, the uplight and downlight can be specified with different lumen packages and dual controls. For Tailored Outputs outside of range from Standard (S) to Very High (V), consult factory. Light engines are replaceable.

WELL Building, feature L04 Electric Light Glare control:

HP-3 D Flush: 80CRI - Tailored to 417 lumens/ft, 80 CRI - S; 90CRI - S



LEED v5, interior Lighting Indoor Environmental Quality

(qualify for LEED v4.1): HP-3 D Flush: 80CRI - S, 90CRI - S



MECHANICAL/OPTICAL OPTIONS

UPLIGHT OPTION: 12 ft. maximum diffuser length. 73% transmissive, 99% diffusion. Internal secondary diffusers at corners ensure visually seamless, uniform, continuous illumination. Options include: Flush frost white snap-in diffuser, 73% transmissive, 99% diffusion; Widespread Optic (WSO); WSO enables increased luminaire spacing with improved ceiling uniformity. Asymmetric optic directs light in a specific direction. ASY-L distributes light to the left, ASY-R distributed light to the right of the luminaire. Consult factory for more tailored lumen outputs.

DOWNLIGHT OPTION: 12' maximum diffuser length. Flush frost white snap-in diffuser standard, 77% transmissive, 99% diffusion. Internal secondary diffusers at corners ensure visually seamless, uniform, continuous illumination. Available with Flush (F), Top Glow (TG), Bottom Glow (BG), Downlight Spread Optic (DSO), Downlight Asymmetric Optic Left and Right (DAO-L, DAO-R). Consult factory for more tailored lumen outputs.

LUMEN MAINTENANCE: 90% of initial light output (L90) at 60,000+ hours.

REFLECTORS: Die-formed 24-gauge cold-rolled steel reflectors finished in 96LG High Reflectance white powder coat paint.

ELECTRICAL OPTIONS

STATIC WHITE FEED: Standard with one 18-gauge/5-conductor single-circuit feed controlling uplight and downlight together (power and dimming). Specify dual feeds for independent control of uplight and downlight. 14-gauge feed used when luminaire current exceeds 5 amps.

TUNABLE WHITE FEED: Standard with one 18-gauge/5-conductor single-circuit feed. 14-gauge feed used when fixture current exceeds 5 amps. DMX feeds cannot be cut or spliced. DMX feeds should be ordered based on fixed lengths.

0-10V:

- One 18-gauge / 3-conductor power
- One 18-gauge / 4-conductor for dimming and controls

Dali:

- One 18-gauge / 5-conductor power and controls

DMX:

- One 18-gauge / 3-conductor power
- One DMX feed

STATIC WHITE DRIVER: Replaceable 120V, 277V, and 347V constant current reduction dimming driver standard. Can be wired dimming or non-dimming. 0-10V dimming controls with a range of 100%-10% standard. Dimming to 1% available. Separate dimming for uplight and downlight available. Driver is fully accessible from below the ceiling.

Power Factor: ≥ 0.9

Total Harmonic Distortion (THD): <20%

Expected driver lifetime: 100,000 hours

LUTRON DRIVER OPTIONS:

LUT-ES1 - Hi-lume 1% EcoSystem with Soft-On, Fade-to-Black dimming (LDE1 series).

TUNABLE WHITE DRIVER: Replaceable LED driver. Driver is accessible from below the ceiling. 120V and 277V.

Power factor: ≥0.9

Total Harmonic Distortion (THD): <20%

Dimming Range: 100%-10%

Expected Driver Lifetime: 100,000 hours

LUTRON TUNABLE WHITE DRIVER OPTION:

LUT-TW - Lutron LD2 Dali-2 1%, Tunable White.

MOUNTING OPTIONS

HANGING HARDWARE: Wall Mount: Luminaire hangs securely from mounting brackets fastened directly to the wall for easy installation. Luminaire stands 1/2" off the wall. The mounting bracket is concealed behind the luminaire.

TUNABLE WHITE DMX HANGING HARDWARE: For grid ceiling applications the dual GridBox™ mounting is supplied (standard). For hard ceiling applications the ceiling mounting box is supplied (standard). DMX feeds cannot be cut or spliced. DMX feeds should be ordered based on fixed lengths. Available DMX pendant feed lengths are 5' (standard), 12', and 30'.

TUNABLE WHITE DMX INTERCONNECTION CABLES: Luminaires are prewired with plug-and-play interconnected cables to support easy plug-together joining of fixture runs. DMX to RJ45 adapters and an RJ45 terminator for every 32 DMX drivers are included.

OTHER OPTIONS

ENDCAPS: Flat diecast aluminum endcaps (FE) add 1/4" to each end of luminaire.

EMERGENCY STYLE: Optional emergency to generator/inverter wiring, internal generator transfer switch, nightlight wiring, step- dimming driver, backup battery.

Backup Battery		
	Legrand 18W	Legrand 10W/ Bodine BSL310LP
HP3-WM-ID		
Min. Housing Length	12'	8'
EM Lumen Output	2088	1243
EM Section Illum.	2'	2' or 4'
HP3-WM-D		
Min. Housing Length	8'	4'
EM Lumen Output	2088	1243
EM Section Illum.	2'	2' or 4'

* Minimum fixture housing length for battery pack approved without sensor
The lumens are based on 835. For other CCT/CRI, refer to the Lumen Adjustment Factor table on page 6.

Submitted by:		Date:
Type:	Project:	
Ordering Info:		

High Performance 3" Aperture (HP-3) Wall Mount

SPECIFICATIONS

Bodine GTD and Legrand ALCR Min. Length	
Configuration	Min Length
Generator	D-2' ID-3'
Generator + OCC	D-2' ID-3'
Daylight	D-2' ID-3'
Generator + Daylight	D-2' ID-3'

(RAL 9005) with semi gloss fine texture (**FB**)¹, and Satin Aluminum (**SA**)¹ are available. Material Mimic options^{2,4}: Gray Elm (**MM01**), White Oak (**MM02**), Teak (**MM03**), Walnut (**MM04**). Optional Adder: 179 RAL colors² are available.

LABELS: Luminaire and electrical components are ETL-listed conforming to UL 1598 in the U.S.A. and CAN/CSA C22.2 No. 250.0 in Canada. In accordance with NEC Code 410.130 (G), this luminaire contains an internal driver disconnect. UL 924 and UL 2108 - PoE options available on request. These fixtures are rated for Damp Location. Finelite products use electronic components that are RoHS compliant, and the mechanical components of the luminaire have been verified to not knowingly contain any restricted substances listed per RoHS Directive 2015/863. Consult factory for tailored lighting options. Finelite makes the specification process easy when putting healthier products on your projects. Simply add – **RLA** (Red List Approved) or – **RLD** (Red List Declared) to your part number ([Declare Program Overview](#)).

TUNABLE WHITE ELECTRICAL OPTIONS:

TW Driver Options

- **0-10V:** EM/GEN, GTD or Battery Back Up
- **DMX:** Battery Back Up
- **DALI:** EM/GEN, GTD or Battery Back Up
- **LUTRON:** EM/GEN, GTD or Battery Back Up

WEIGHT³: ID - 3.2 lb/ft; D - 2.8 lb/ft

INTEGRATED SENSORS: Integrated PIR (Passive Infrared) Occupancy (**OBO**) or Daylight Sensors (**OBD**) available with Flush and Bottom Glow downlight diffusers. PIR sensors not recommended for stairwell applications. Refer to Occupancy Sensor & Daylight Sensor tech sheet and the Embedded Intelligence landing page for more information and additional sensor options.

WARRANTY: 10-year performance-based warranty on all standard components. Optional accessories such as emergency battery packs are covered by their individual manufacturer warranties.

FINISHES: Finelite Signal White (**SW**) powder coat is standard. Finelite Black

MATERIAL MIMIC OPTIONS^{2,4}



Gray Elm (**MM01**)

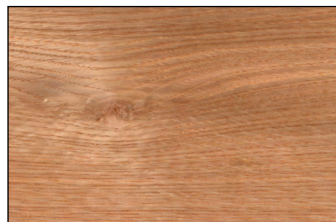

White Oak (**MM02**)



Teak (**MM03**)

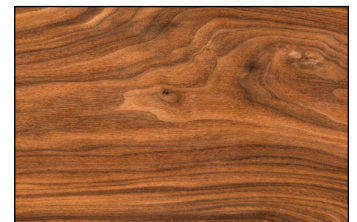

Walnut (**MM04**)

The appearance of Material Mimic finishes may vary due to environmental lighting conditions and surrounding color influences. Sample swatches are available upon request for evaluation in situ under expected lighting and design conditions.

OCCUPANCY SENSOR OPTIONS

FS-L3W top and side coverage patterns

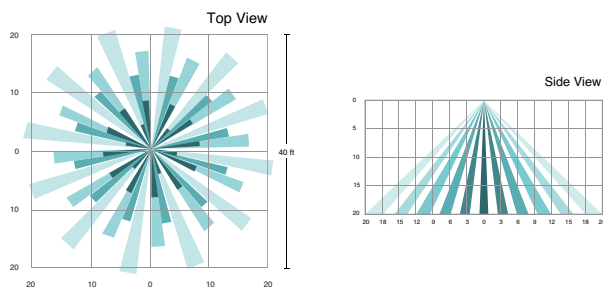

FS-L6 top and side coverage patterns

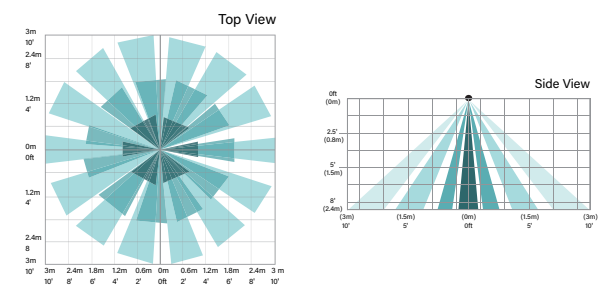

¹ 15 business days lead time

² 20 business days lead time for Material Mimic and color

³ Excludes Battery Backup and Generator Transfer Device weight

⁴ Due to the uniqueness of Material Mimic options, color and grain pattern may vary, sample swatches are available upon request.

Submitted by:		Date:
Type:	Project:	
Ordering Info:		

High Performance 3" Aperture (HP-3) Wall Mount

DOWNLIGHT ASYMMETRIC OPTIONS

The diagrams below show a linear run from power feed to ender. Specifying DAO-L distributes light to the left or DAO-R distributes light to the right. For proper orientation: view luminaire from starter end when specifying the direction of the Downlight Asymmetric optic.

Downlight Asymmetric Optic Left (DAO-L)

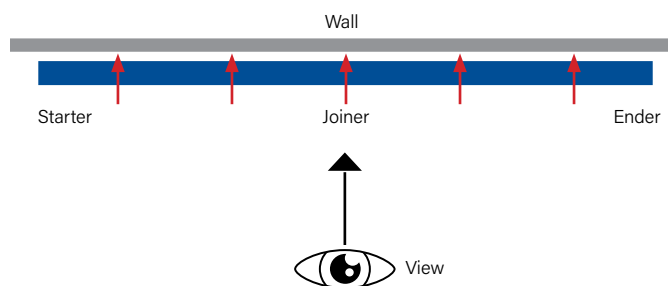
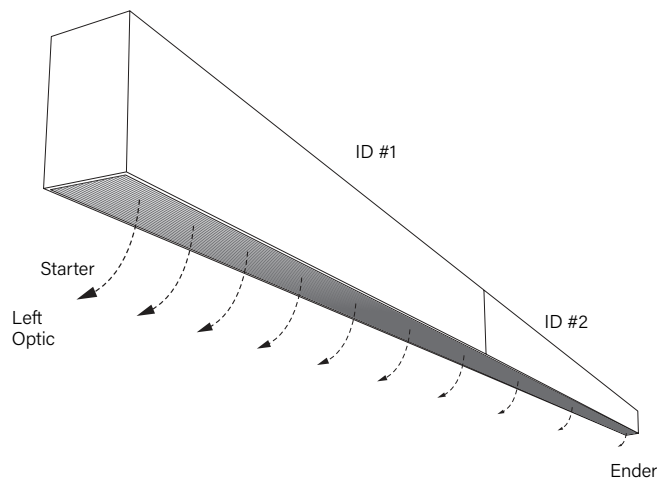

Downlight Asymmetric Optic Right (DAO-R)

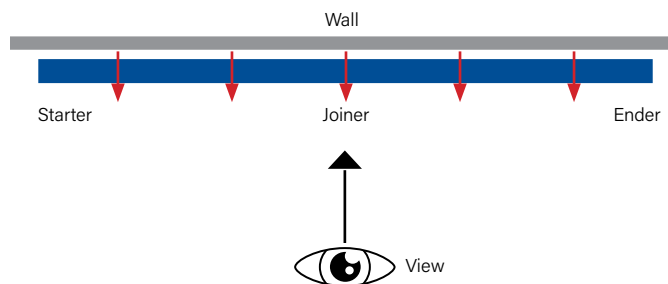
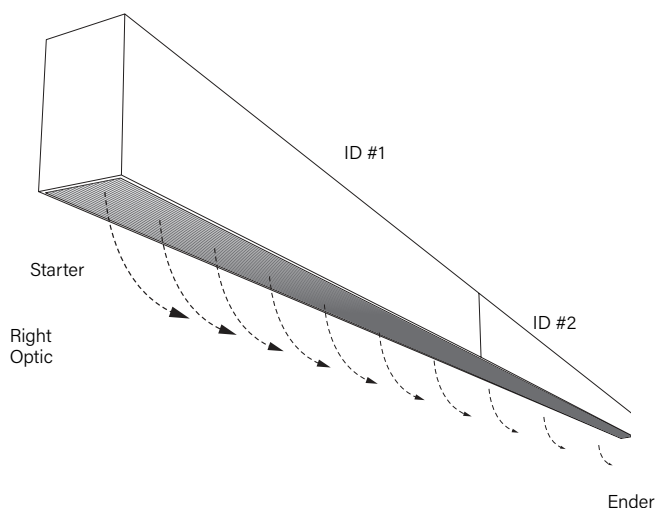

PREINSTALLED LABEL



For DAO, Preinstalled label on diffuser shows direction of light. Remove after installation.

Submitted by:		Date:
Type:	Project:	
Ordering Info:		

High Performance 3" Aperture (HP-3) Wall Mount

ASYMMETRIC OPTIONS

The diagrams below show a linear run from power feed to ender. Specifying ASY-L distributes light to the left or ASY-R distributes light to the right. For proper orientation: view luminaire from starter end when specifying the direction of the Asymmetric optic.

Asymmetric Left Optic (ASY-L)

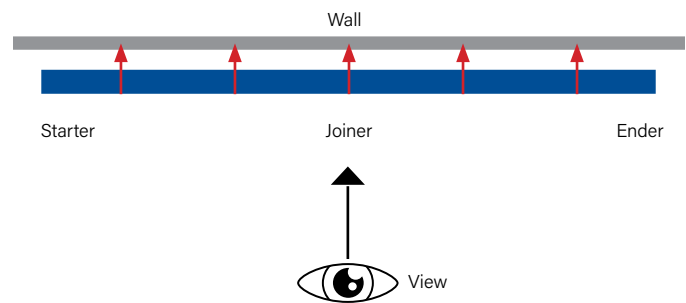
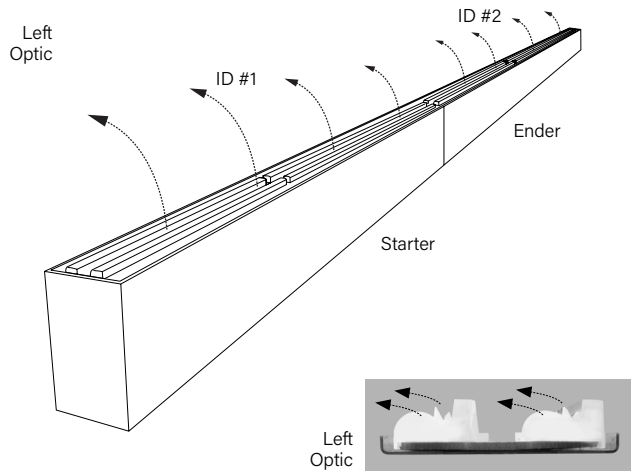

Asymmetric Right Optic (ASY-R)

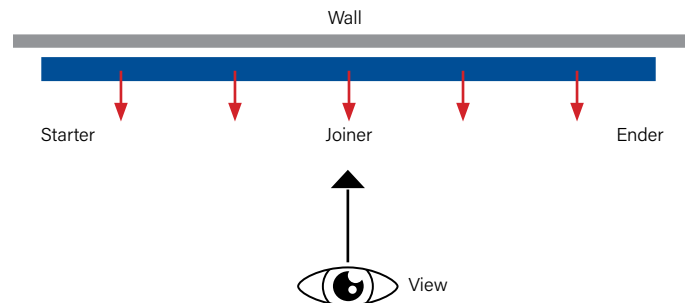
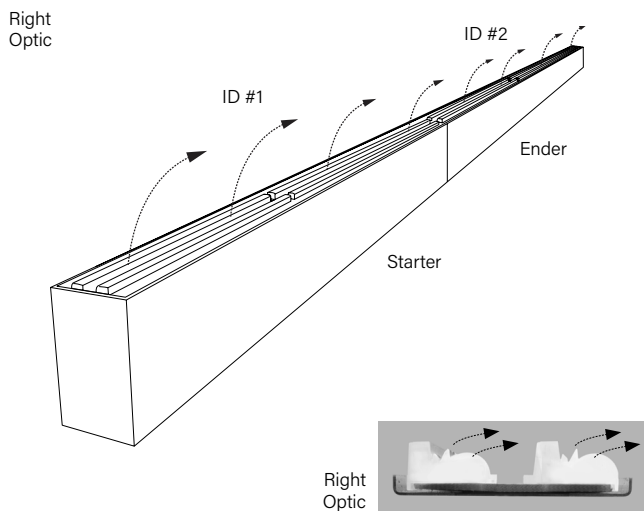

Submitted by:		Date:
Type:	Project:	
Ordering Info:		

High Performance 3" Aperture (HP-3) Wall Mount

Indirect/Direct Photometry - 4' Luminaire 3500K

HP3-P-ID-4'-V-V-835-F -F

Uplight: Flush / **Downlight:** Flush

Distribution: 54% Up (V) / 46% Down (V)

Efficacy: 132 lm/W

Uplight: 4883 lumens (1221 lumens/foot)

Downlight: 4159 lumens (1040 lumens/foot)

Total luminaire output: 9042 lumens (2261 lm/ft)
68.68 watts (171 W/ft)

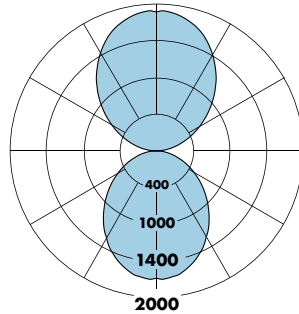

CRI: 80 / CCT: 3500K

NLTL LM79 Report # REP-112524-01

Direct Photometry - 4' Luminaire 3500K

HP3-P-D-4'-V-V-835-F

Downlight: Flush Diffuser

Efficacy: 122 lm/W

Total luminaire output: 4176 lumens (1044 lm/ft)
34.34 watts (8.6 W/ft)

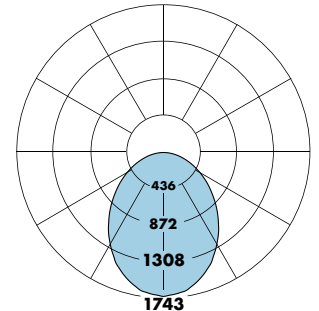

CRI: 80 / CCT: 3500K

NLTL LM79 Report # LM-63-2002

Total Light Output, 3500K, 80 CRI (Lumens) - 4' Luminaire

	1S ¹	1B ¹	1H ¹	1V ²
↓S ¹	5023 [154% 46%↓]	5702 [159% 41%↓]	6127 [162% 38%↓]	7188 [168% 32%↓]
↓B ¹	5605 [148% 52%↓]	6284 [154% 46%↓]	6709 [157% 43%↓]	7770 [163% 37%↓]
↓H ¹	5970 [145% 55%↓]	6649 [151% 49%↓]	7074 [154% 46%↓]	8135 [160% 40%↓]
↓V ²	6880 [139% 61%↓]	7599 [145% 55%↓]	7984 [148% 52%↓]	9042 [154% 46%↓]

Light Output, 3500K, 80 CRI (Lumens Per Foot)

	1S ¹	1B ¹	1H ¹	1V ²
↓S ¹	1256	1426	1532	1797
↓B ¹	1401	1571	1677	1943
↓H ¹	1493	1662	1769	2034
↓V ²	1720	1900	1996	2261

Power, 3500K (Watts Per Foot)

	1S ¹	1B ¹	1H ¹	1V ²
↓S ¹	9.6	10.8	11.5	13.4
↓B ¹	10.8	12.0	12.7	14.6
↓H ¹	11.5	12.7	13.5	15.3
↓V ²	13.4	14.6	15.3	17.1

Efficacy, 3500K, 80 CRI (Lumens Per Watt)

	1S ¹	1B ¹	1H ¹	1V ²
↓S ¹	131	133	133	135
↓B ¹	130	131	132	133
↓H ¹	130	131	131	133
↓V ²	129	130	130	132

S - Standard Output, B - Boosted Standard Output, H - High Output, V - Very High Output

¹ Family Correlation based on 4' luminaire 3500K Very High Output (V) test - 120V.

² Based on NLTL LM79 reports: REP-112524-01

Total Light Output, 3500K, 80 CRI (Lumens) - 4' Luminaire

S ¹	B ¹	H ¹	V ²
2319	2902	3266	4176

Light Output, 3500K, 80 CRI (Lumens Per Foot)

S ¹	B ¹	H ¹	V ²
580	726	817	1044

Power, 3500K (Watts Per Foot)

S ¹	B ¹	H ¹	V ²
6.7	7.3	7.7	8.6

Efficacy, 3500K, 80 CRI (Lumens Per Watt)

S ¹	B ¹	H ¹	V ²
87	100	107	122

S - Standard Output, B - Boosted Standard Output, H - High Output, V - Very High Output

¹ Family Correlation based on 4' luminaire 3500K Very High Output (V) test - 120V.

² Based on NLTL LM79 reports: LM-63-2002

Wattage is Real Power. If you would like additional details to calculate Apparent Power, please contact your local Finelite representative.

Sample Lumen Adjustment Calculation

Lumen Adjustment Factors 80 CRI	
3000K	0.974
3500K	1.000
4000K	1.038

Lumen Adjustment Factors 90 CRI	
3000K	0.745
3500K	0.758
4000K	0.783

High Output (H), 3000K, 80 CRI
Lumen Adjustment Factor: 0.974
Total Light Output: 3266 lm x 0.974 = 3181 lm
Total Light Output per Foot: 817 lm/ft x 0.974 = 796 lm/ft.
watts/foot: 7.7 W/ft.

$$\text{Efficacy} = \frac{796 \frac{\text{lm}}{\text{ft.}}}{7.7 \frac{\text{W}}{\text{ft.}}} = 103 \text{ lm/W}$$

Submitted by:		Date:
Type:	Project:	
Ordering Info:		

0-10V Tunable White

Finelite's contractor friendly Tunable White luminaires are available at low cost, with powerful and simple 0-10V tuning and intensity controls.

TUNABLE WHITE FEATURES

- CCT range: 2700K - 6500K
- Dimming Range: 100% to 10%
- CRI Options: 80 CRI or 90 CRI

Note:
Dim to Off options available.

LUMINAIRE FAMILY MODIFICATIONS/RESTRICTIONS

Direct	Section Lengths										
	2'	3'	4'	5'	6'	7'	8'	9'	10'	11'	12'
Output S,B,H,V Single Circuit	Rows can be comprised of 2'-12' sections. Tailored lengths available.										
Integral Battery Backup (BSL310LP)							✓		✓		✓
Indirect/Direct											
Output S,B Single Circuit	✓	✓	✓	✓	✓	✓	✓	✓	✓	✓	✓
Integral Battery Backup (BSL310LP)							✓		✓		✓
Output H,V Single Circuit		✓					✓				✓
Integral Battery Not Available	Remote Battery backup solution available. Consult factory for tailored lighting options.										
Output S,B,H,V Dual Circuit		✓					✓				✓
Integral Battery Not Available	Remote Battery backup solution available. Consult factory for tailored lighting options.										

EN/GEN sections available for all body lengths

PHOTOMETRY

Apply a power adjustment factor to calculate wattage usage

POWER	CONVERSION FACTOR
	1.1X

(Example: a 50 watt luminaire in static white would draw 55 watts using 0-10V Tunable White)

DUAL FEED DETAIL

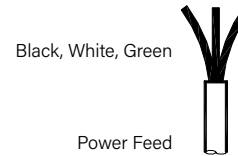

WIRING LEGEND		
Black	Hot	Line Voltage
White	Neutral	Line Voltage
Green	Ground	

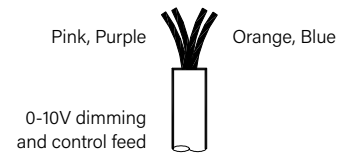

WIRING LEGEND		
Pink	Dimming	0-10V DC
Purple	Dimming	0-10V DC
Orange	TW	0-10V DC
Blue	TW	0-10V DC