

HP-4 Mitered Corner Installation Instructions

Scan QR code for helpful video(s)



0 - 10V Dimming



Mitered Corner Assembly

Step 1

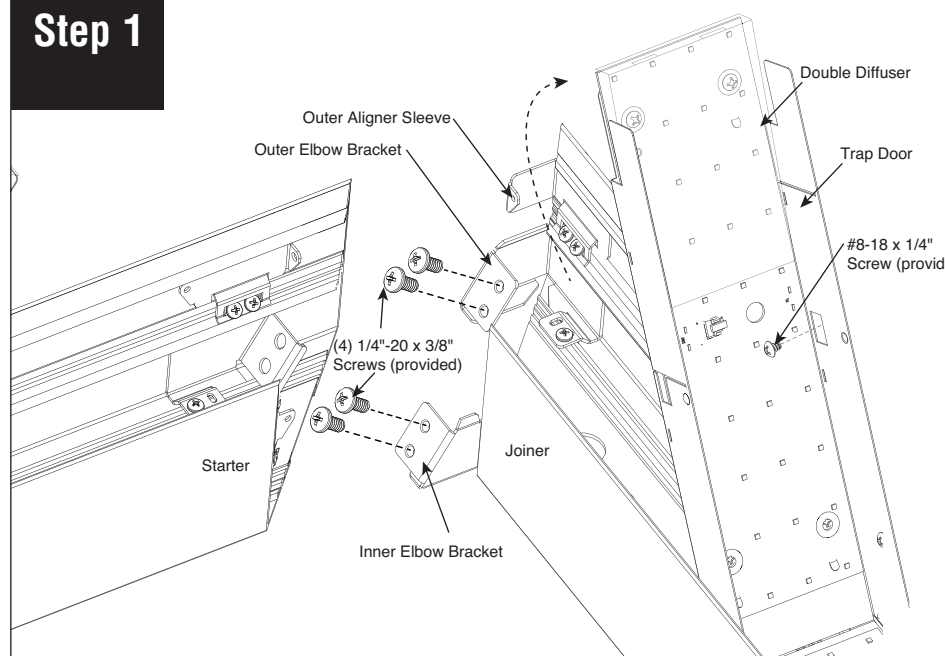

Remove #8-18 x 1/4" screws to open both the joiner and starter trap doors. Then remove four 1/4"-20 x 3/8" screws from both the outer and inner elbow brackets.

Step 2

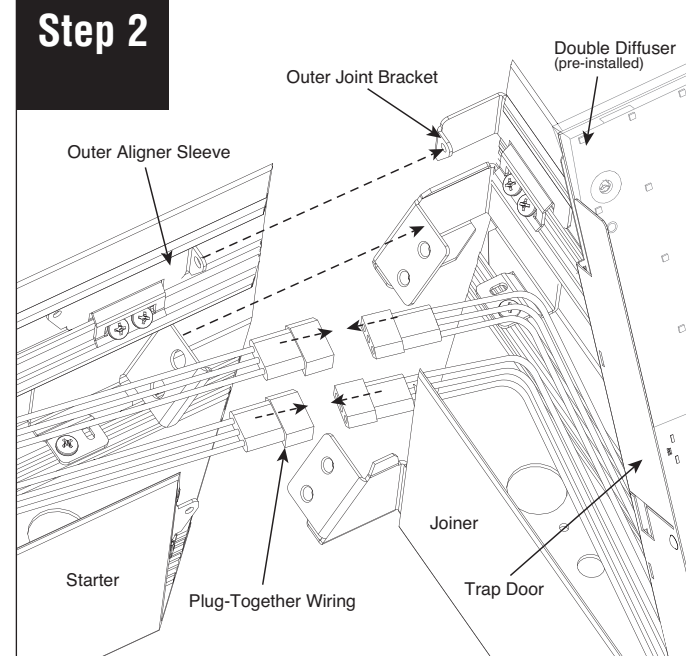

Connect plug-together wiring. Align joint brackets to channels and slide luminaires together.

Step 3

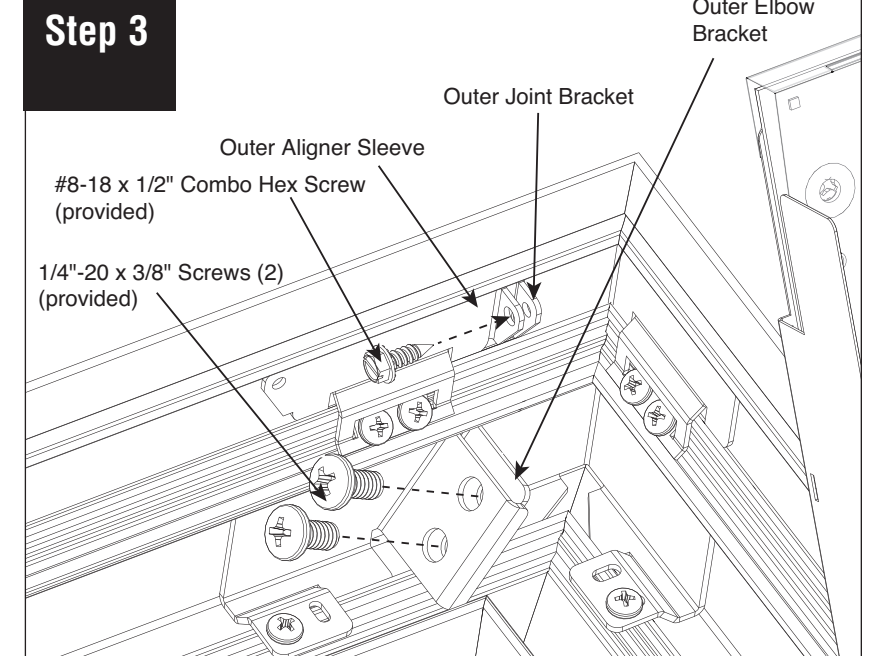

Fasten the outer elbow bracket and aligner sleeve using two 1/4"-20 screws. Then fasten the outer joint bracket and aligner sleeve using one #8-18 x 1/2" combo hex screw.

Step 4

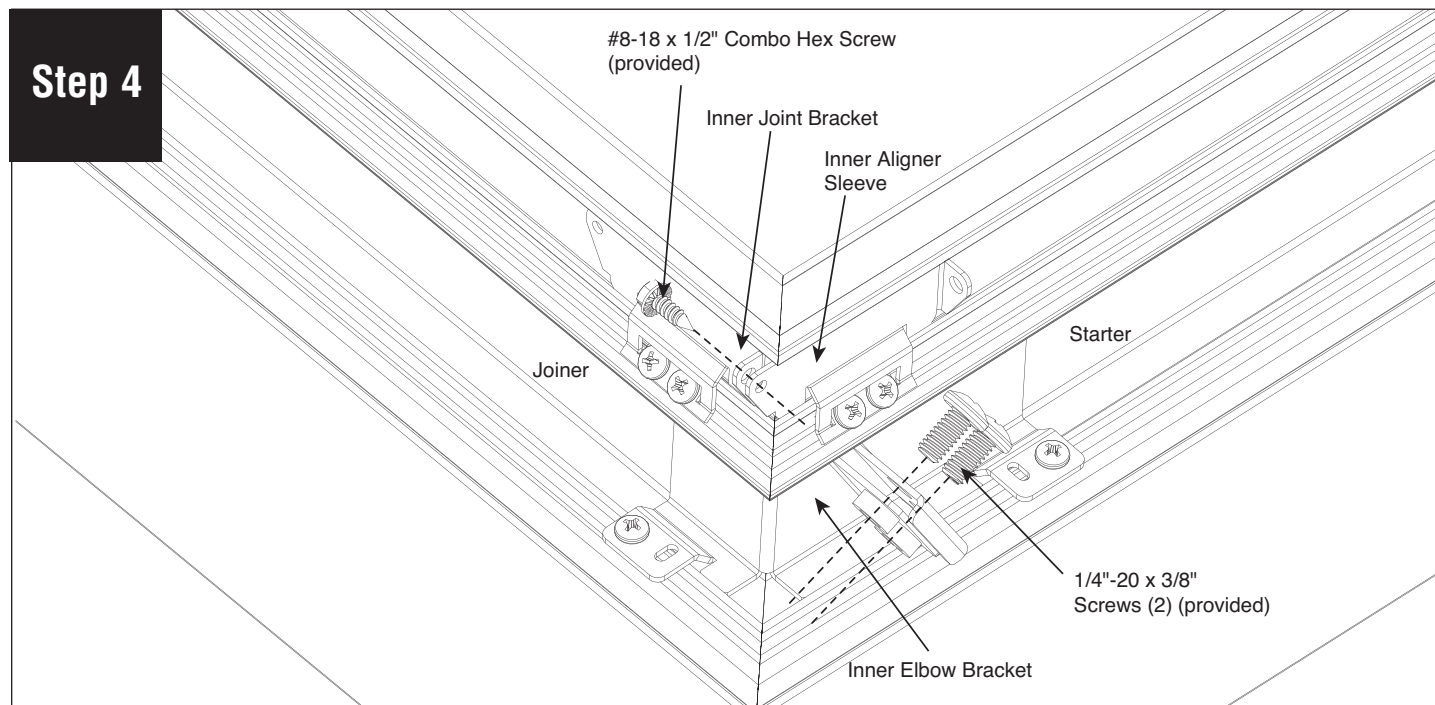

Fasten the inner elbow bracket and aligner sleeve using two 1/4"-20 screws (provided). Then fasten the inner joint bracket and aligner sleeve using one #8-18 x 1/2" combo hex screw (provided).

Step 5

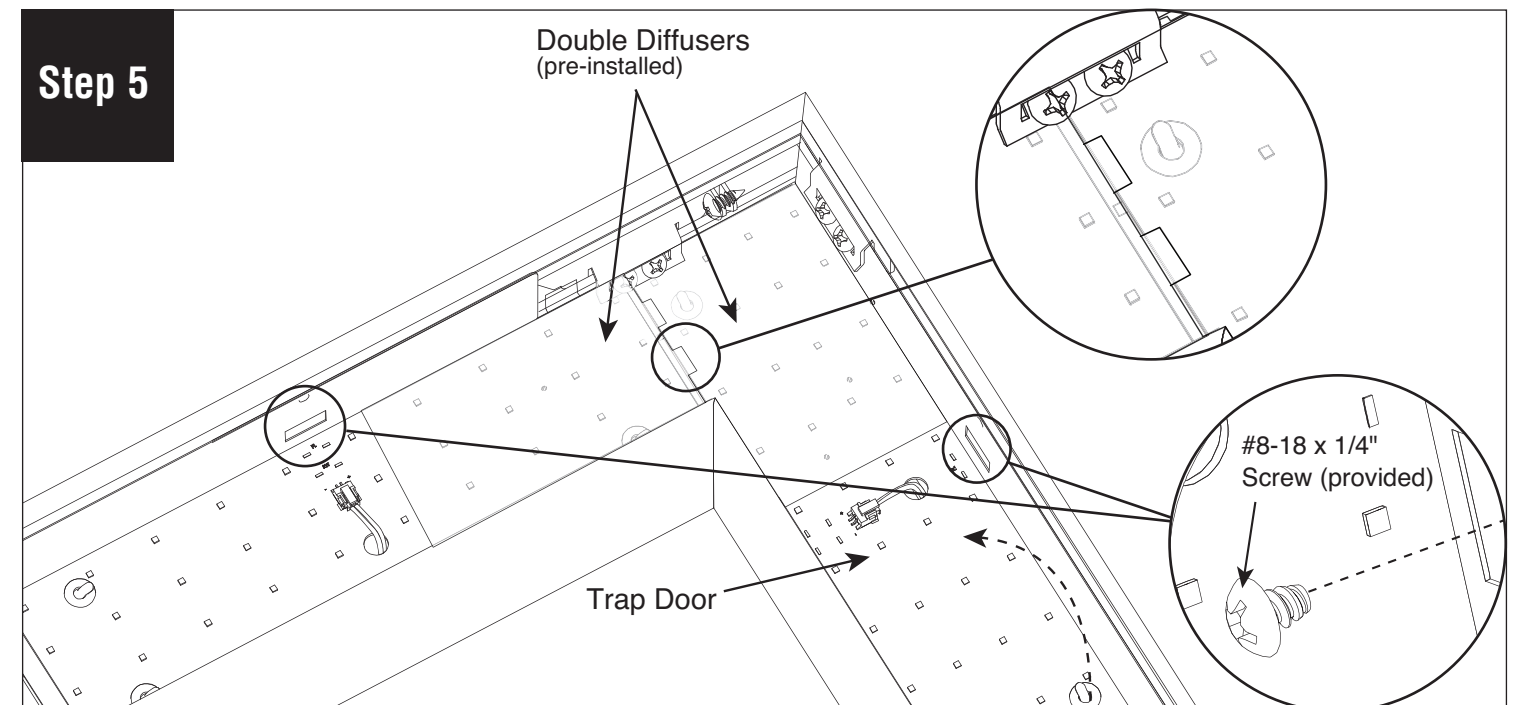

Replace trap doors and fasten with #8-18 x 1/4" screws (provided). Ensure right (long section) diffuser is under left (short section) diffuser tabs.

Note: All power connections to be installed to local/national codes by a Certified Electrician.