

# HP-4 Wall Wash Arm Mounted Mounting and Feed Guide

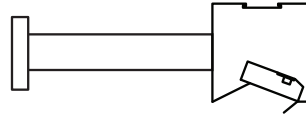

**FINELITE®**  
Better Lighting

Customer: \_\_\_\_\_ Job: \_\_\_\_\_ PO: \_\_\_\_\_

## MOUNTING HARDWARE

- Wall Rail Bracket**  
43320

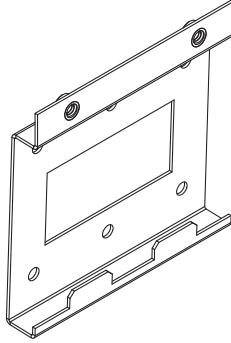

- Wall Bracket Cover**  
43322

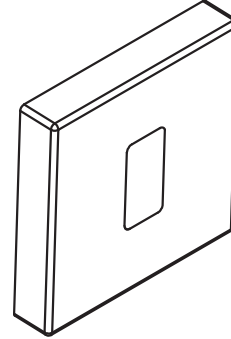

### Arm Assembly

- 12"** (43325)
- 15"** (43326)
- 18"** (43327)
- 24"** (43328)

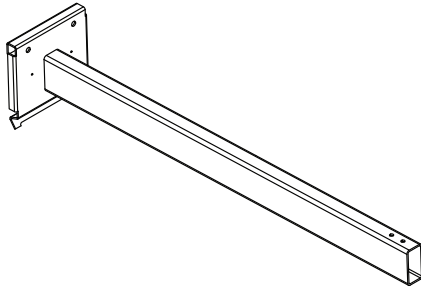

- Inner & Outer Housing Bracket**

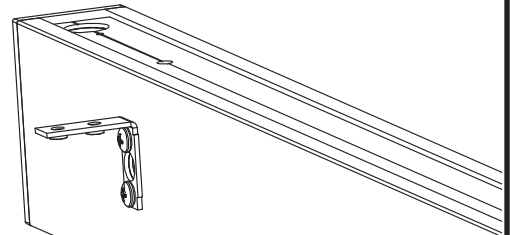

## Power Feed

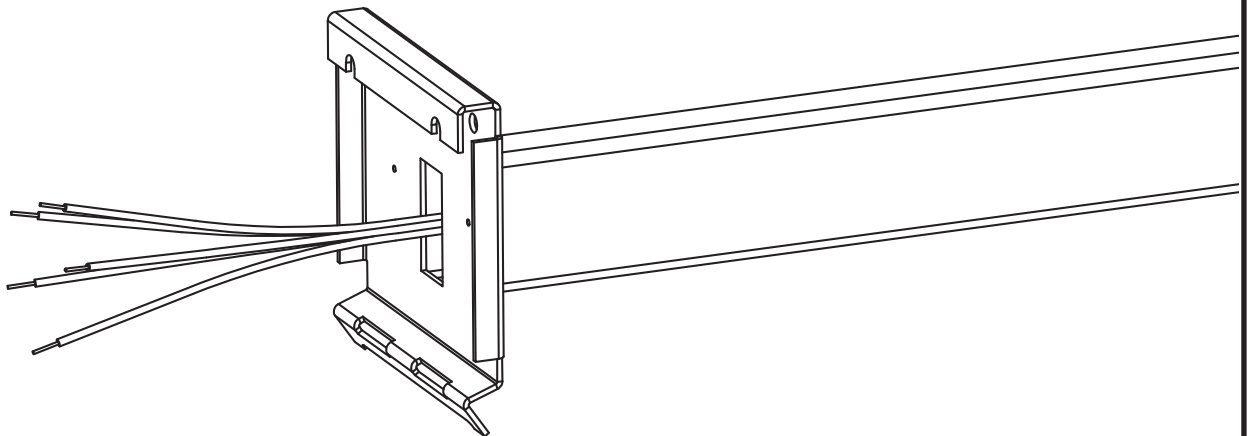

© 2018 FINELITE, INC. ALL RIGHTS RESERVED. CPG0094, 08/18

# HP-4 Wall Wash Arm Mounted Mounting and Feed Guide

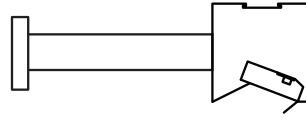

**FINELITE®**  
Better Lighting

## RUN LENGTHS & MOUNTING LOCATION EXAMPLES

Tailored Lengths Available Down To 1/16" (±1/32")

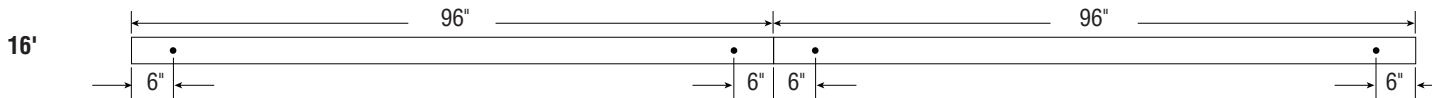
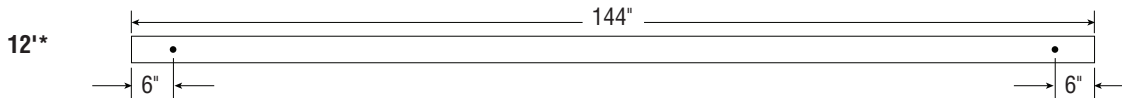
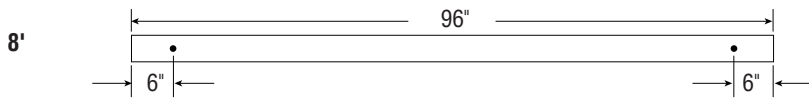
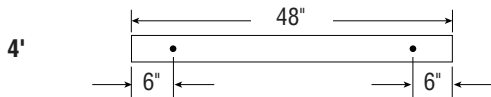
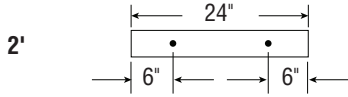

• = Bracket Location

\* = 12' Maximum spacing for two arm mount supports

### Endcaps Information

The **Flat Endcap** adds 1/4" per endcap to the section length.

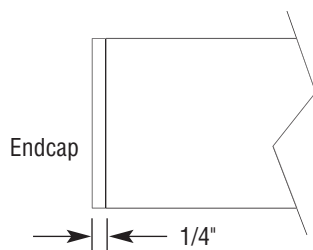

# HP-4 Wall Wash Arm Mounted Mounting and Feed Guide

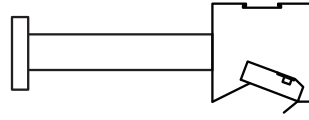

**FINELITE**<sup>®</sup>  
*Better Lighting*

## PROPER POSITIONING

