

FINELITE

High Performance 4" Aperture (HP-4) Wall Wash Recessed



Date

Project

Type

Comments

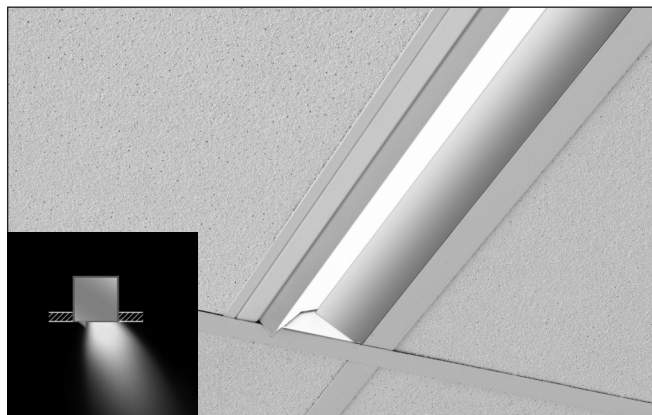

DESCRIPTION

High Performance 4" Aperture Wall Wash Recessed (HP-4 WW-R) is a patented, high performance, asymmetric distribution recessed luminaire for vertical illumination applications.

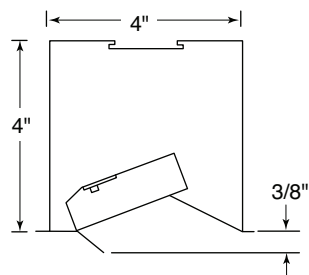

DIMENSIONS & LIGHT ENGINE

Asymmetric distribution is attained with mid-power LEDs distributed evenly and paired with a precise diffuser.

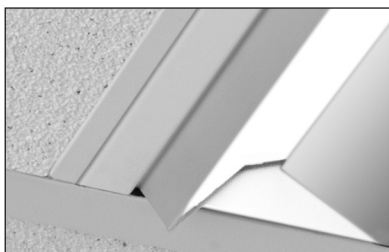

KICKER REFLECTOR

The standard kicker reflector delivers light high on the vertical surface and provides excellent glare control. The kicker reflector is easily removed for open distribution.

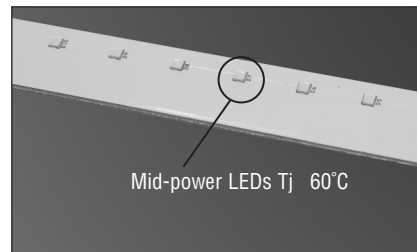

THERMAL MANAGEMENT

Mid-power LEDs allow heat to be fully dissipated without the need for additional heat sinks.

ORDERING GUIDE

Sample Number: HP-4 WW-R - K - 32' - S - 835 - 120V - SC - C1

Finelite **HP-4 WW-R**

Reflector (**K** - Kicker (standard), **FO** - Fully Open)

Length (Minimum **2'**, increments accurate to 1/16" (± 1/32"), standard)

Light Output (**S** - Standard, **B** - Boosted Standard, **H** - High, **V** - Very High)

LED CRI/CCT (**830** - 80 CRI min, 3000K, **835** - 80 CRI min, 3500K,

840 - 80 CRI min, 4000K, **930** - 90 CRI min, 3000K,

935 - 90 CRI min, 3500K, **940** - 90 CRI min, 4000K)

Voltage (**120V**, **277V**, **347V**)

Mounting (**C1** - 1" T-Bar, **C2** - 9/16" T-Bar, **C3** - screw slot, **C3F** - flush screw slot, **VF** - Visible Flange,

C2T - 9/16" tegular, **C1T** - 1" tegular, **SF** - Spackle Flange, **TZ6** (C1, C2, C2T, C3, C3F) - Tech Zone 6")

Circuiting (**SC** - Single Circuit)¹

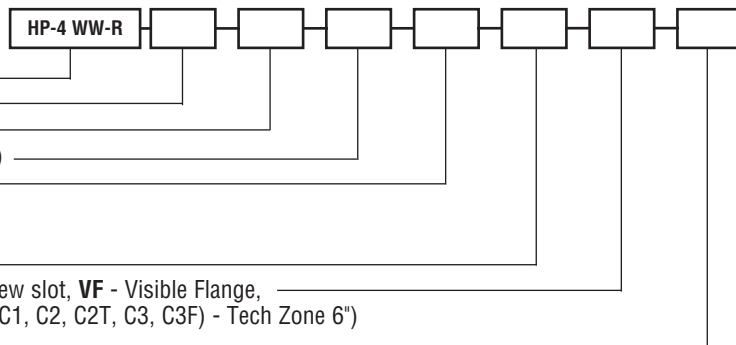

¹ Contact factory for switching options.

Protected by one or more US Patents: 8915613; D702,391; D702,390; D700,732

A brand of Legrand

Finelite, Inc. • 30500 Whipple Road • Union City, CA 94587-1530 • 510 / 441-1100 • Fax: 510 / 441-1510 • www.finelite.com

FINELITE

High Performance 4" Aperture (HP-4) Wall Wash Recessed

PHOTOMETRY

Very High Output - 4' Luminaire With Kicker
 Efficacy: 92 lumens per watt
 Total luminaire output: 1816 Lumens (454 lumens/foot)
 21.5 Watts (5.4 watts/foot)
 Peak Candela Value: 1072 @ 35°
 CCT: 3500K
 ITL LM79 Report 85130

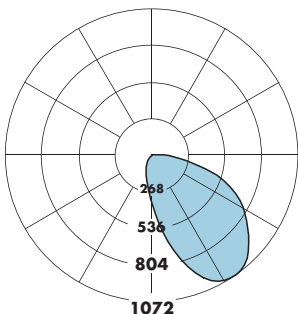

CANDELA DISTRIBUTION SUMMARY						
	0.0	22.5	45	67.5	90	Flux
0	373	373	373	373	373	
5	495	456	374	306	281	37
15	791	649	366	209	175	121
25	1018	818	347	147	115	217
35	1072	896	315	101	72	294
45	996	848	271	62	35	328
55	842	708	214	28	6	311
65	673	536	149	5	6	259
75	407	363	84	4	5	173
85	157	137	25	0	0	70
90	75	54	0	0	0	

Total Light Output, 3500K, 80 CRI (Lumens) - 4' Luminaire			
S*	B*	H*	V**
743	935	1412	1816

Light Output, 3500K, 80 CRI (Lumens Per Foot)			
S*	B*	H*	V**
186	234	353	454

Power (Watts Per Foot)			
S*	B*	H*	V**
2.0	2.5	3.8	5.0

Efficacy, 3500K, 80 CRI (Lumens Per Watt)			
S*	B*	H*	V**
91	92	92	92

S - Standard Output, B - Boosted Standard Output, H - High Output, V - Very High Output

* Family Correlation based on 4' luminaire 3500K 80 CRI Very High Output (V) test - 120V.

** Correlation based on ITL report: 85130

Lumen Adjustment Factors - 80 CRI	
3000K	0.985
3500K	1.000
4000K	1.032

Lumen Adjustment Factors - 90 CRI	
3000K	0.746
3500K	0.760
4000K	0.789

Apply a lumen adjustment factor to calculate lumens for the desired CCT and CRI.

SAMPLE LUMEN ADJUSTMENT CALCULATION

High Output (H), 4000K, 90 CRI

Lumen Adjustment Factor = 0.789

$$\text{Total Light Output} = 1412 \text{ lm} \times 0.789 = 1114 \text{ lm}$$

$$\text{Total Light Output per Foot} = 353 \text{ lm/ft} \times 0.789 = 279 \text{ lm/ft}$$

$$\text{watts/foot} = 3.8 \text{ W/ft}$$

$$\text{Efficacy} = \frac{279 \frac{\text{lm}}{\text{ft}}}{3.8 \frac{\text{W}}{\text{ft}}} = 73 \text{ lm/W}$$

FINELITE

High Performance 4" Aperture (HP-4) Wall Wash Recessed

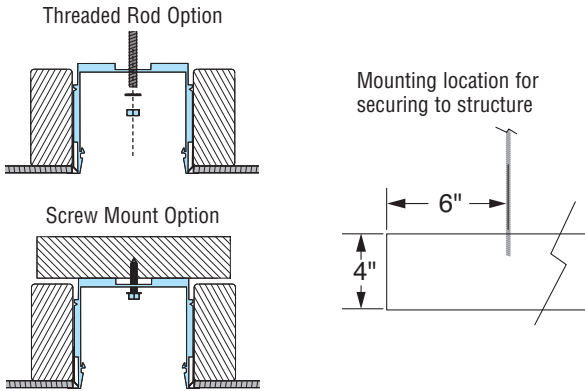

HARD CEILING MOUNTING OPTIONS

Two mounting options: threaded rod and screw mounting options. Mounting locations are located on each end of the luminaire. Mounting location is 6" away from each end of luminaire.

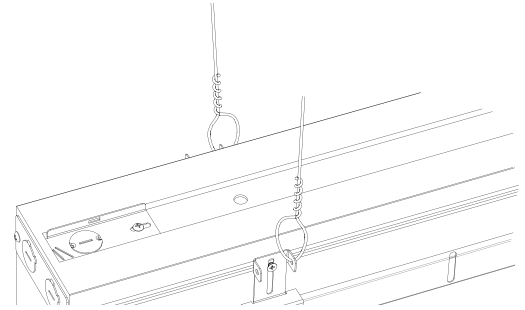

T-BAR INSTALLATION:

HP-4 R for T-Bar installations comes standard with a splice plate at the end of the luminaire. Mounting brackets (supplied) secure the luminaire to T-Bar and provide support to structure location. All even foot length (2, 4, 6, ...) luminaire runs are reduced in length by an appropriate amount to fit within typical 2x2 and 2x4 T-Bar grid systems. For uncommon T-Bar systems please consult factory.

GRID LENGTH DETAIL - 4' example

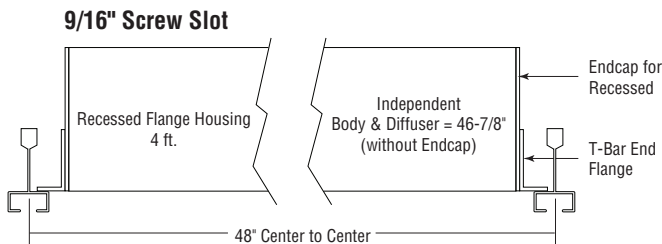
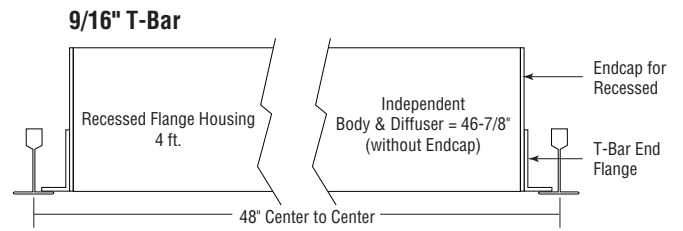
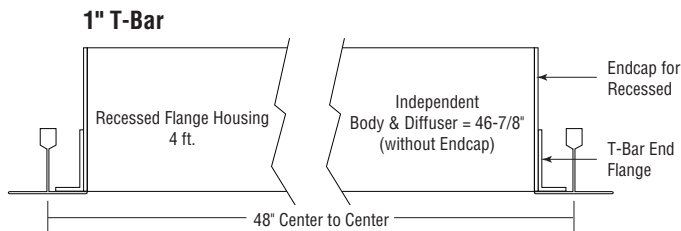

HARD CEILING LENGTH DETAIL - 4' example

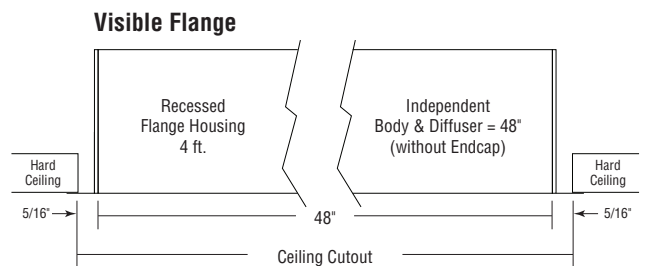
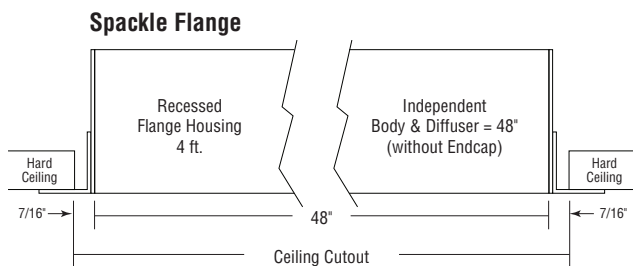

FINELITE

High Performance 4" Aperture (HP-4) Wall Wash Recessed

MOUNTING TYPES: T-BAR

Rough-In Dimensions with Kicker shown

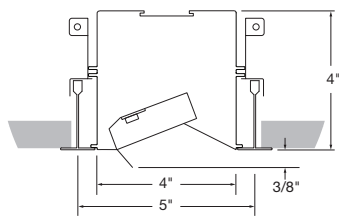

1" T-Bar (C1)

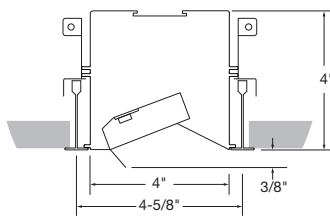

9/16" T-Bar (C2)

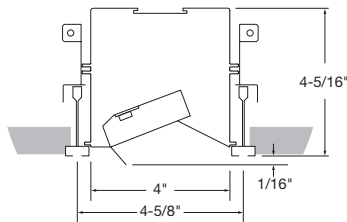

Standard Screw Slot (C3)

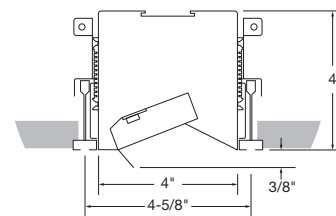

Flush Screw Slot (C3F)

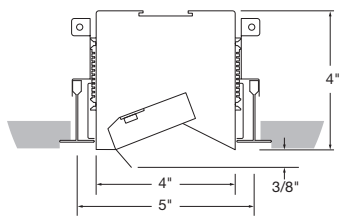

1" Tegular (C1T)

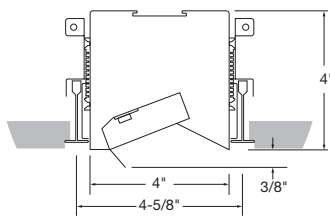

9/16" Tegular (C2T)

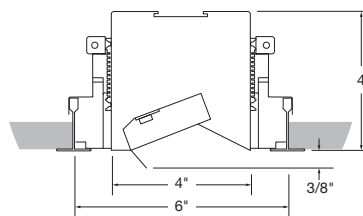

Tech Zone 6" (TZ6)
1" T-Bar (C1)

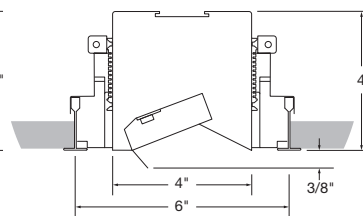

Tech Zone 6" (TZ6)
9/16" T-Bar (C2)

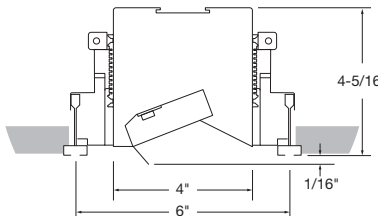

Tech Zone 6" (TZ6)
Standard Screw Slot (C3)

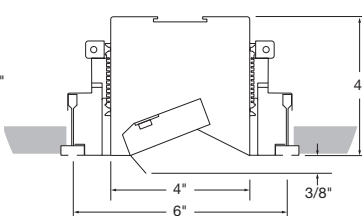

Tech Zone 6" (TZ6)
Flush Screw Slot (C3F)

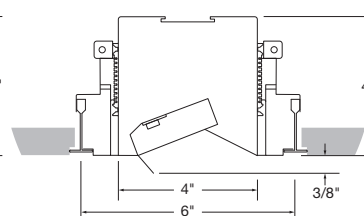

Tech Zone 6" (TZ6)
9/16" Tegular (C2T)

MOUNTING TYPES: CUTOUT DIMENSIONS

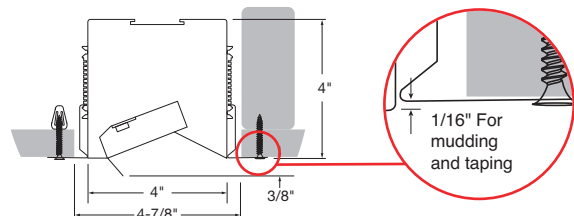

Spackle Flange (SF)

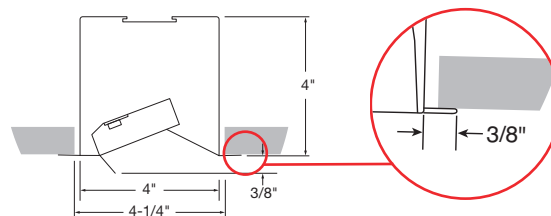

Visible Flange (VF)

HOUSING

Version 1



Ceiling Option
VF

Version 2

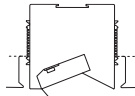

Ceiling Options
C1T, C2T, C3F, SF, TZ6

Version 3

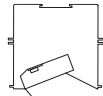

Ceiling Options
C1, C2, C3

* Note: +/- 1/16"

Protected by one or more US Patents: 8915613; D702,391; D702,390; D700,732

A brand of Legrand

Finelite, Inc. • 30500 Whipple Road • Union City, CA 94587-1530 • 510 / 441-1100 • Fax: 510 / 441-1510 • www.finelite.com

Due to continuing product improvements, Finelite reserves the right to change specifications without notice. Please visit www.finelite.com for most current data.

FINELITE

High Performance 4" Aperture (HP-4) Wall Wash Recessed

SPECIFICATIONS

CONSTRUCTION: Precision-cut 6061-T6 extruded aluminum body. Internal joiner system, plug-together wiring, standard. Housing is powder coated.

ENDCAPS: Flat endcaps at each end of run add 1/4" to overall length.

REFLECTORS: The standard semi-specular aluminum (SSA) kicker (K) reflector delivers light high on the vertical surface. The kicker reflector can be easily removed for open distribution (FO).

DIFFUSER: Luminaires are standard with frosted diffusers. All diffusers are UV-stabilized and impact resistant virgin acrylic. Frosted diffusers are 0.080" thick. 12' maximum diffuser length.

LIGHT OUTPUT: Four lumen packages available, Standard (S), Boosted Standard (B), High (H), and Very High (V). A separate chart summarizes lumen distribution and wattage. Light engines are replaceable.

LUMEN MAINTENANCE: 90% of initial light output (L90) at 100,000+ hours; 70% of initial light output (L70) at 200,000+ hours.

DRIVER: Replaceable 120V/277V and 347V Constant Current Reduction dimming driver standard. Can be wired dimming or non-dimming. 0-10V dimming controls with a range of 10%- 100%. Dimming to 1% available; consult factory. Driver is fully accessible

from below the ceiling. Power Factor: ≥ 0.9 . Total Harmonic Distortion (THD) $< 20\%$. Expected driver lifetime: 100,000 hours.

LUTRON DRIVER OPTIONS: Lut3W-3-wire, LutES-EcoSystem, Lut2W-2-wire.

ELECTRICAL: Optional emergency to generator/inverter wiring, internal generator transfer switch, nightlight wiring, step-dimming driver, backup battery. Chicago Plenum option. Factory-choice low-profile backup battery available. 8' minimum luminaire length for low profile battery pack. Bodine BSL722 battery pack also available; 4' minimum luminaire length. Backup battery delivers 1400 lumens. One 4' section will be illuminated in emergency mode.

MOUNTING: Standard bracket design works with most lay-in ceiling types. Brackets secure luminaire to the ceiling grid from above. Tie-in T-Bar brackets connect the luminaire to the T-Bar for securing to structure. Consult local codes for tie-wire recommendations.

FEED: Standard with one 18-gauge/5-conductor single-circuit feed. 14-gauge feed used when luminaire current exceeds 5 amps. Optional 6' flex conduit whips available.

LENGTHS: Any length, 2-foot minimum, in increments down to 1/16" ($\pm 1/32$ "). 12-foot maximum section length.

LABELS: Luminaire and electrical components are ETL-listed conforming to UL 1598 in the U.S.A. and CAN/CSA C22.2 No. 250.0 in Canada. In accordance with NEC Code 410.73 (G), this luminaire contains an internal driver disconnect. Damp Location. IC-Rated. Finelite products use electronic components that are RoHS compliant, and the mechanical components of the luminaire have been verified to not knowingly contain any restricted substances listed per RoHS Directive 2011/65/EU.

WEIGHT: 2.9 lb/ft.

WARRANTY: 10-year performance-based warranty on all standard components. Optional accessories such as emergency battery packs are covered by their individual manufacturer warranties.

FINELITE

High Performance 4" Aperture (HP-4) Wall Wash Recessed

Setback Info and Application Data

High Output with Kicker
 Total luminaire output: 1450 Lumens (363 lumens/foot)
 19.1 Watts (4.8 watts/foot)
 CCT: 3500K

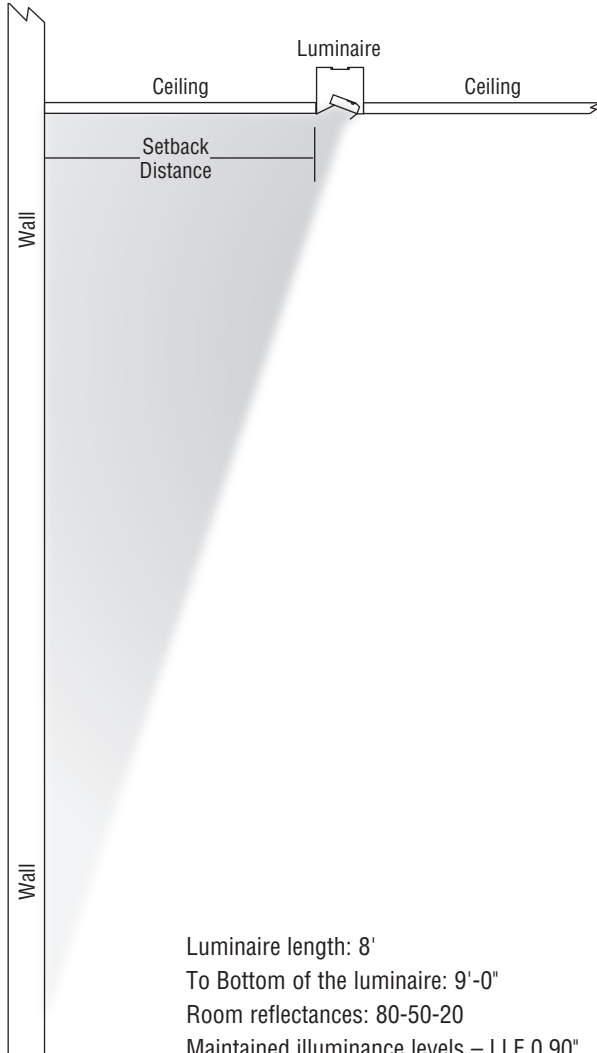

Setback Distance - 2'

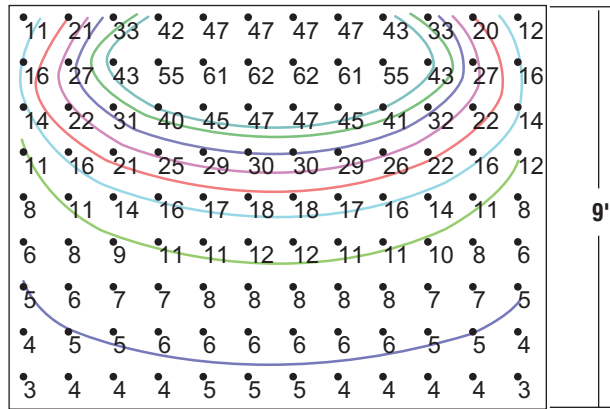

Setback Distance - 2.5'

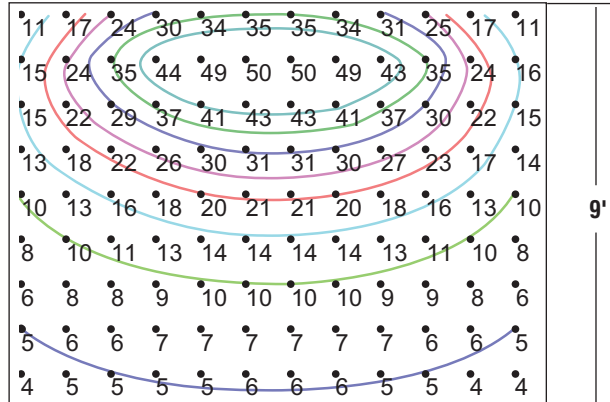

Luminaire length: 8'
 To Bottom of the luminaire: 9'-0"
 Room reflectances: 80-50-20
 Maintained illuminance levels – LLF 0.90"