

# FINELITE

## Series 11 LP Technical Sheet

Date

Project

Type

Comments

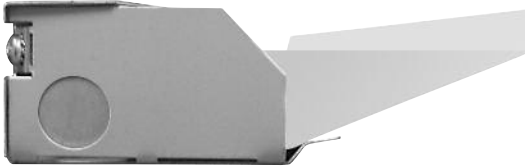

### DESCRIPTION

Finelite Series 11-LP (Low Profile) is a unique high performance fixture, perfect for cove ceilings where soft, even illumination is needed in a small fixture. Available with 1 or 2 T5, or T5HO lamps, Series 11-LP comes in 3', 4' and 8' lengths.

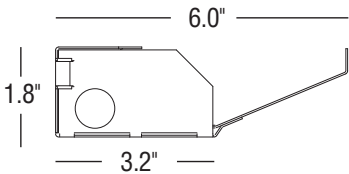

### DIMENSIONS:

Series 11-LP is designed to fit into an architectural cove with a minimum width of 6.25", and a minimum height of 2.0

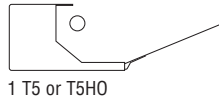

1 T5 or T5HO

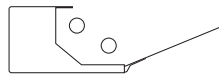

2 T5 or T5HO

### LAMPING:

Series 11-LP is available with 1 or 2 T5, or T5HO lamps. Standard 96W reflector system, or optional Extended Performance reflector.

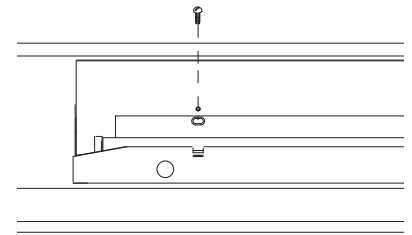

### MOUNTING:

Mounting without removing reflector makes installation fast and easy. Mounts directly to architectural cove with two screws per 4' section.

### ORDERING GUIDE

Sample Number: S11-LP - 32' - 2 T5HO - SC - 96W - 277 - .88



# FINELITE

## Series 11 LP Technical Sheet

### PHOTOMETRY



S11-LP: 1 T5HO-96W  
 Efficiency: 75.4%  
 Peak Candela Value: 1337@ 140°  
 LSI Report: 18917

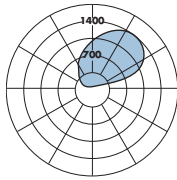

S11-LP: 1 T5HO-EP  
 Efficiency: 82.4%  
 Peak Candela Value: 1859@ 125°  
 LSI Report: 18050

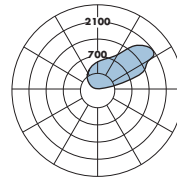

S11-LP: 2 T5HO-96W  
 Efficiency: 81.7%  
 Peak Candela Value: 2702@ 135°  
 LSI Report: 18919

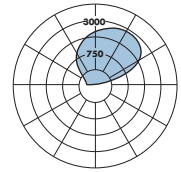

CANDLEPOWER SUMMARY						
	0.0	22.5	45.0	67.5	90.0	Flux
180	844	844	844	844	844	
175	846	874	905	906	918	44
165	819	911	1006	1050	1081	139
155	764	924	1091	1182	1223	242
145	684	916	1146	1259	1314	339
135	579	882	1161	1284	1325	413
125	453	837	1080	1234	1284	450
115	307	753	964	1122	1167	441
105	157	573	762	848	823	344
95	28	258	123	134	85	96
90	3	40	3	0	0	

CANDLEPOWER SUMMARY						
	0.0	22.5	45.0	67.5	90.0	Flux
180	758	758	758	758	758	
175	760	771	785	789	798	38
165	732	778	824	856	872	115
155	681	760	841	913	989	195
145	606	725	907	1161	1370	301
135	512	659	1143	1566	1745	433
125	400	636	1336	1706	1859	535
115	271	703	1303	1501	1519	543
105	139	645	920	942	915	400
95	29	309	229	250	181	133
90	5	51	13	2	0	

CANDLEPOWER SUMMARY						
	0.0	22.5	45.0	67.5	90.0	Flux
180	2188	2188	2188	2188	2188	
175	2193	2234	2261	2271	2277	110
165	2120	2245	2356	2430	2456	330
155	1977	2194	2388	2530	2578	542
145	1768	2097	2358	2584	2678	725
135	1496	1903	2311	2602	2702	860
125	1175	1691	2175	2493	2568	920
115	812	1477	1866	2073	2025	838
105	421	1104	1162	1263	1233	574
95	80	402	254	265	207	165
90	9	56	14	3	0	

— Refer to [www.finelite.com](http://www.finelite.com) for additional photometry and product information.

### SPECIFICATIONS

**CONSTRUCTION:** Body is 20-gauge steel. All components are hard- tooled to tolerances of 0.010".

**REFLECTORS:** Standard painted 20 gauge steel, 96% reflective white (96W). Optional: Extended performance (EP) reflector system.

**CORNER:** Optional corner harness, 0.5" flex conduit. Contact factory.

**ELECTRICAL:** 120 or 277V prewired. Fixture and electrical components are UL/C-UL listed and fixture will bear UL/C-UL labels. Optional Adders: 347V prewired, dual circuit, emergency circuits, emergency battery packs.

**LAMPING:** Series 11-LP is available in 1 or 2 lamp T5 or T5HO cross sections.

**BALLAST:** Electronic rapid-start-ballasts <10% THD standard. Optional Adders: 347 volt, emergency battery packs, dimming ballasts (controls by others). Specify T5 or T5HO.

**MOUNTING OPTIONS:** Fixture mounts directly to architectural cove. (low profile ballast required).

**FEED:** Standard 14 gauge wire feed extends from back of fixture.

**LENGTHS:** 3', 4', and 8' section lengths can be combined to make longer runs. Contact factory for additional lengths.

**WEIGHT:** Fixture weight = 2.5 lb/ft.