

S16 LED 3E Light Engine Replacement Installation Instructions

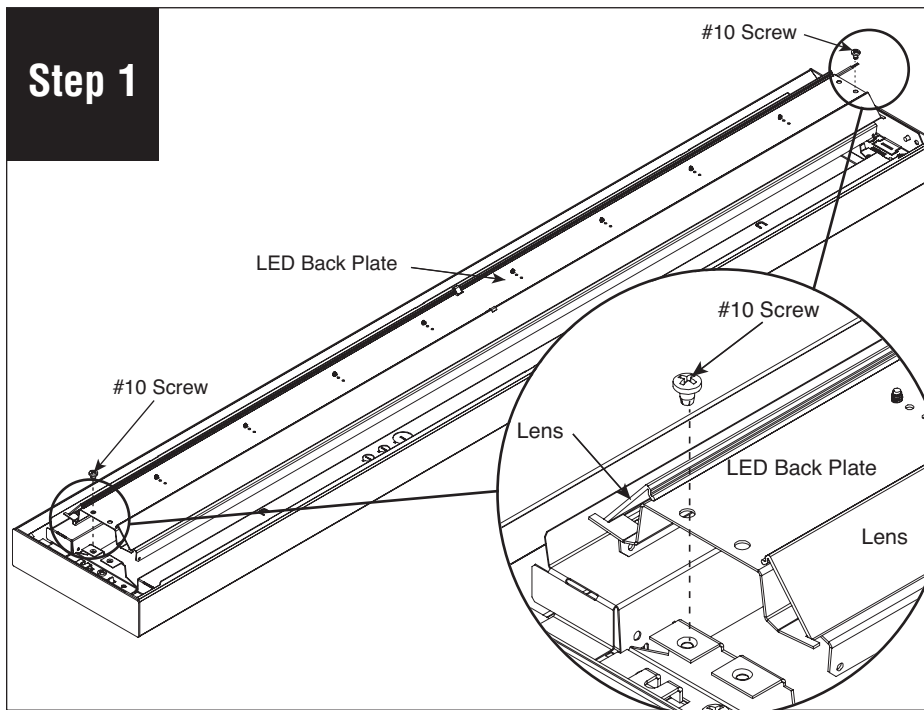

Remove #10 screws on both ends of LED back plate assembly. Carefully remove LED back plate assembly from fixture.

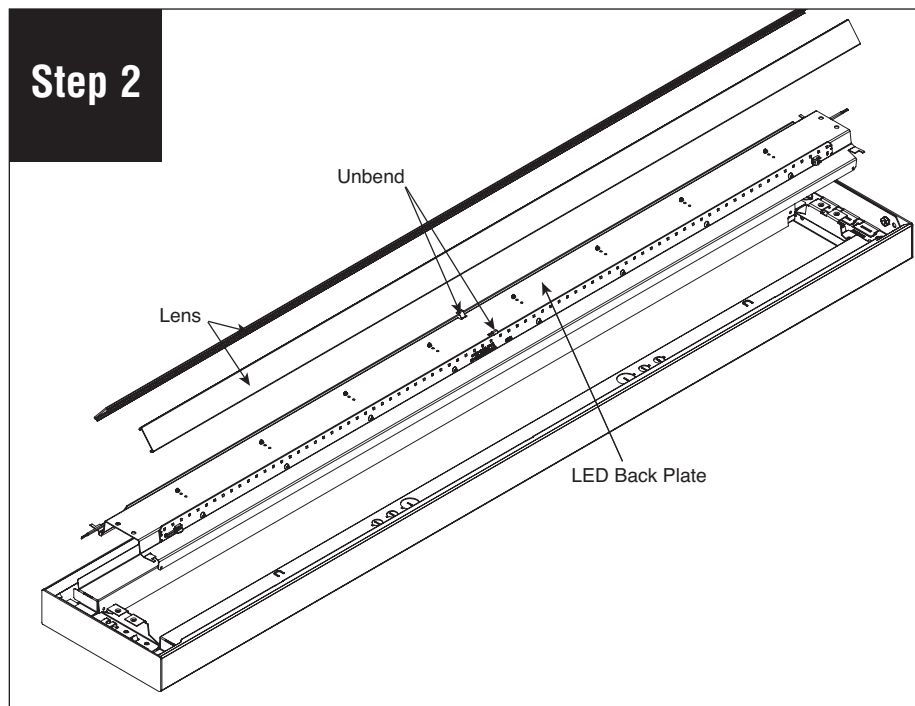

Remove lens from LED back plate by bending on 2 taps.

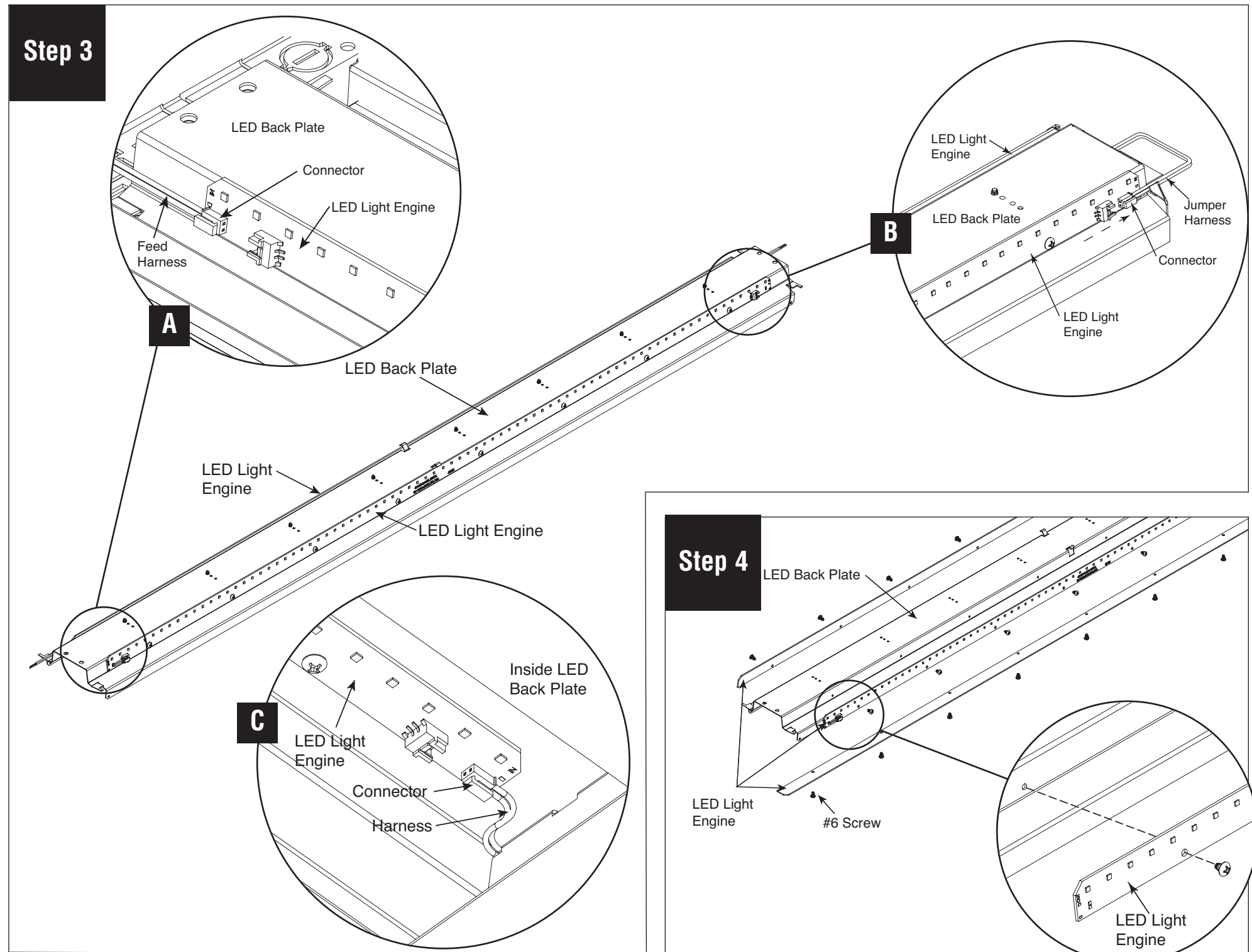

A. Unlock connector from LED light engine then remove feed harness.
B. Unlock connectors from both LED light engine then remove jumper harness.
C. Turn over the LED light engine carrier then unlock connectors from LED light engine and remove feed harness.

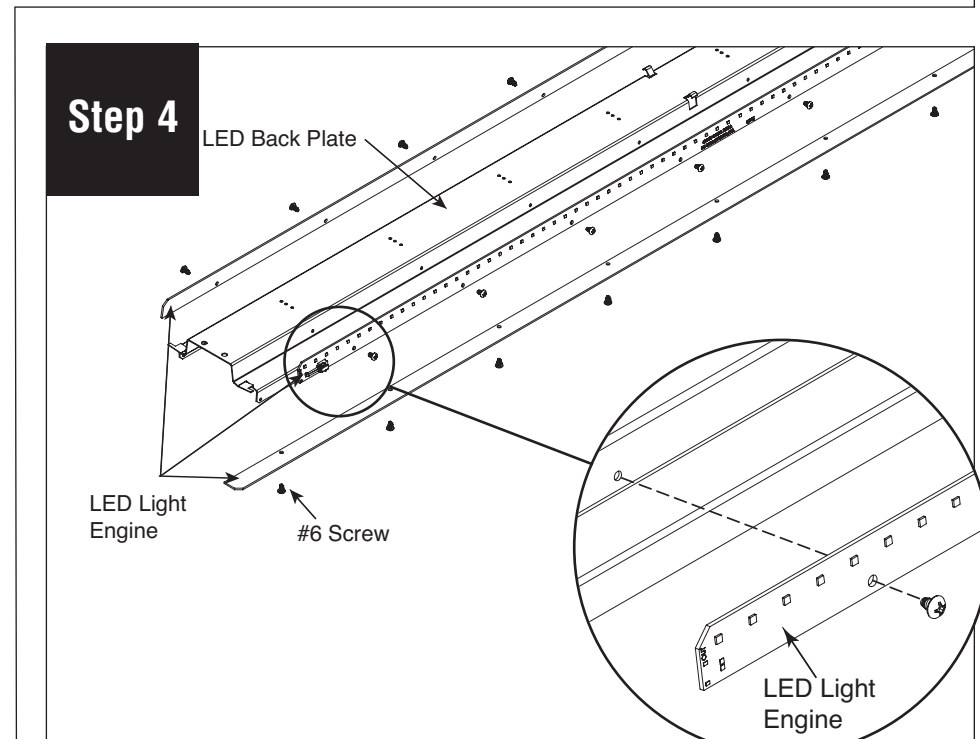

Remove each LED light engine by removing (8) #6 screws. Repeats for other side of the LED light engine. Reverse steps to install the new LED light engines.