



Series 12 LED

Project: Sport Ngin; Architect: Tanek; Location: Minneapolis, MN

Classic Shape • Affordable • Efficient
Indirect/Direct Luminaires



FINELITE
Better Lighting

Series 12 Collection

A classic shape is transformed by new LED performance levels.

Series 12 has three LED models – the affordable, high-efficacy 2-Engine, the flexible 3-Engine with separate uplight and downlight intensity controls, and a downlight optimized 4-Engine, as well as a fluorescent model.

The efficacious and affordable 2E is the perfect choice for energy and budget conscious projects. 3E and 4E deliver enhanced flexibility with independently controlled uplight and downlight.

This product is enrolled in the International Living Future Institute (ILFI) Declare 2.0 Program and is third-party verified with options achieving Red List Approved and Declared status.

Features

Tailored Output

Optimizing lighting levels to accommodate architectural design elements and code requirements.

- **Static White output options:**
Standard (S)
Boosted Standard (B)
High (H)
Very High (V)
- **Tunable White output options:**
Boosted Standard (B)
Very High (V)
- **Four distribution ratios:**
↑10% / 90%↓ (10U90D)
↑20% / 80%↓ (20U80D)
↑30% / 70%↓ (30U70D)
Total Direct Optic (TDO)

Features

Tailored Control

Dim and tune the lighting
to fit user preference

- Dimming from 100% to 10% standard; 1% available
- Industry-leading pre-qualified drivers and controls options available
- Integrated or networked daylight and occupancy sensors options available
- FineTune™ controls system: Simplified white light color tuning design and installation

Features

Tailored Color

Tune white light and intensity to the preferences of the people in the space.



- Static White light options: 3000K, 3500K, 4000K CCT
- Tunable White option for two-source tunable white light between 2700K and 6500K CCT
- 80+ and 90+ CRI options available

Series 12 Collection

2-Engine

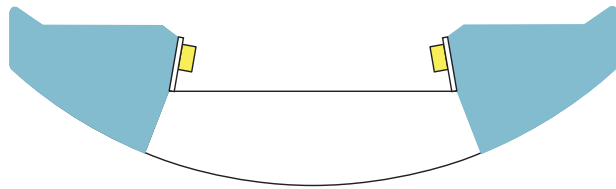

3-Engine

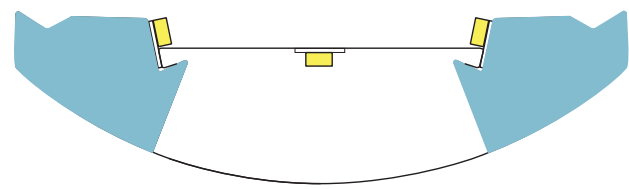

4-Engine

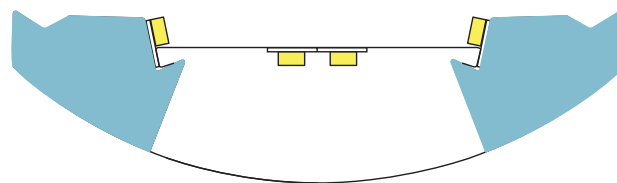

Series 12 Collection

Flat Endcap (standard)



Curved Endcap (optional)

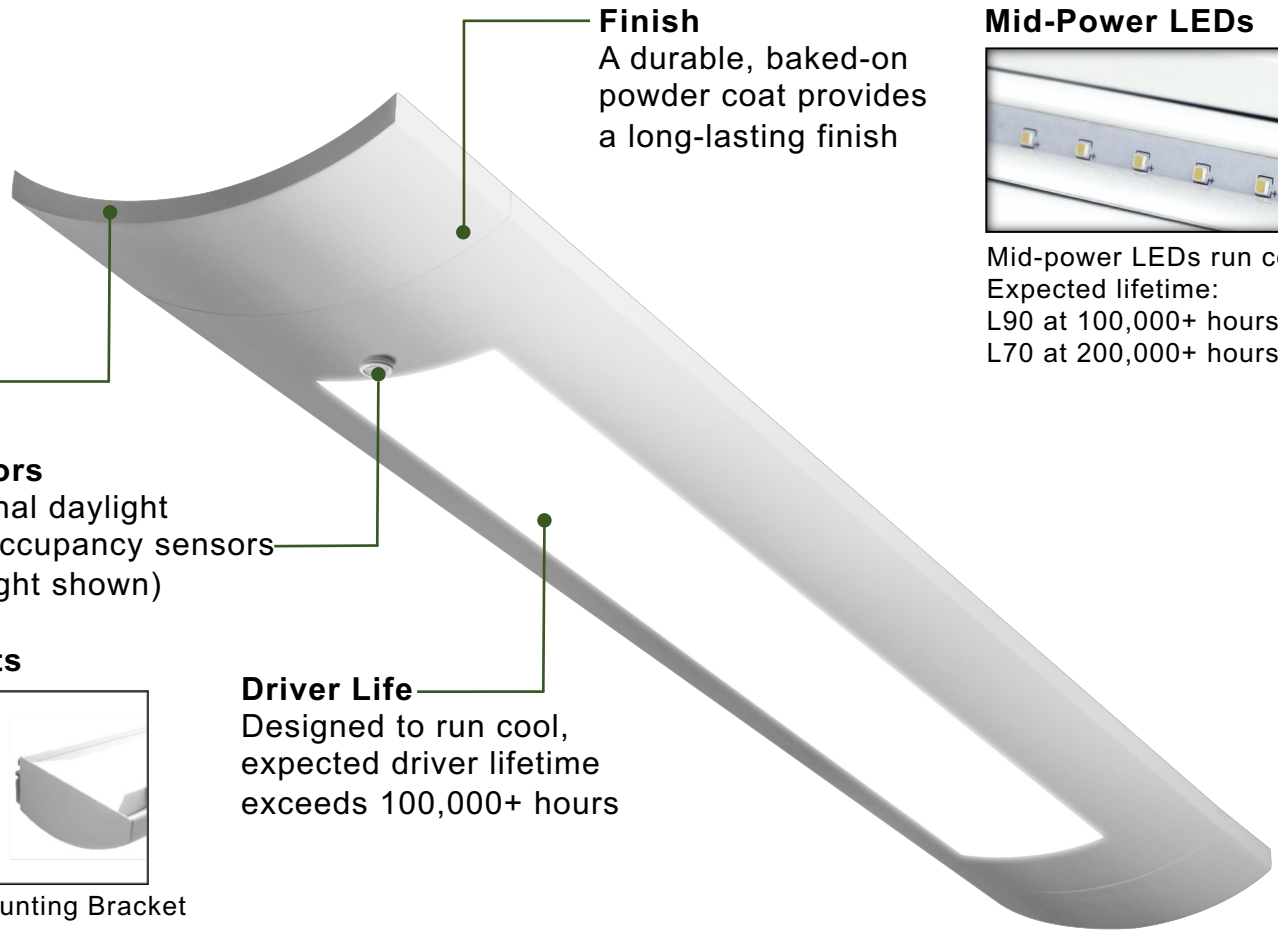

Finish

A durable, baked-on powder coat provides a long-lasting finish

Mid-Power LEDs



Mid-power LEDs run cool.
Expected lifetime:
L90 at 100,000+ hours
L70 at 200,000+ hours

Sensors

Optional daylight
And occupancy sensors
(daylight shown)

Driver Life

Designed to run cool,
expected driver lifetime
exceeds 100,000+ hours

Complementary Wall Mounts

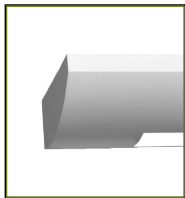

Surface Mount

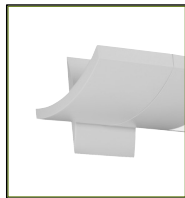

Standoff Mount

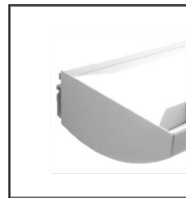

Mounting Bracket

Series 12 LED 2E

Performance, Efficacy, and Affordability

The Series 12 LED 2-Engine (2E) has the highest efficacy of the collection is available with multiple optic and distribution ratios. Use the 2E configuration when superior optical performance is required for budget conscious projects.

2-Engine - Classroom

	H 3500K
	14' O.C.
Light Level General Mode (fc)	42.6
Average to Minimum	1.70:1
Energy Consumption (LPD) – General Mode	0.417 W/ft ²
Room Size	30' x 32'

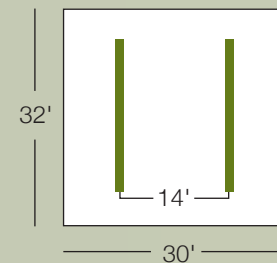

Initial light levels represent typical average desktop surface.
Ceiling Height: 10'0" / Mounting Height: 8'0" AFF / Room Reflectances: 80/50/20

Series 12 LED 2E - Performance

2E Photometry – 4' Luminaire

Distribution: 74% Up / 26% Down
3500K Very High Output

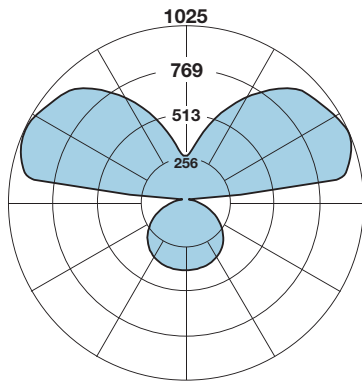

Distribution Ratios
3500K Very High Output

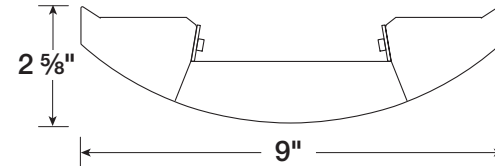
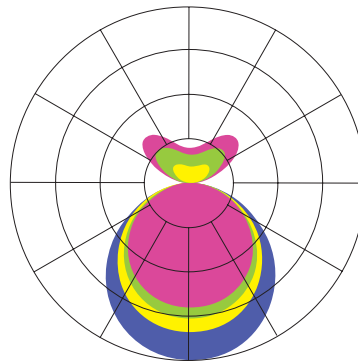

2E OPEN Lumen Output Per Foot (3500K)			
	Total Lumens per foot	Wattage per foot	Efficacy Total (lm/W)
S*	490	3.7	134
B*	615	4.6	133
H*	930	7.2	130
V**	1196	9.3	128

* Family Correlation based on 4' Luminaire 3500K Very High Output (V) test – 120V

** Correlation based on ITL LM79 Report: 85161

OPEN Up to 1196 lm/ft

10U90D Up to 791 lm/ft

20U80D Up to 833 lm/ft

30U70D Up to 864 lm/ft

TDO Up to 797 lm/ft

Notes:

Please refer to technical sheet for more information.

For Tunable White data please see Tunable White technical sheet.

2E Distribution Ratios, 3500K, 80+ CRI*		
	Total Lumens	Efficacy (lm/W)
10U90D	1295 – 3163 (↑0% / 100%↓)	85 - 89
20U80D	1364 – 3331 (↑0% / 100%↓)	90 - 94
30U70D	1415 – 3457 (↑0% / 100%↓)	93 - 97
TDO	1305 – 3187 (↑0% / 100%↓)	86 - 90

* Family Correlation based on 4' Luminaire 3500K Very High Output (V) test – 120V

** Correlation based on ITL LM79 Report: 87814, 87815, 87816, 87818

Series 12 LED 3E

Separate Controls for Uplight and Downlight

The Series 12 LED 3-Engine (3E) is an architectural indirect/direct linear LED luminaire with single or dual circuit controls for the uplight and downlight.

Users can manage intensity levels and switch between indirect and direct illumination to suit the task at hand.

3-Engine – Private Office

	H – S 3500K
Light Level (fc)	38.0
Average to Minimum	1.46:1
Energy Consumption (LPD)	0.608 W/ft ²
Room Size	10' x 12'

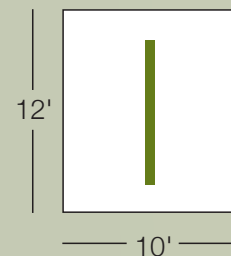

Initial light levels at work plane.

Ceiling Height: 9'0" / Mounting Height: 7'6" AFF / Room Reflectances: 80/50/20

Series 12 LED 3E - Performance

3E Photometry – 4' Luminaire

3500K Very High Output

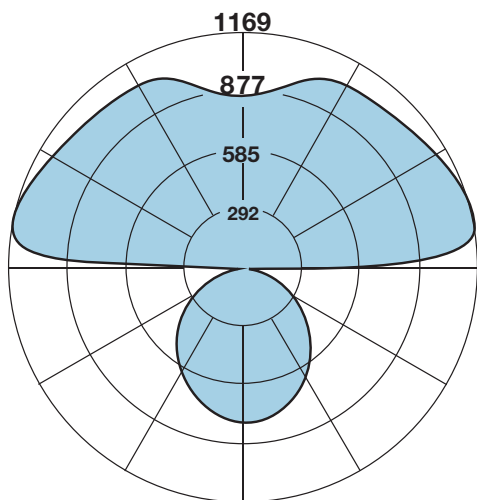

Notes:
 Individually select uplight and downlight outputs in any combination.
 Please refer to technical sheet for more information.
 For Tunable White data please see Tunable White technical sheet.

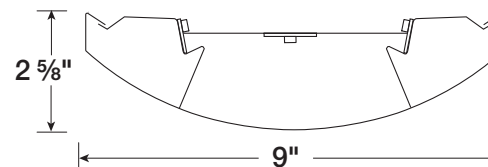

S12-LED-ID-DCO-4FT-3E-V-V-8-35-OPEN

Distribution: 71% Up / 29% Down

Efficacy: 124 lumens per watt

Total Luminaire Output: 7069 lumens (1767 lm/ft)

57.0 watts (14.3 w/ft)

CCT: 3500K

ITL LM79 Report 85163

3E OPEN Lumen Output Per Foot (3500K)				
	↑S* / S*↓	↑B* / B*↓	↑H* / H*↓	↑V* / V*↓
Uplight (lm/ft)	516	648	981	1261
Downlight (lm/ft)	207	261	394	506
Total Lumens	2894	3638	5498	7069
Wattage per foot	5.7	7.2	10.9	14.3
Efficacy Total (lm/W)	127	127	126	124

* Family Correlation based on 4' Luminaire 3500K Very High Output (V) test – 120V

** Correlation based on ITL report: 85163

Series 12 LED 4E

The Most Controls and Distribution Options

The Series 12 LED 4-Engine (4E) is an architectural indirect/direct linear LED luminaire with five distribution options. The 4-Engine is designed to maximize the downlight output with independent uplight and downlight intensity controls.

Series 12 LED 4E - Performance

4E Photometry – 4' Luminaire

Distribution Ratios 3500K High Output

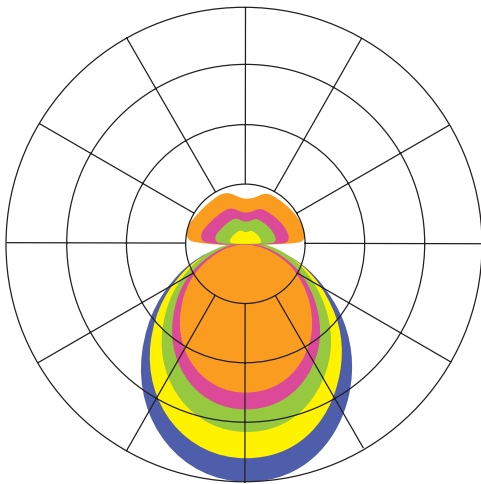

- 10U90D** Up to 1250 lm/ft
- 20U80D** Up to 1250 lm/ft
- 30U70D** Up to 1250 lm/ft
- 40U60D** Up to 1250 lm/ft
- TDO** Up to 1250 lm/ft

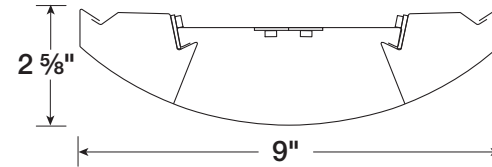

4E Distribution Ratios, 3500K, 80+ CRI*		
	Total Lumens	Efficacy (lm/W)
10U90D	3000 – 5000 (↑10% / 90%↓)	107 - 108
20U80D	3000 – 5000 (↑20% / 90%↓)	109 - 110
30U70D	3000 – 5000 (↑30% / 90%↓)	111 - 113
40U60D	3000 – 5000 (↑40% / 90%↓)	113 - 116
TDO	3000 – 5000 (↑0% / 100%↓)	105 - 108

*Family Correlation based on 4' luminaire 3500K Very High Output (V) test – 120V
Correlation based on ITL LM79 Report 85163

Notes:
Please refer to technical sheet for more information.
For Tunable White data please see Tunable White technical sheet.

Series 12 Collection



Project: Sport Ngin; Architect: Tanek; Location: Minneapolis, MN

The Finelite LED Difference



10-year performance-based warranty



90% of initial light output at 100,000+ hours

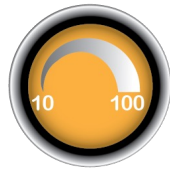

Dimming Standard

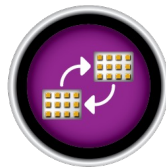

Replaceable LED light arrays

The Finelite Commitment to You



10-working-day shipping on standard orders



Focus on sustainability