

**FINELITE**<sup>®</sup>  
*Better Lighting*

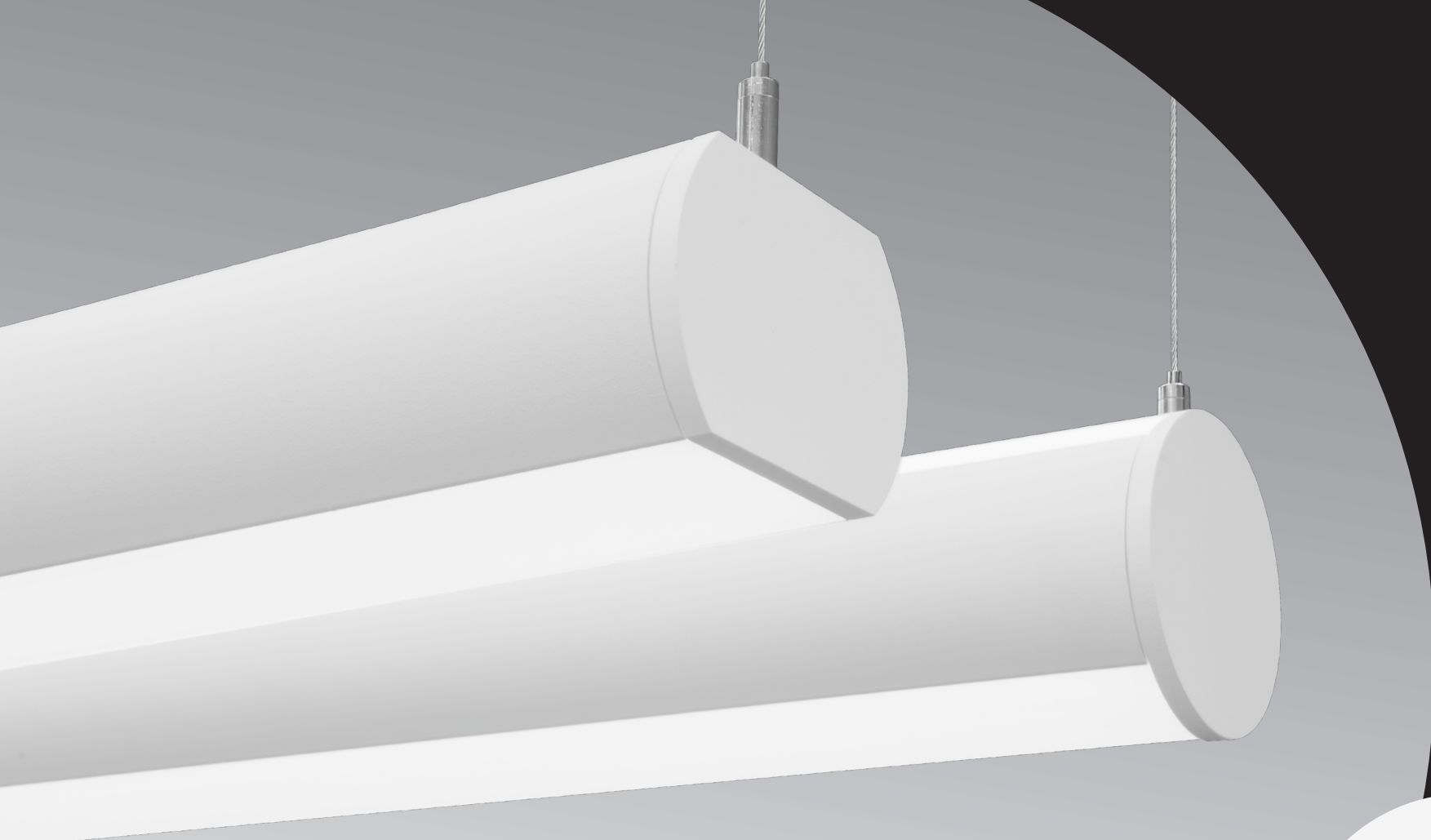

# HPO With Tailored Lighting™

High Performance 3.5" Round  
LED COLLECTION



A brand of **legrand**<sup>®</sup>

## High Performance 3.5" Round

The HPO LED pendant luminaire with indirect/direct illumination is an advanced solution that delivers unprecedented performance from a micro round 3.5" diameter form factor. Featuring a 2.5" aperture, HPO provides glare free illumination from a flush or round lens. Engineered with contractors in mind, HPO is equipped with an integral driver design for reduced installation time and cost. The small form and high performance of HPO unlocks the potential for new design options.

# Features



## Tailored Output

Optimize light levels to accommodate code requirements and architectural design elements.

## Tailored Control

Enhanced application control with integrated sensors, dimming, and tunable white offerings.

## Tailored Length

Ultimate design flexibility with perfectly sized luminaires to your exact needs.

## Tailored Angle

Integrate Knuckle to connect luminaires to create unique angles and configurations.

## Tailored Color

Tune white light options for the needs and desires of people and space.

## Performance

Delivering up to 127 lumens per watt using our mid-powered LED strategy to provide an L90 to 100K+ hrs and L70 to 200+K hrs.

## On-Grid™ Mounting

On-Grid mounting for luminaires in standard lengths makes installation quick and easy.

## Declare 2.0

This product is enrolled in the International Living Future Institute (ILFI) Declare 2.0 Program and is third-party verified.

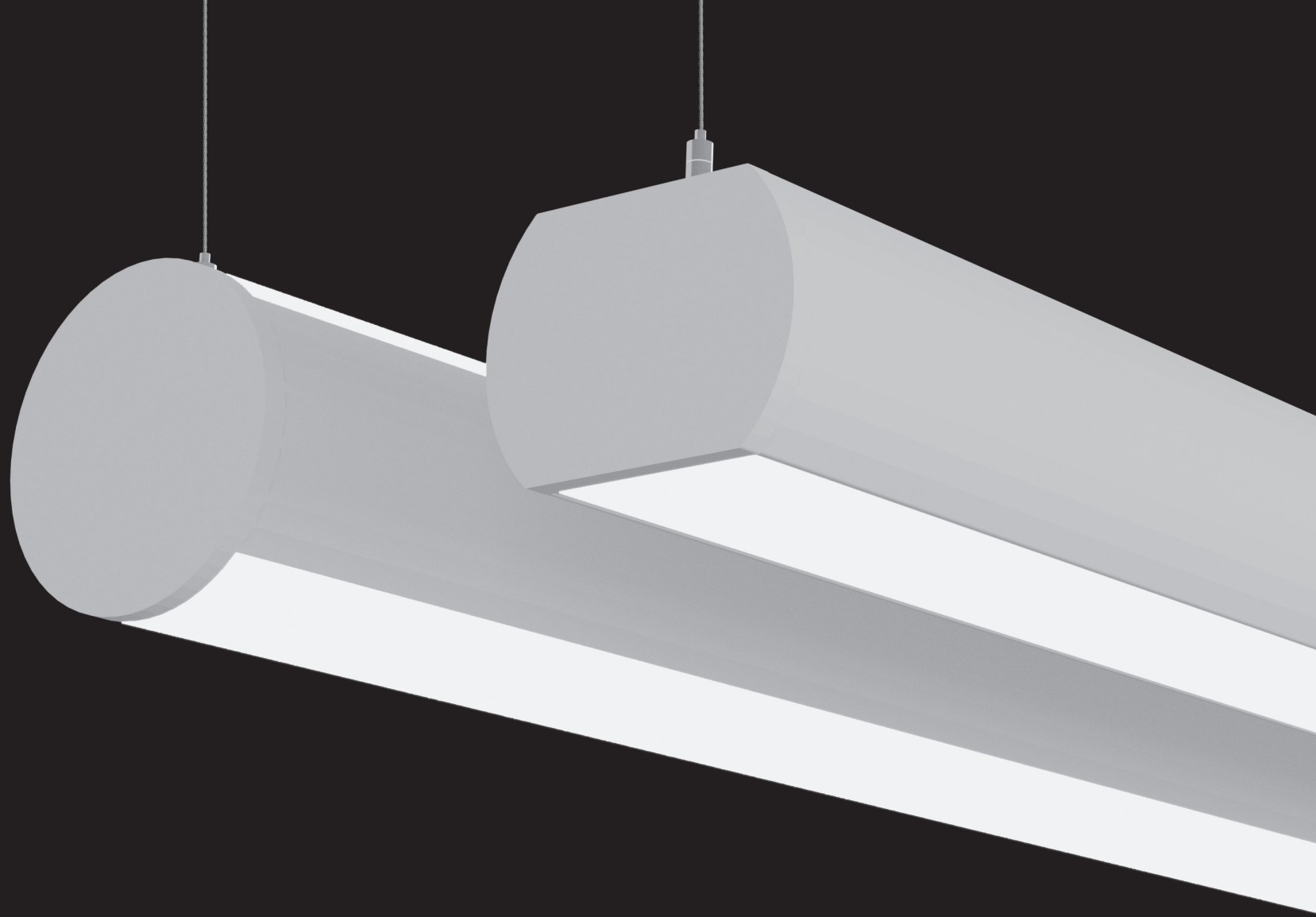

**High Performance:** total light output of

**8516**

lumens per 4' section



**High Efficacy:** up to

**127**

lumens per watt

# HPO



Round Top, Round Bottom, and Round Endcap shown

# HPO Round & Flush

This line of light luminaire delivers excellent performance and is equipped with a unique LED configuration for superior illumination. Output can be enhanced with advanced optical options.

## Aesthetic Options

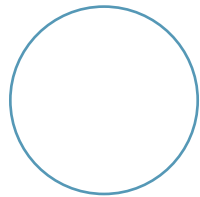

### Round

Round Top and Bottom Diffusers



### Flush

Flush Top or Top Glow and Bottom Diffusers

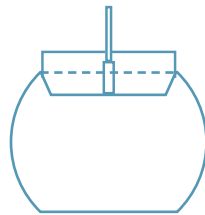

----- Endcap coverage

### Tailored Output

- Static White output options: Standard (**S**), Boosted Standard (**B**), High (**H**), and Very High (**V**)
- Tailored Lighting offers customized output: lms/ft
- 0-10V Tunable White output options: Standard (**S**), Boosted Standard (**B**), High (**H**), and Very High (**V**)
- FineTune DMX output options: Boosted Standard (**B**) and Very High (**V**)

### Tailored Length

- Lengths customizable from 2' to 12' in 1' increments
- Ships in 10 working days
- Available in Static White or Tunable White

### Tailored Color

- Static White light options at 3000K, 3500K and 4000K CCT
- Tunable White option for two-source Tunable White light between 2700K and 6500K CCT
- 80+ and 90+ CRI options available

### Tailored Control

- Dimming from 100% to 10%, standard; 1% available
- Industry-leading pre-qualified drivers and controls tailored to meet project needs
- Integrated or networked daylight and occupancy sensors options available
- Simplified dimming and Tunable White design and installation with FineTune™ Tailored Control System

# HPO 2.5" Aperture with Knuckle

Knuckle for Pendant Mounted HPO expands the micro form factor Collection with the ability to connect luminaires to create unique angles and configurations.

**Top View**

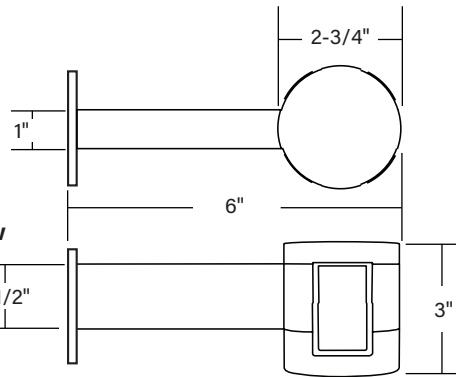

**1XP Shown**

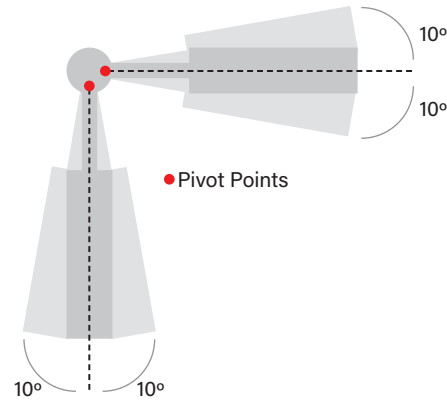

**On-site Adjustability**  
10° Left and 10° Right

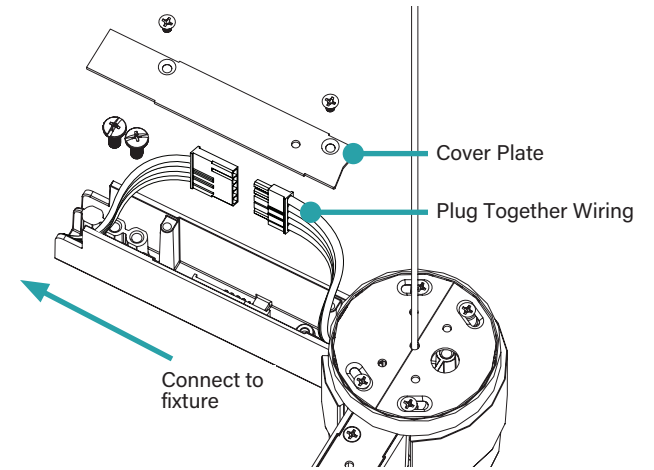

**Ease of Installation**  
Quick installation steps

## Knuckles\*

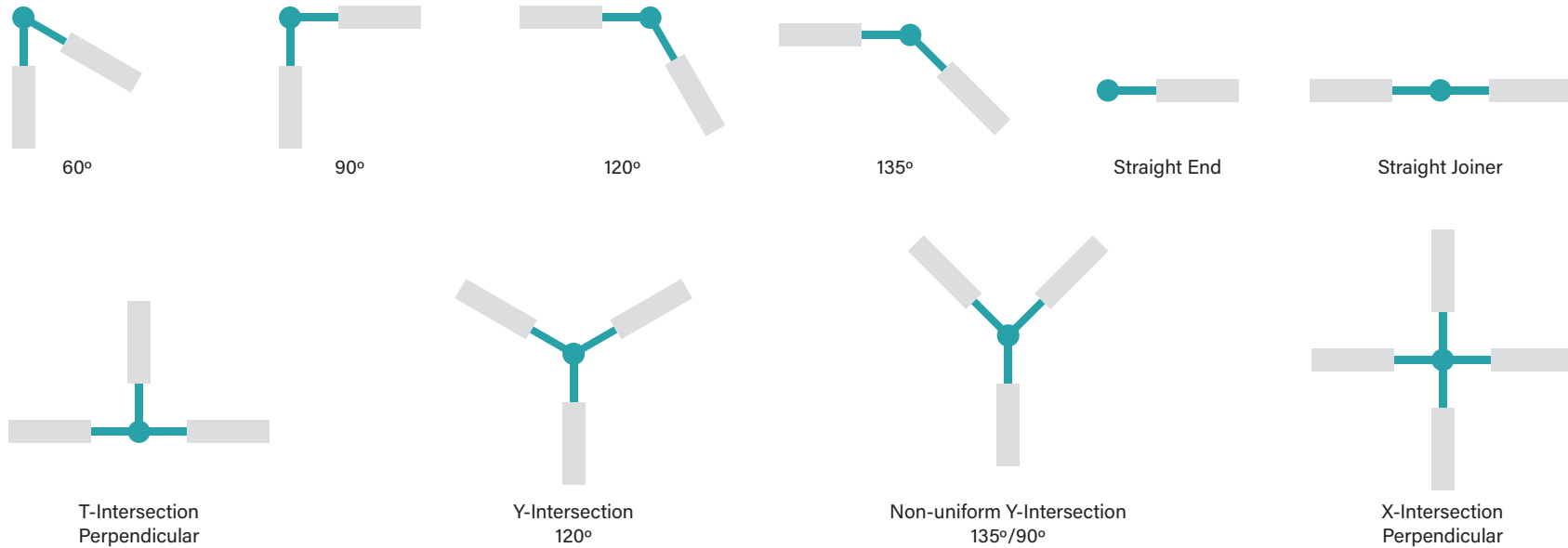

\* Each arm field adjustable 10° in either direction for 20° total range of motion



## Standard 10-Day Configurations

Available in a variety of angles and shapes including squares, rectangles, t-intersections, triangles, hexagons, octagons, and more.

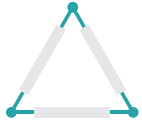

Triangle

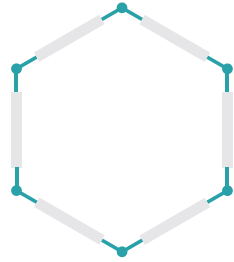

Hexagon

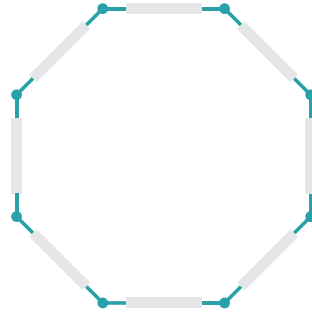

Octagon

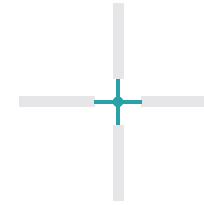

Plus

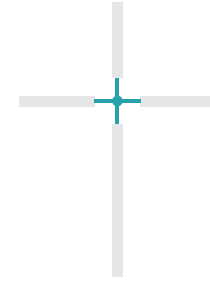

Cross

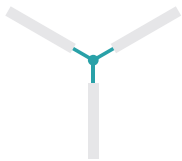

Y-Intersect 120



Y-Intersect 135/90

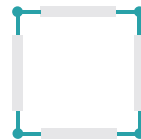

Square

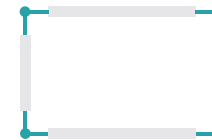

Rectangle



Straight End

## Unleash your Creativity

Create complex configurations with unique angles. Give us your sketch and our expert engineers will create drawings and make sure it is easy to install. Lead time may vary.

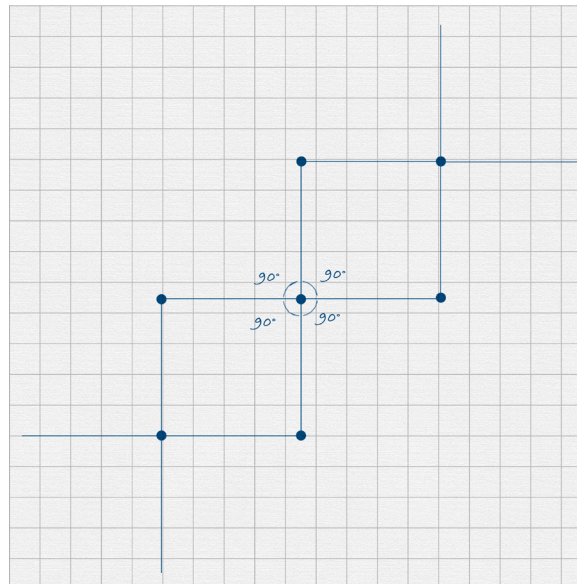
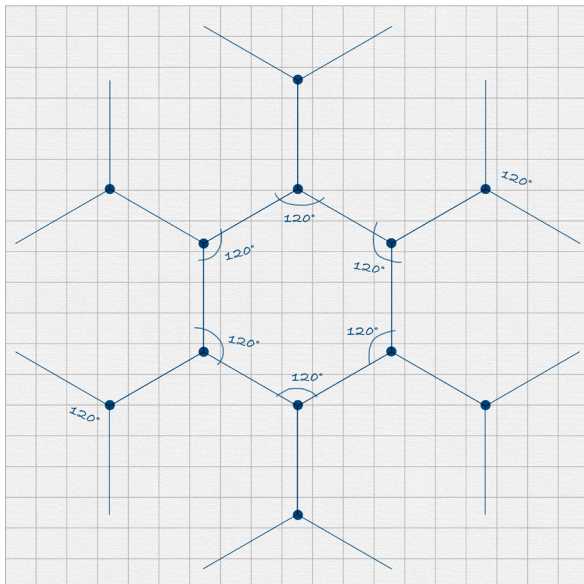

# Performance

## HPO Indirect/Direct Pendant

### Round Top and Bottom Diffusers (Shown)

HPO-P-ID-V-V-835-RT-RB

Very High Output / Very High Output - 4' Luminaire

Distribution: 51% Up (V) / 49% Down (V)

Efficacy: 123 lumens per watt

Uplight: 4331 lumens (1079 lumens/foot)

Downlight: 4159 lumens (1040 lumens/foot)

Total Luminaire Output: 8490 lumens (2123 lumens/foot)

69.0 watts (17.3 watts/foot)

CRI: 80

CCT: 3500K

ITL LM79 Report 93792

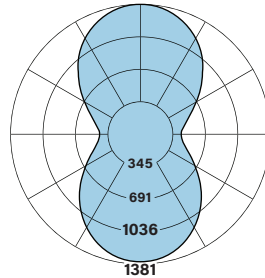
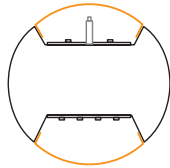

		↑ Indirect	↓ Direct
<b>Light Output, 3500K, 80 CRI (Lumens Per Foot)</b>			
	↑S <sup>1</sup>	↑B <sup>1</sup>	↑H <sup>1</sup>
↓S <sup>1</sup>	869	983	1268
↓B <sup>1</sup>	978	1092	1377
↓H <sup>1</sup>	1252	1366	1651
↓V <sup>1</sup>	1483	1597	1882

	↑S <sup>1</sup>	↑B <sup>1</sup>	↑H <sup>1</sup>	↑V <sup>2</sup>
<b>Efficacy, 3500K, 80 CRI (Lumens Per Watt)</b>				
↓S <sup>1</sup>	129	128	127	126
↓B <sup>1</sup>	128	127	126	125
↓H <sup>1</sup>	125	125	125	124
↓V <sup>1</sup>	124	124	124	123

S - Standard Output, B - Boosted Standard Output, H - High Output, V - Very High Output

<sup>1</sup> Family Correlation based on 4' luminaire 3500K Very High Output (V) test - 120V

<sup>2</sup> Based on ITL report: 93792

#### Note

- Please refer to technical sheet for total light output and wattage.

## HPO Indirect/Direct Pendant

### Widespread Optic with Flush Diffuser (Shown)

HPO-P-ID-V-V-835-WSO-F

Very High Output / Very High Output - 4' Luminaire

Distribution: 51% Up (V) / 49% Down (V)

Efficacy: 119 lumens per watt

Uplight: 4223 lumens (1055 lumens/foot)

Downlight: 4005 lumens (1001 lumens/foot)

Total Luminaire Output: 8228 lumens (2057 lumens/foot)

69.0 watts (17.3 watts/foot)

CRI: 80

CCT: 3500K

ITL LM79 Report 92549

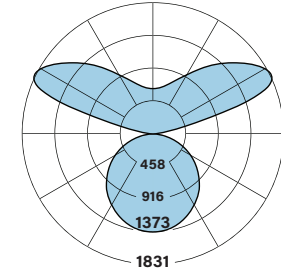
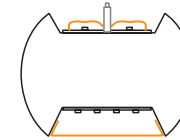

		↑ Indirect	↓ Direct
<b>Light Output, 3500K, 80 CRI (Lumens Per Foot)</b>			
	↑S <sup>1</sup>	↑B <sup>1</sup>	↑H <sup>1</sup>
↓S <sup>1</sup>	842	953	1231
↓B <sup>1</sup>	947	1059	1336
↓H <sup>1</sup>	1211	1322	1600
↓V <sup>1</sup>	1433	1545	1822

	↑S <sup>1</sup>	↑B <sup>1</sup>	↑H <sup>1</sup>	↑V <sup>2</sup>
<b>Efficacy, 3500K, 80 CRI (Lumens Per Watt)</b>				
↓S <sup>1</sup>	125	124	123	122
↓B <sup>1</sup>	124	123	123	122
↓H <sup>1</sup>	121	121	121	120
↓V <sup>1</sup>	119	120	120	119

S - Standard Output, B - Boosted Standard Output, H - High Output, V - Very High Output

<sup>1</sup> Family Correlation based on 4' luminaire 3500K Very High Output (V) test - 120V

<sup>2</sup> Based on ITL report: 92549

#### Note

- Please refer to technical sheet for total light output and wattage.

# Cross Sections

## HPO Indirect/Direct Pendant

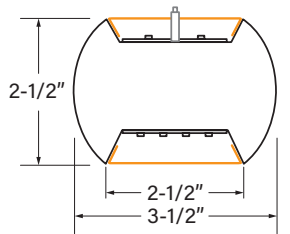

Flush Diffuser, Flush Diffuser

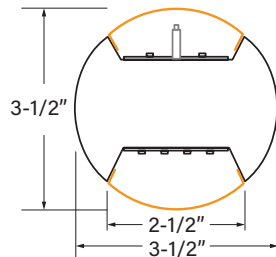

Round Top Diffuser,  
Round Bottom Diffuser

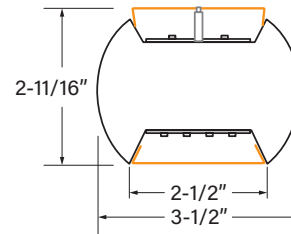

Top Glow Diffuser,  
Flush Diffuser

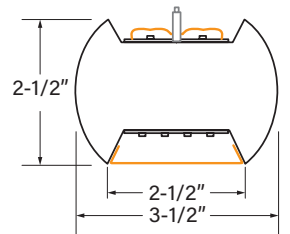

Widespread Optic, Flush Diffuser

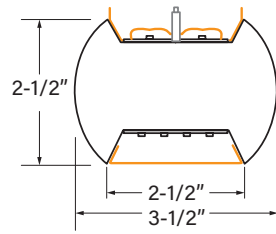

Widespread Optic with  
Top Glow, Flush Diffuser

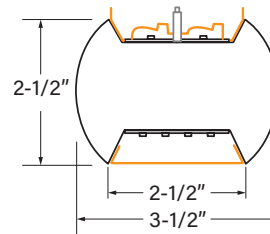

Asymmetric Left or Right with  
Top Glow, Flush Diffuser

## HPO Direct Pendant

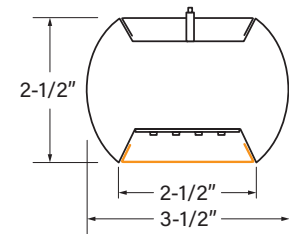

Flush Diffuser

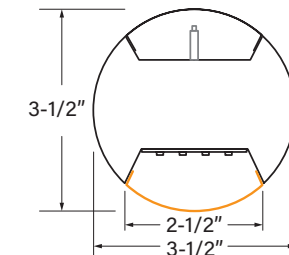

Round Bottom Diffuser

# FINELITE<sup>®</sup>

---

## *Better Lighting*

### The Finelite LED Difference



10-year performance-based warranty



90% of initial light output at 100,000+ hours



Dimming standard



Replaceable LED light arrays

### Finelite Commitment To You



Ships in 10 working days for standard orders



Focus on sustainability