

# HP-WS Perimeter Slot Post-Ceiling T-Bar Installation Instructions

## Overview

### NOTES

- All power connections should be installed according to local/national codes by a Certified Electrician.
- This installation requires **proper support** as each luminaire is being installed.
- **DO NOT attempt to join luminaires together on the floor.** Damage may result when lifted.



HELPFUL  
VIDEOS



0-10V  
Dimming



Simple  
Plug-Together  
Wiring

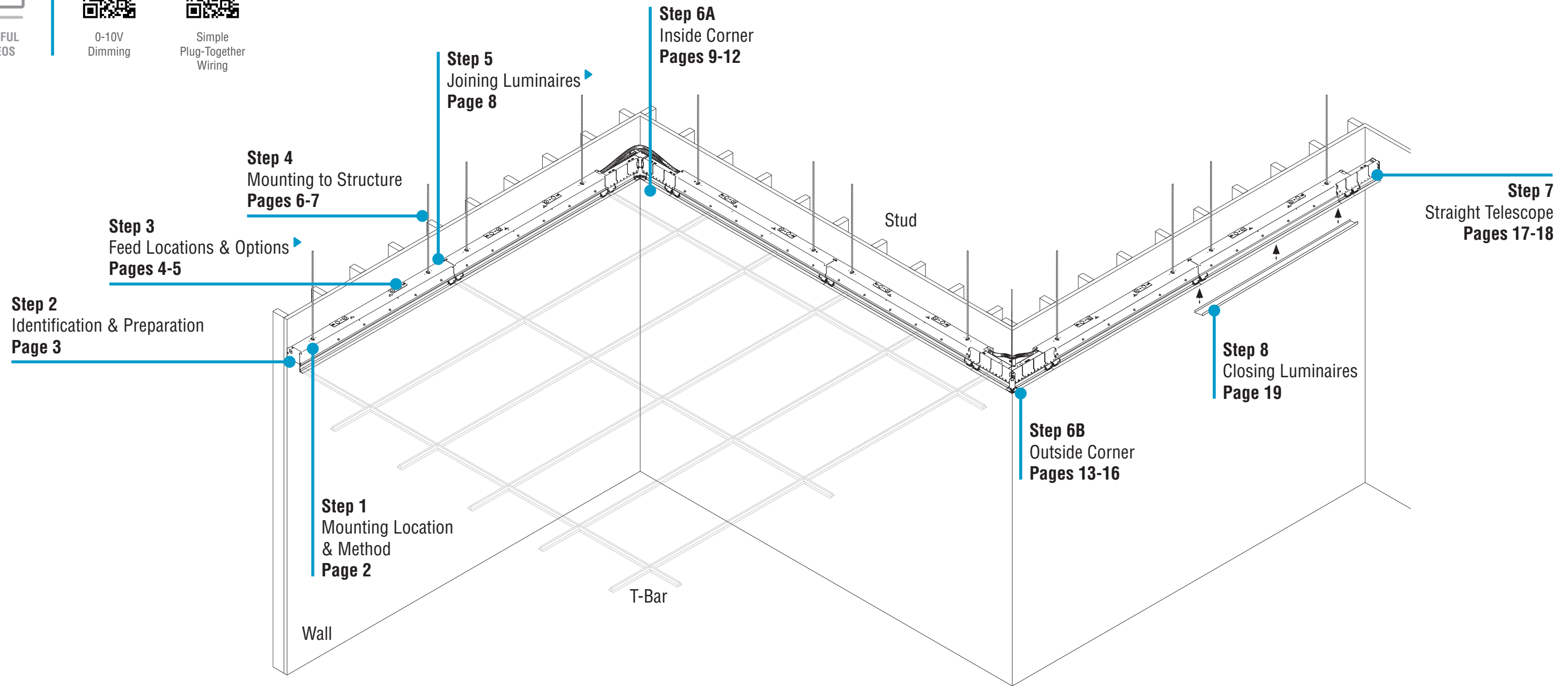

# HP-WS Perimeter Slot Post-Ceiling T-Bar Installation Instructions

## Step 1 - Mounting Location & Method

### A. Create Rough In Side View

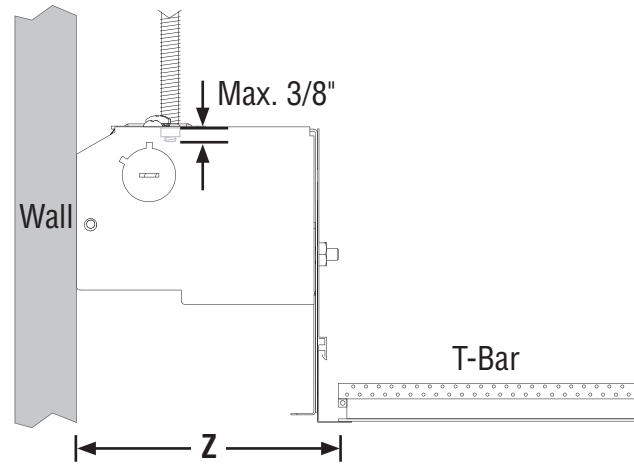

Luminaire Depth	Rough In Opening	
	4" Width	6" Width
2", 4" & 6"	Z = 4-1/2"	Z = 6-1/2"

### Endcap Information (Side Views):

The **Wall-to-Wall Endcap** adds 1/8" per endcap.

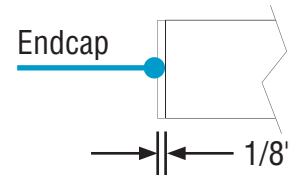

The **Pocket Slot Endcap** adds 1-1/4" for Spackle Flange and 1" for T-Bar per endcap.

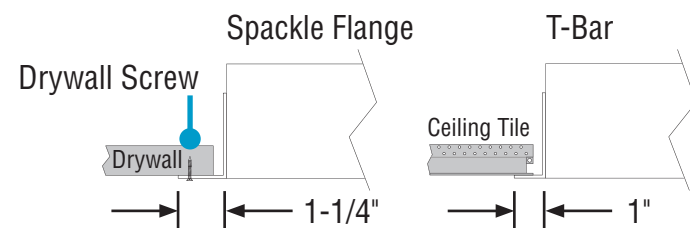

The **Telescoping Endcap** adds:

- A minimum of 2" to a 2' section
- A minimum of 1" to a 3' section
- A minimum of 1" to 4' and 8' sections

### B. 1/4"-20 Threaded Rod Locations Top View

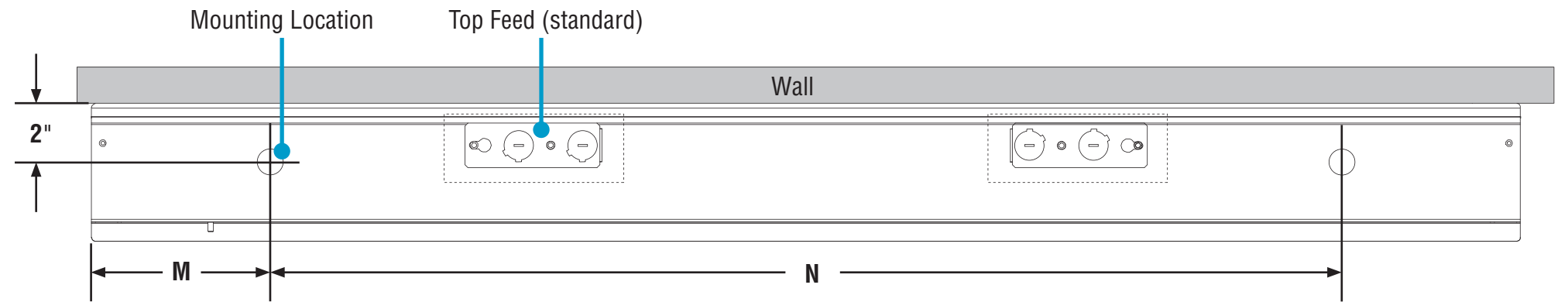

Luminaire Length	M (in)	N (in)
2'	3	18
3'	3	30
4'	6	36
8'	6	84

### Alternative "L" Bracket Mounting (by others)

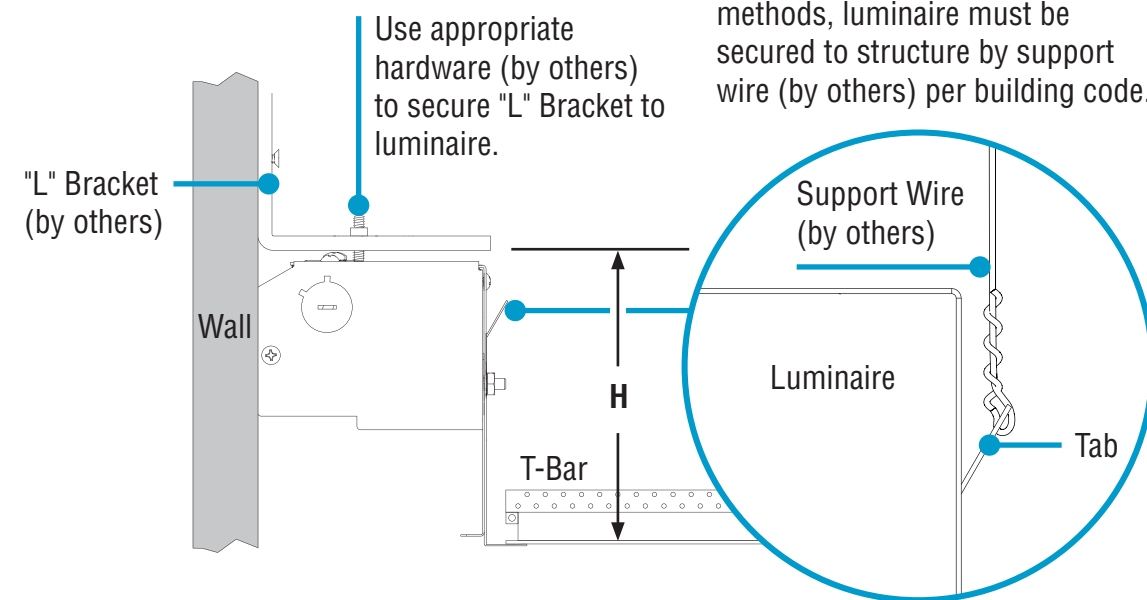

In addition to alternative mounting methods, luminaire must be secured to structure by support wire (by others) per building code.

Luminaire Depth	4" W (in)	6" W (in)
2"	H = 5-1/8"	H = 5-1/8"
4"	H = 7-1/8"	H = 7-1/8"
6"	H = 9-1/8"	H = 9-1/8"

### Alternative Mount to Structure (by others)

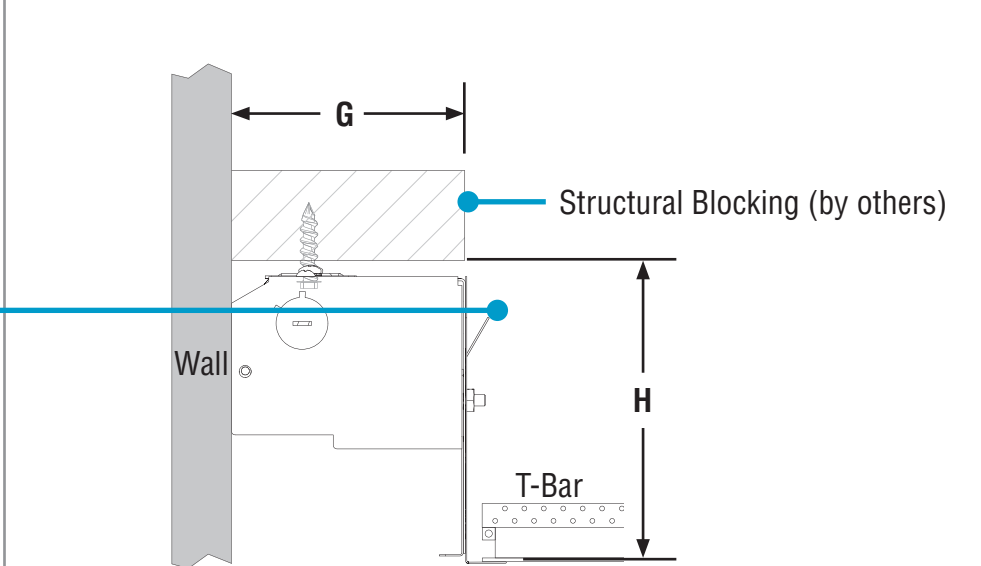

Luminaire Depth	4" W (in)	6" W (in)
2"	G = 4-5/8 H = 5-1/8"	G = 6-5/8 H = 5-1/8"
4"	G = 4-5/8 H = 7-1/8"	G = 6-5/8 H = 7-1/8"
6"	G = 4-5/8 H = 9-1/8"	G = 6-5/8 H = 9-1/8"

# HP-WS Perimeter Slot Post-Ceiling T-Bar Installation Instructions

## Step 2 - Identification & Preparation

### A. Identify Luminaires



Arrange luminaires in order according to ID# at their install locations.

**CAUTION**

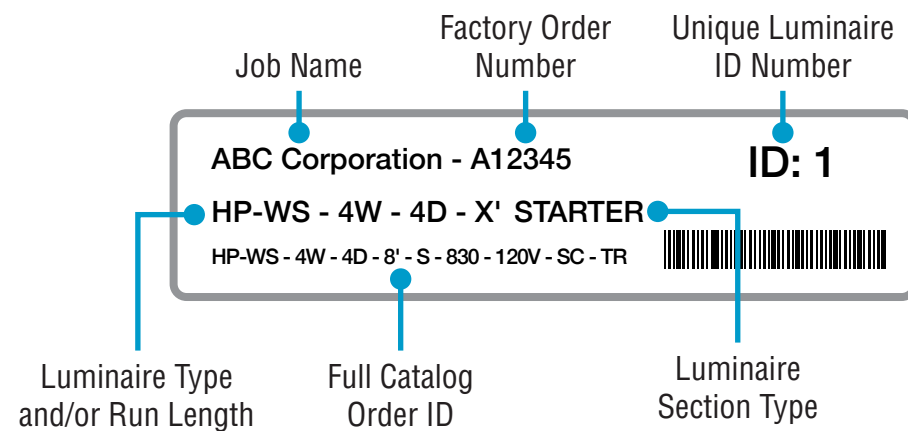

Bottom-Up View

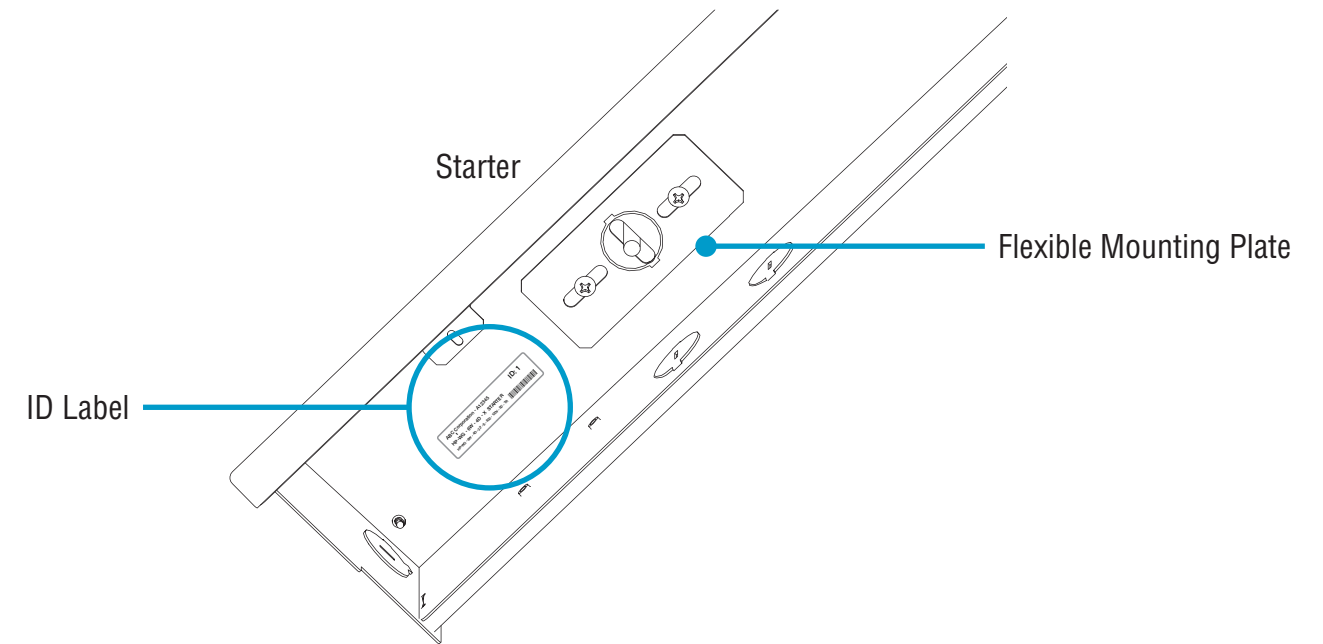

- Identify all luminaires by their ID label that can be found on the box and inside the luminaire.
- **NOTE:** Exact location of labels in these areas may vary.
- Remove all luminaires from their box.
- Refer to Record Drawings that can be found in the hardware kit.

### Kitted Hardware

- Finelite has provided items listed here, with their Finelite part numbers. These items can be found in separate boxes shipped with the luminaire.
- Account for all parts and set aside until they are needed.
- All other hardware needed for this installation will be by others.



**#8-18 x 1/4" Screw**  
Part# 69026  
Feed Locations & Options p. 4, Step 3  
Mounting Starter to Structure p. 6-7, Step 4  
Joining Luminaires p. 8, Step 5  
Inside Corner p. 9-12, Step 6A  
Outside Corner p. 13-16, Step 6B  
Straight Telescope p. 18, Step 7  
Closing Luminaires p. 19, Step 8



**#10-32 Screw**  
Part# 94144  
Feed Locations & Options p. 4, Step 3



**#4-24 x 1/4" Self-Drilling Screws**  
Part# 94416  
Mounting Starter to Structure p. 6, Step 4  
Closing Luminaires p. 19, Step 8



**Nut**  
Part# 62071  
Inside Corner p. 11, Step 6A  
Outside Corner p. 15, Step 6B

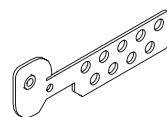

**T-Bar Bracket**  
Part# 11303  
Closing Luminaires p. 19, Step 8



**Flex Conduit**  
Part# 96627  
Inside Corner p. 9, Step 6A  
Outside Corner p. 13, Step 6B



**Telescope T-Bar Extrusion**  
Part# 11923  
Inside Corner p. 11, Step 6A  
Outside Corner p. 15, Step 6B

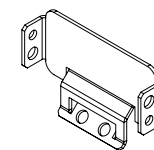

**Extrusion Joiner Bracket**  
Part# 11302  
Inside Corner p. 11, Step 6A  
Outside Corner p. 15, Step 6B



**Extrusion Cut Guide**  
Part# 11999  
Inside Corner p. 10, Step 6A  
Outside Corner p. 14, Step 6B



**Wall Trim Gaskets**  
Part# 11987  
Inside Corner p. 10, Step 6A  
Outside Corner p. 14, Step 6B

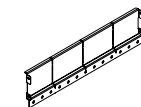

**Telescope Vertical Cover**  
Part# 11894 - 2" Depth  
Part# 11895 - 4" Depth  
Part# 11896 - 6" Depth  
Inside Corner p. 12, Step 6A  
Outside Corner p. 16, Step 6B



**Inside Corner Cover Bracket**  
Part# 11902 - 2" Depth  
Part# 11903 - 4" Depth  
Part# 11904 - 6" Depth  
Inside Corner p. 12, Step 6A





**Outside Corner Cover Bracket**  
Part# 11913 - 2" Depth  
Part# 11914 - 4" Depth  
Part# 11915 - 6" Depth  
Outside Corner p. 16, Step 6B

# HP-WS Perimeter Slot Post-Ceiling T-Bar Installation Instructions

## Step 3 - Feed Locations & Options

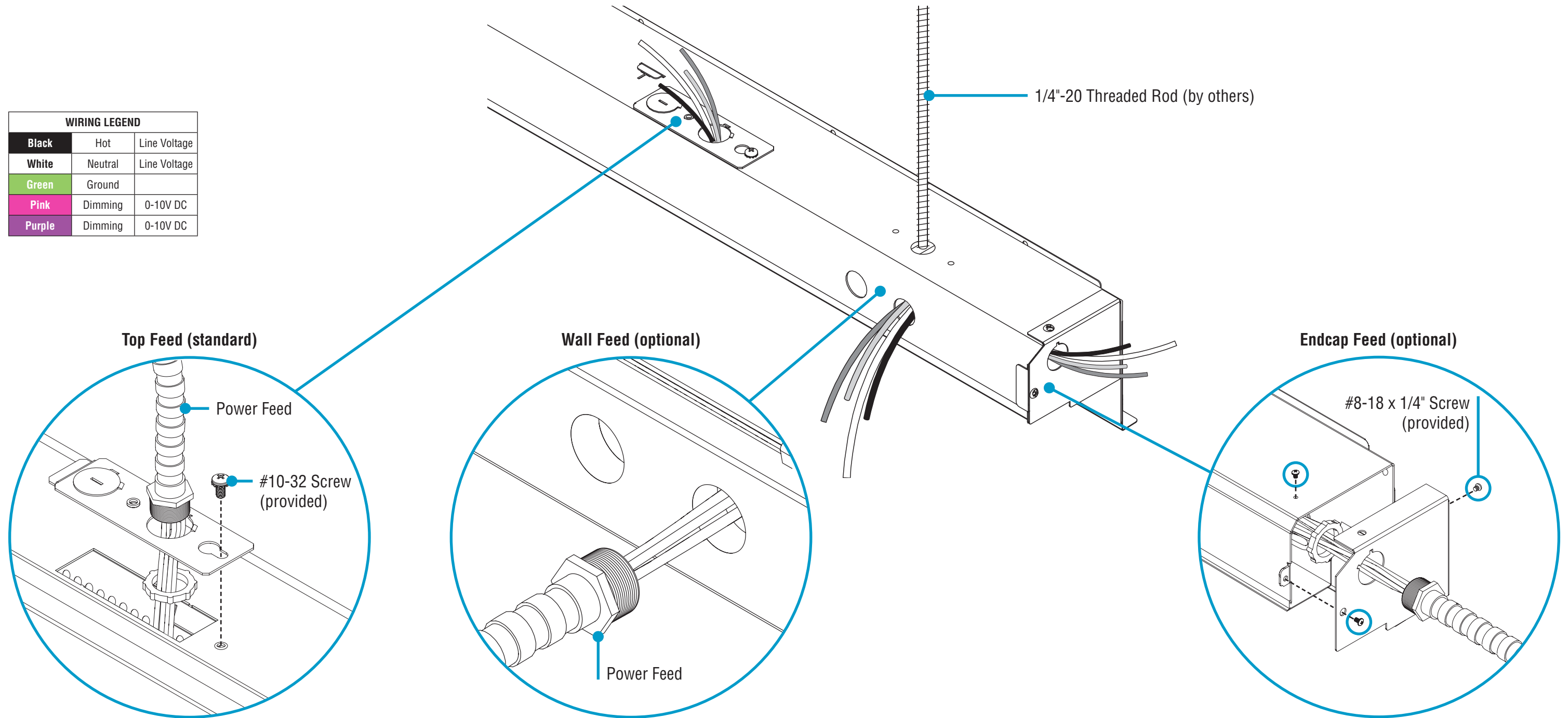
WIRING LEGEND		
Black	Hot	Line Voltage
White	Neutral	Line Voltage
Green	Ground	
Pink	Dimming	0-10V DC
Purple	Dimming	0-10V DC



 #8-18 x 1/4" Screw (provided)

 #10-32 Screw (provided)

CONTINUED



0-10V Dimming

# HP-WS Perimeter Slot Post-Ceiling T-Bar Installation Instructions

## Step 3 - Feed Locations & Options

**Top Feed** Top View

Luminaire Length	A (in)
2'	5
3'	5
4'	12
8'	12

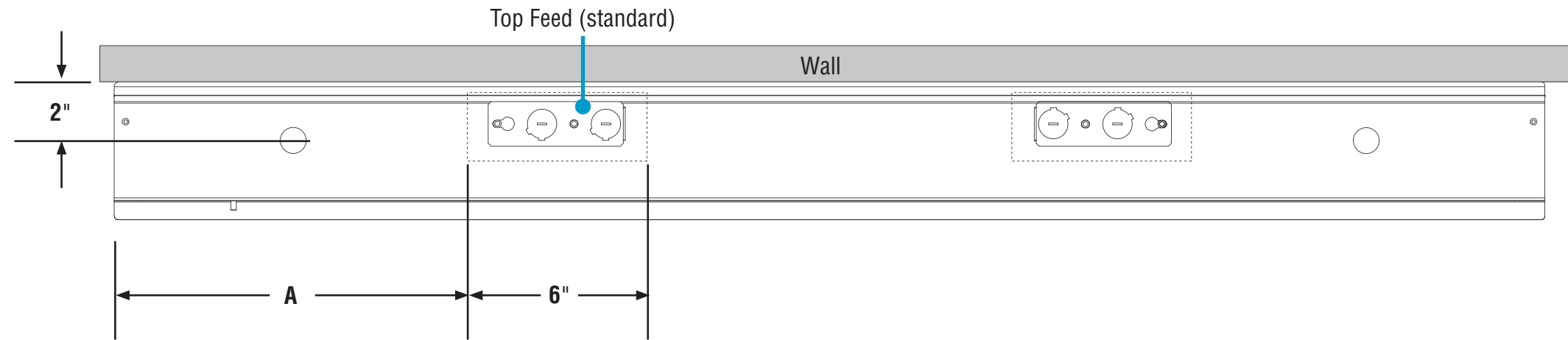

**Top Feed Location (standard)**

- Use chart above to find measurement of **A** for feed location

**Wall Feed** Back View

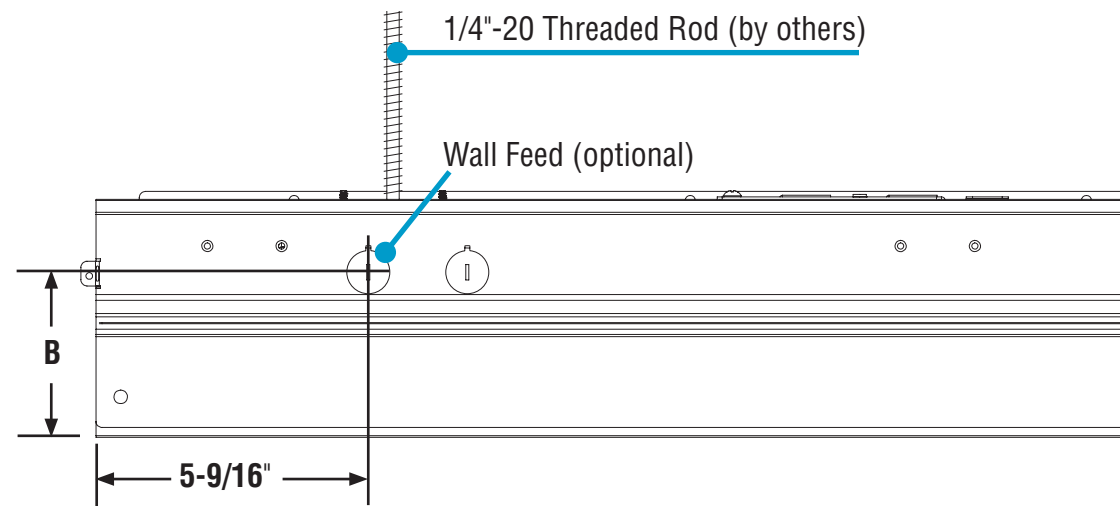

Luminaire Depth	B (in)
2"	3-5/16
4"	5-5/16
6"	7-5/16

**Endcap Feed** Side View

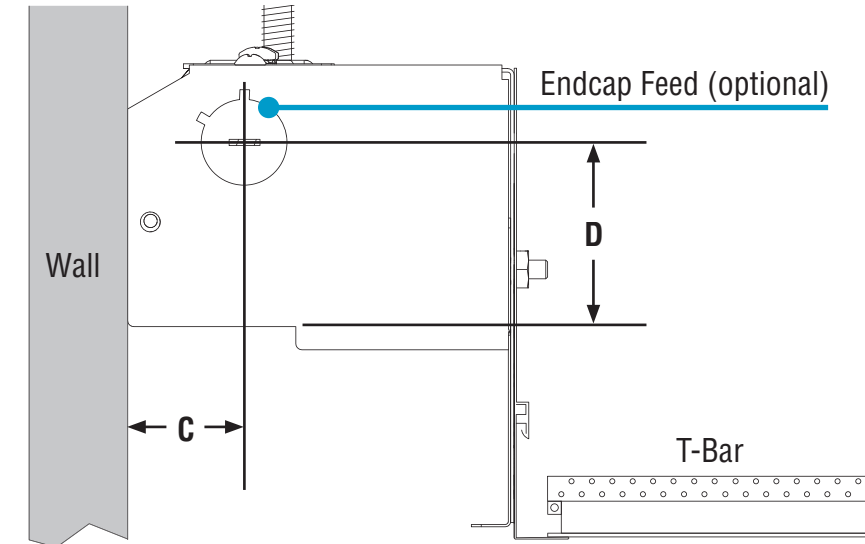

Luminaire Width	C (in)	D (in)
4"	1-3/16	1-7/8
6"	2	1-7/8

# HP-WS Perimeter Slot Post-Ceiling T-Bar Installation Instructions

## Step 4 - Mounting Starter to Structure

### A. Remove Tapered Optic & Diffuser Bottom-Up View

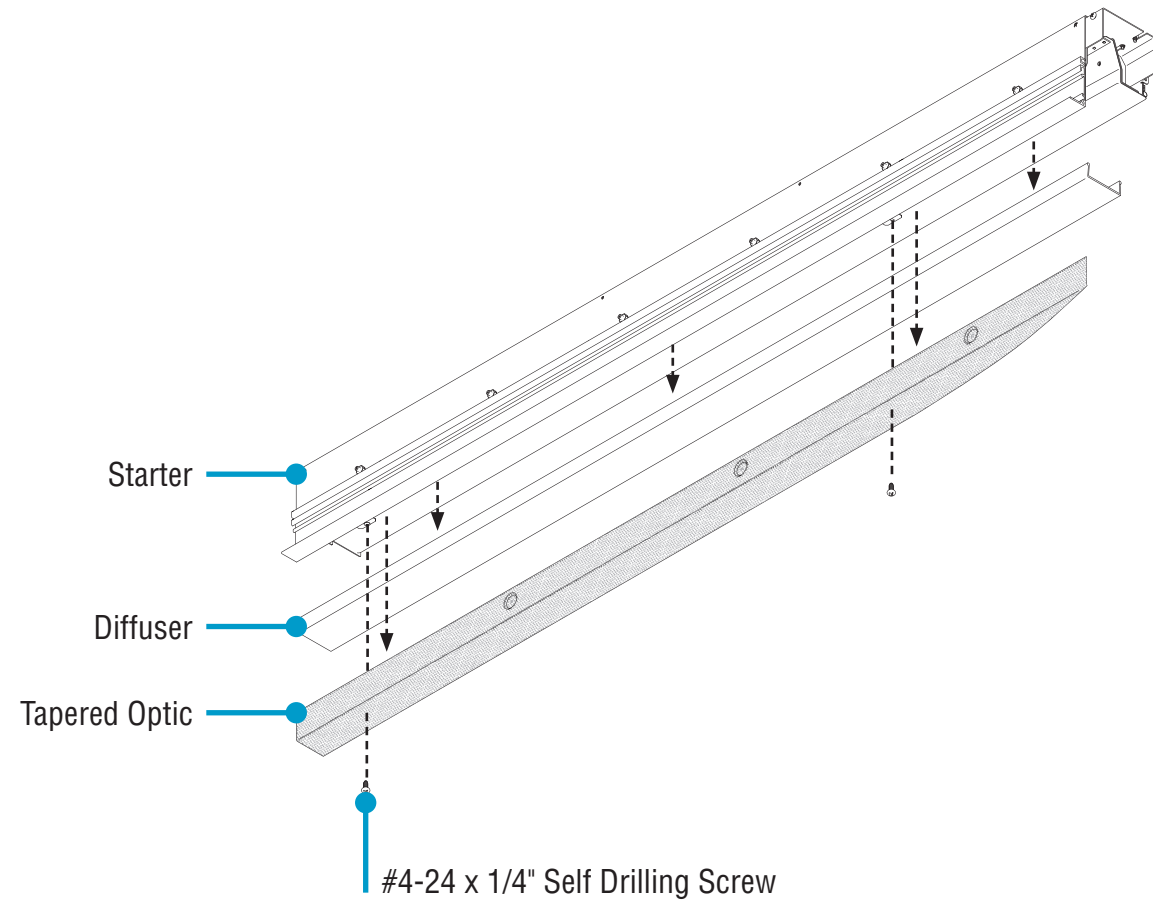

- Make electrical connections according to feed location and options.
- If using tapered optics, remove #4-24 x 1/4" self drilling screws. Set screws aside.
- Remove diffusers and set aside to prevent them from getting dirty or damaged.

 #4-24 x 1/4" Self Drilling Screws  
(provided)

 #8-18 x 1/2" Screw  
(provided)

### B. Remove Carrier Bottom-Up View

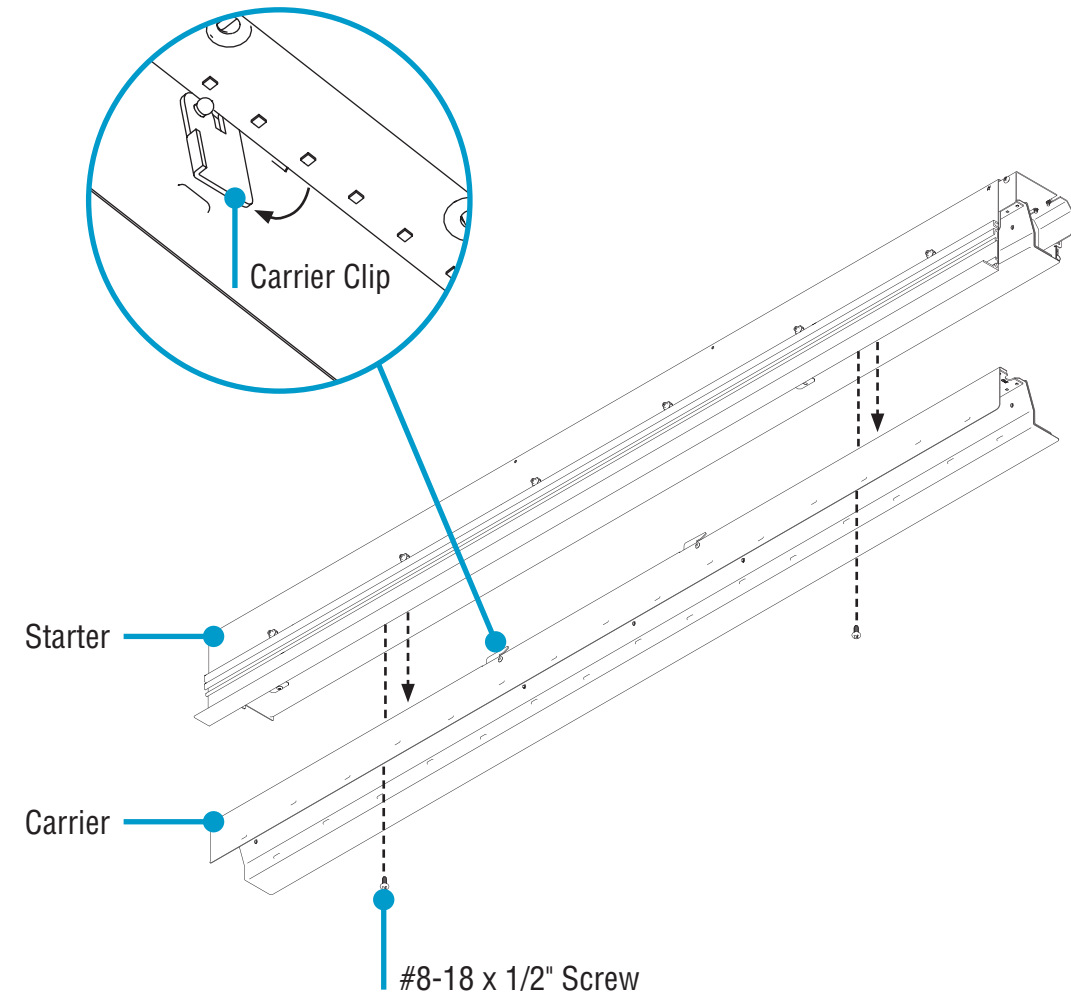

- Remove #8-18 x 1/2" screws.
- Twist carrier clips clockwise to release carrier.
- The carrier will be suspended by safety cables but you can remove them for completely open access.

**CONTINUED**

# HP-WS Perimeter Slot Post-Ceiling T-Bar Installation Instructions

## Step 4 - Mounting Starter to Structure

### C. Mount Luminaire

#### Standard

Bottom-Up View

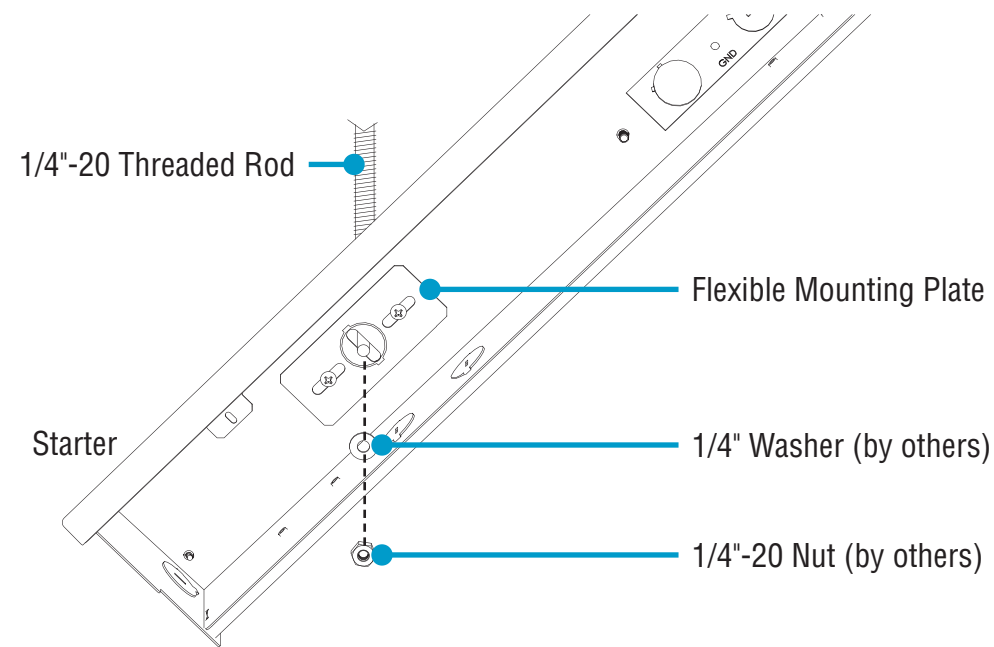

#### MOUNT TO THREADED ROD (Standard)

- Mount the luminaire to structure using a 1/4"-20 nut and washer on a threaded rod.
- **NOTE:** The flexible mounting plate can move for a precise fit.
- If there is no joiner/ender, then tighten nuts fully. **PROCEED TO STEP 6.**

#### Option 1

Side View

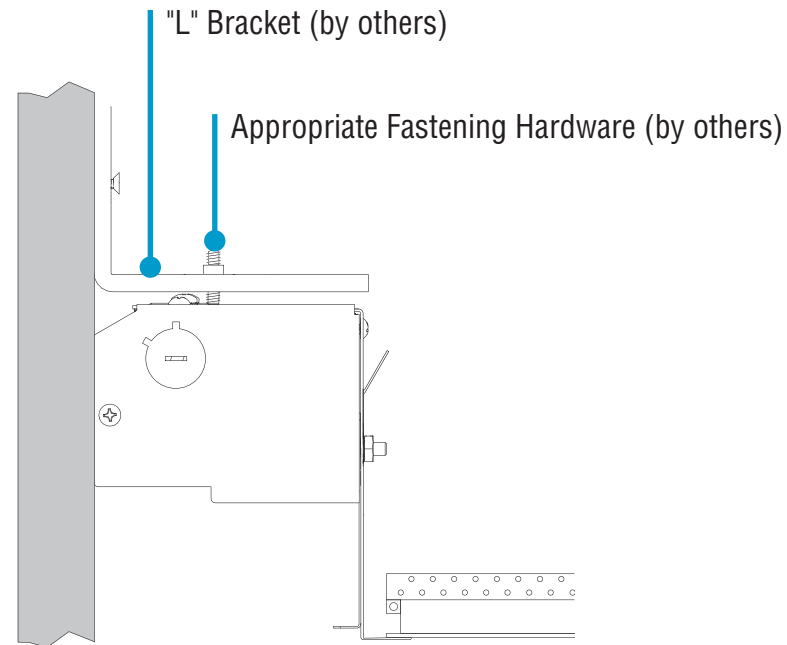

#### MOUNT TO "L" BRACKET (Optional)

- Mount the luminaire to structure using an "L" bracket with appropriate fastening hardware.
- **NOTE:** The flexible mounting plate can move for a precise fit.
- If there is no joiner/ender, then tighten nuts fully. **PROCEED TO STEP 6.**

#### Option 2

Side View

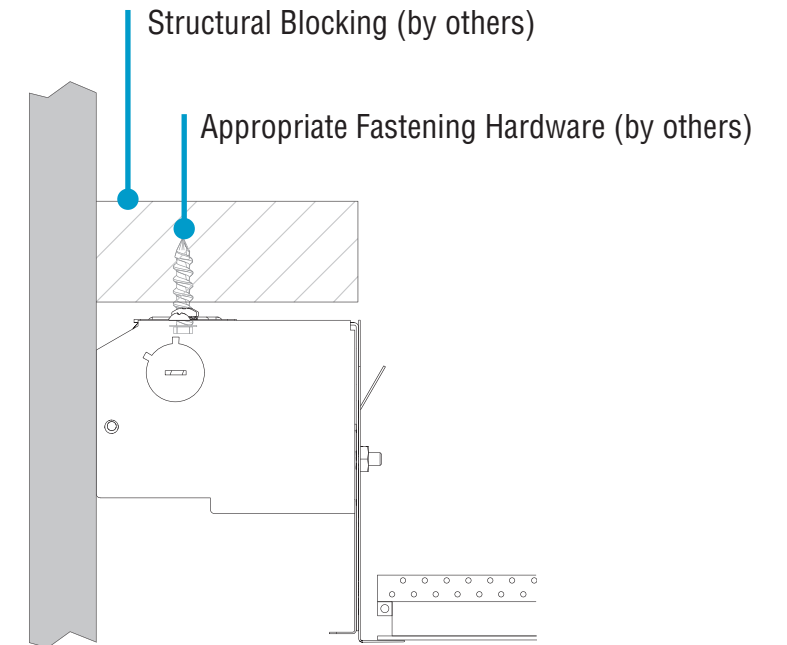

#### MOUNT TO STRUCTURE (Optional)

- Mount the luminaire to structure using appropriate fastening hardware.
- **NOTE:** The flexible mounting plate can move for a precise fit.
- If there is no joiner/ender, then tighten fully. **PROCEED TO STEP 6.**

 #8-18 x 1/2" Screw  
(provided)

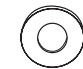
 1/4" Washer  
(by others)

 1/4"-20 Nut  
(by others)

 "L" Bracket  
(by others)

# HP-WS Perimeter Slot Post-Ceiling T-Bar Installation Instructions

## Step 5 - Joining Luminaires

### A. Align Starter and Joiner/Ender Bottom-Up View

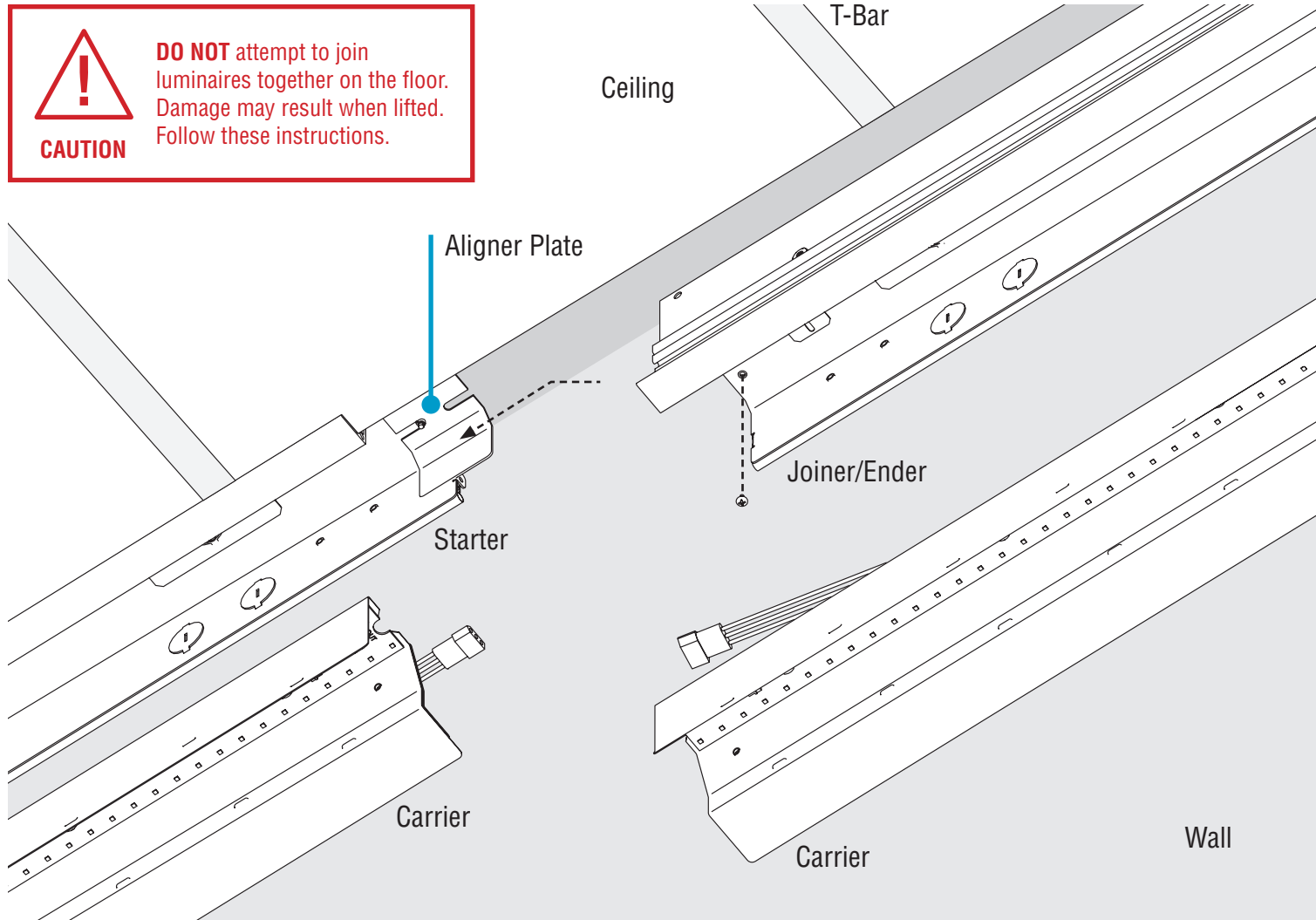

**CAUTION**  **DO NOT** attempt to join luminaires together on the floor. Damage may result when lifted. Follow these instructions.

- Slide the joiner/ender luminaire over the aligner plate on the installed luminaire.
- Secure the joiner luminaire to the aligner plate with #8-18 x 1/4" screw.
- See page 7, Step 4C for how to secure a joiner/ender luminaire to structure.
- **NOTE:** Slightly tilt starter and joiner/ender luminaires before installing onto wall.

 #8-18 x 1/4" Screw (provided)

 #8-18 x 1/2" Screw (provided)

### B. Plug-Together Wiring Bottom-Up View

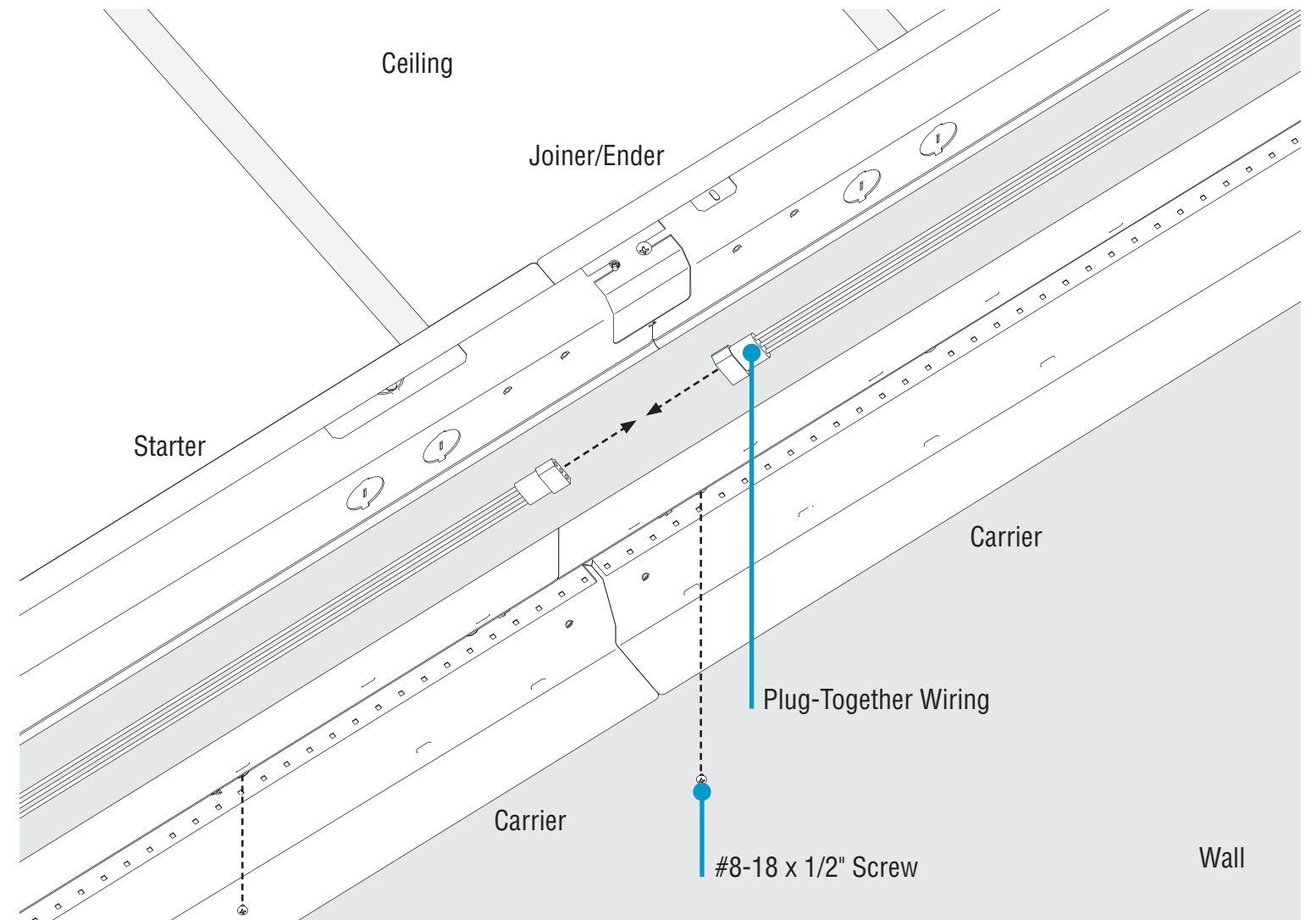

- Connect the plug-together wiring.
- Secure all luminaires by tightening all nuts to threaded rods.
- Reattach all carriers by rotating carrier clips 90° counter-clockwise.
- Secure the carriers with #8-18 x 1/2" screws.



Simple Plug-Together Wiring



# HP-WS Perimeter Slot Post-Ceiling T-Bar Installation Instructions

## Step 6A - Inside Corner

### A. Inside Corner Support Bracket Bottom-Up View

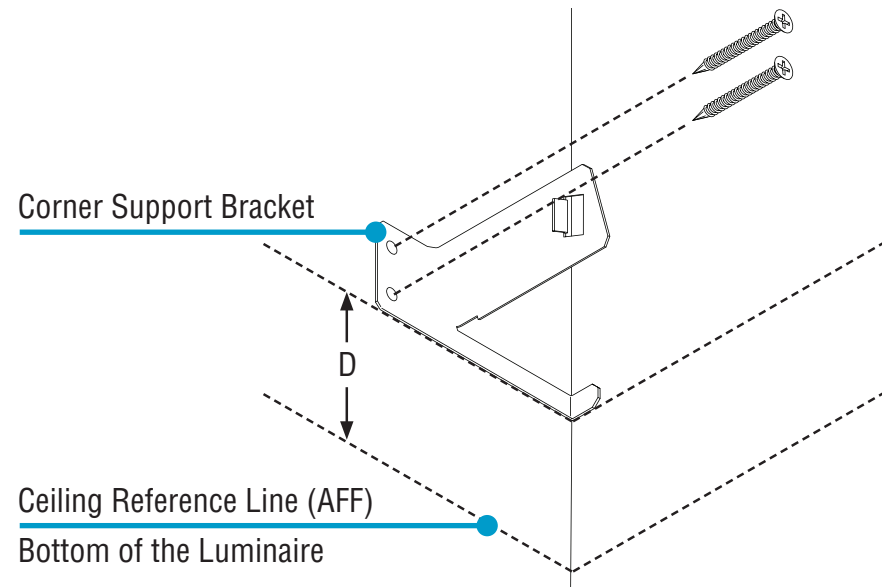

Luminaire Depth	D (in)
2"	AFF ceiling height + 3-5/16
4"	AFF ceiling height + 5-5/16
6"	AFF ceiling height + 7-5/16

- Fasten inside corner support bracket at distance **D** from the ceiling reference line A.F.F.\*.
- Fasten bracket using appropriate #10 screws.

\*A.F.F. - Above Finished Floor

### B. Connect Corner Joint Top-Down View

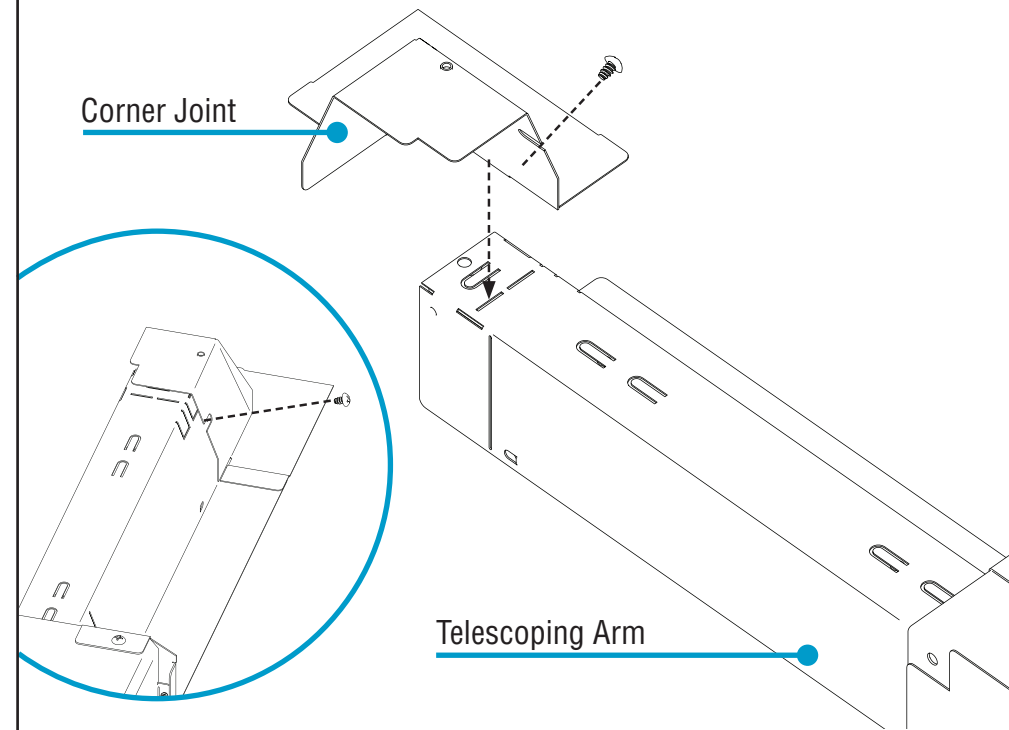

- Connect the corner joint to the right telescope arm using #8-18 x 1/4" screw.

### C. Connect Flex Conduit Bottom-Up View

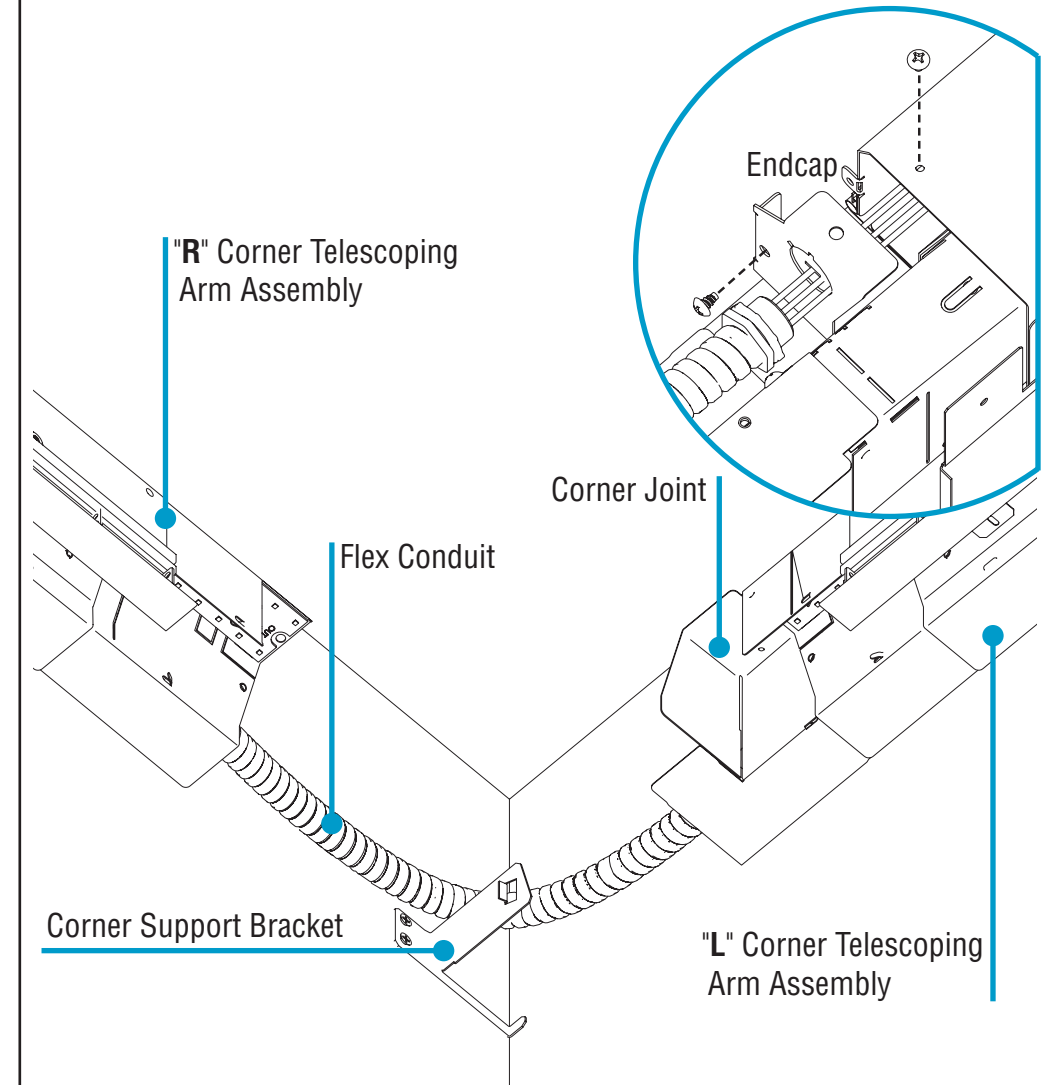

- Connect the through wiring using flex conduit. Make sure the flex conduit goes above the corner support bracket.
- To connect flex conduit, remove telescope endcap by removing two #8-18 x 1/4" screws for access.

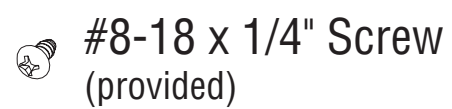
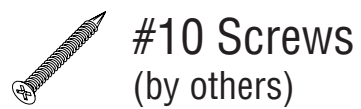

CONTINUED

# HP-WS Perimeter Slot Post-Ceiling T-Bar Installation Instructions

## Step 6A - Inside Corner

### D. Connect Telescoping Arms Bottom-Up View

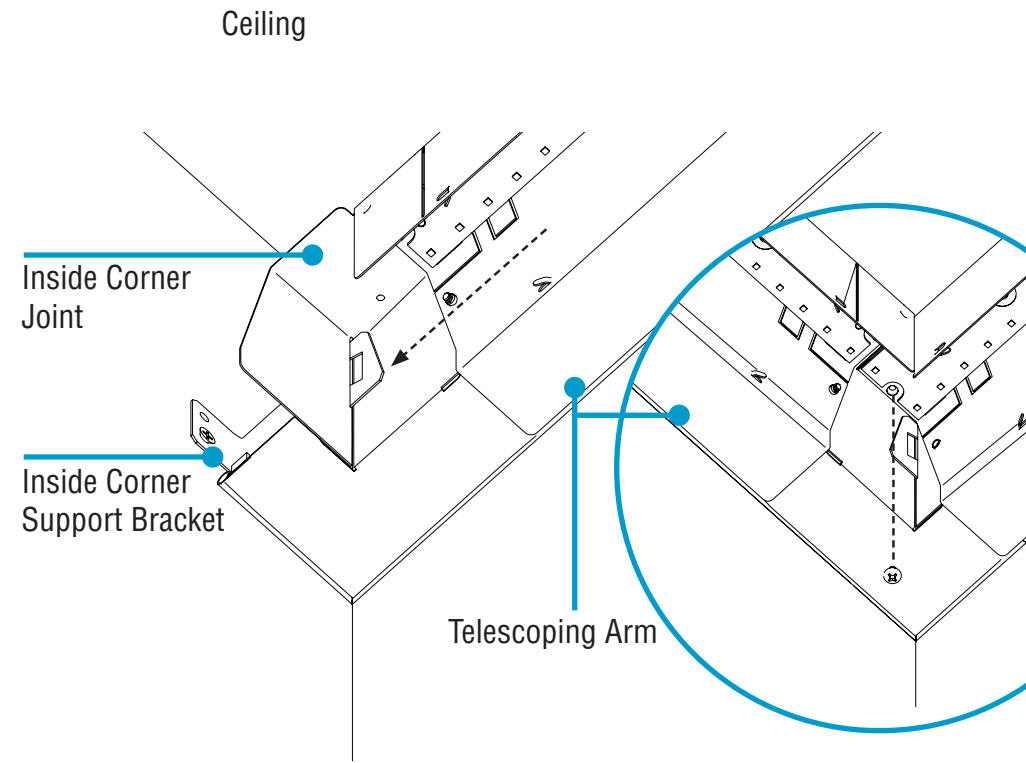

- Mount right side telescope arm to corner support bracket.
- Connect left telescope arm and fasten to right telescope arm with #8-18 x 1/4" screw.

### E. Install Gaskets Top View

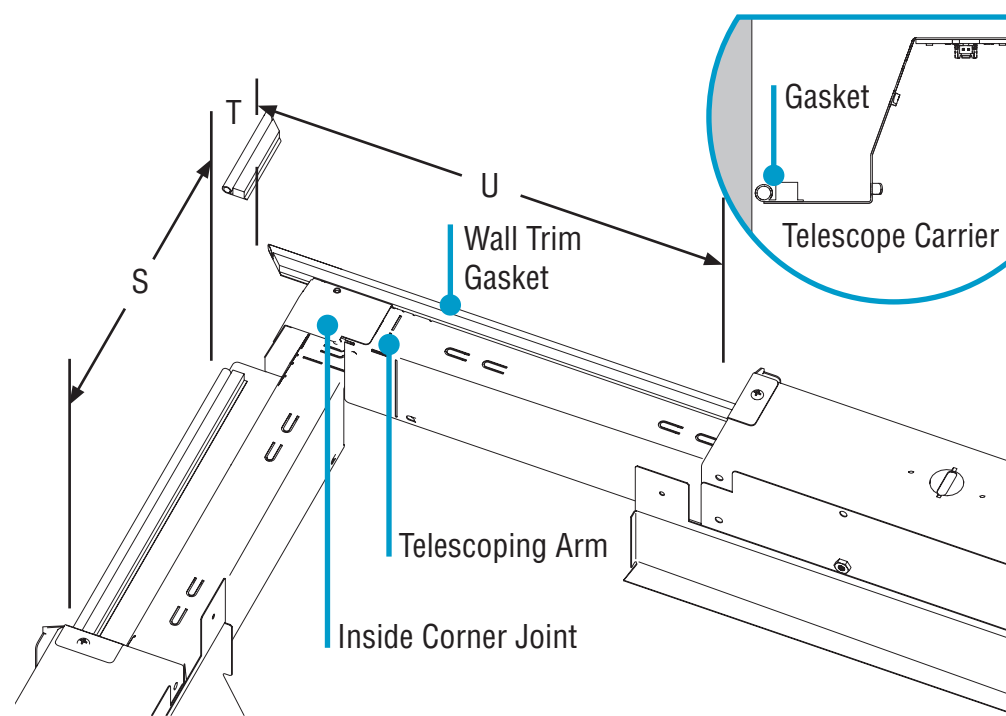

- Locate wall trim gasket and cut to lengths **S**, **T**, & **U**.
- Extend telescope arms and remove liner to expose adhesive.
- Attach gaskets to telescope carriers as shown.

### F. Using The Extrusion Cut Guide Bottom-Up View

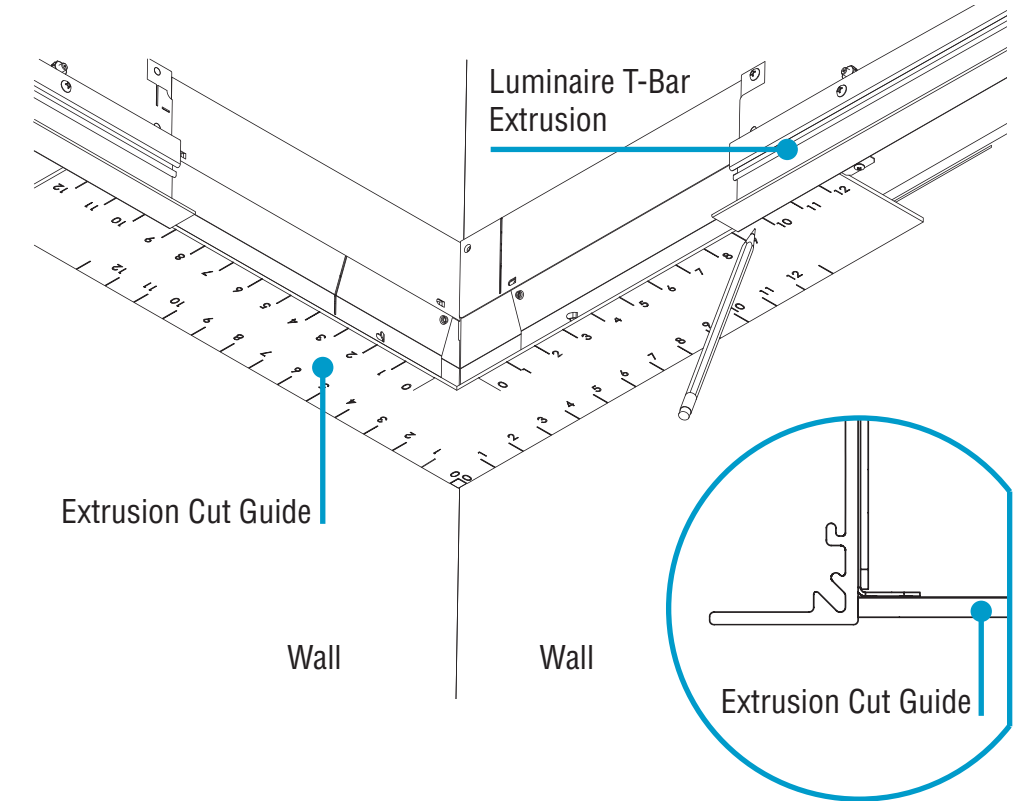

- Use the extrusion cut guide by placing it on the inner-side of the luminaire T-Bar extrusion just above the T-Bar flange.
- Mark where the extrusion ends for both sides.

 #8-18 x 1/4" Screw  
(provided)

 Wall Trim Gaskets  
(provided)

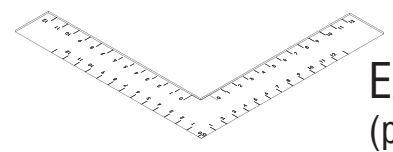
 Extrusion Cut Guide  
(provided)

**CONTINUED**

# HP-WS Perimeter Slot Post-Ceiling T-Bar Installation Instructions

## Step 6A - Inside Corner

### G. Cut the Telescoping T-Bar Extrusion Bottom-Up View

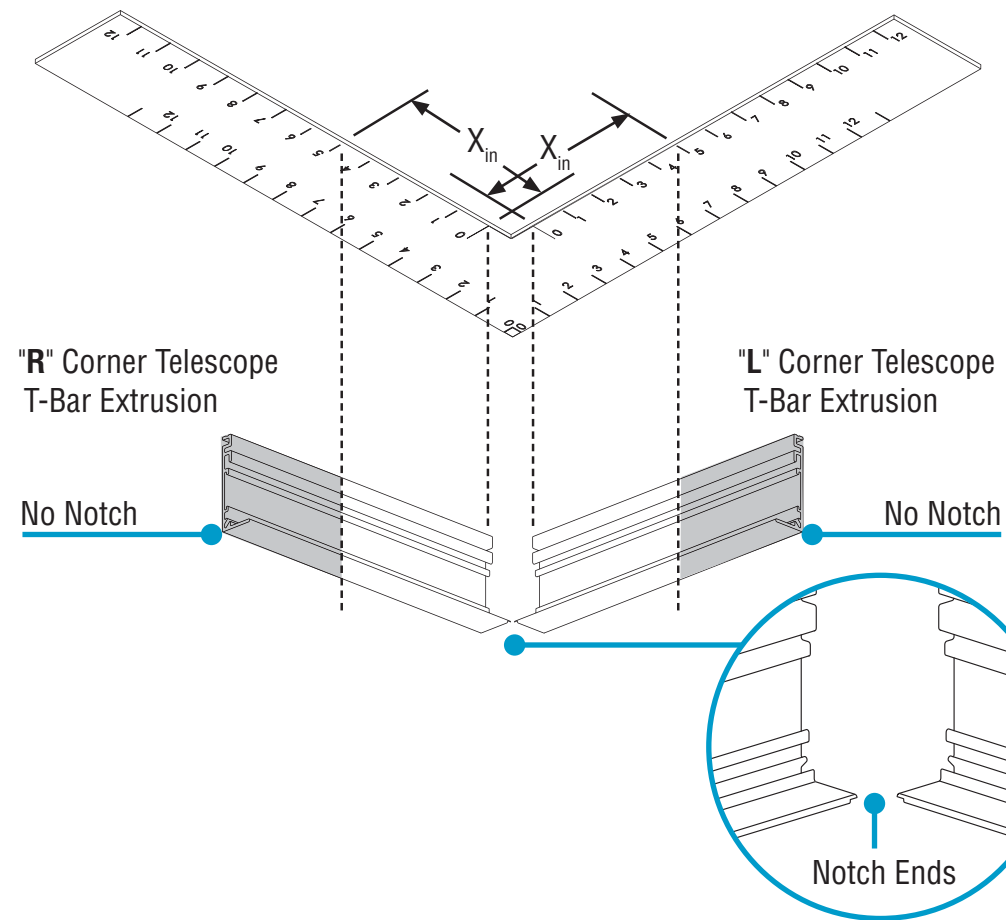

- Use the measurements found in previous step to cut the telescope T-Bar extrusions to length.

### H. Secure Extrusion Bracket Top View

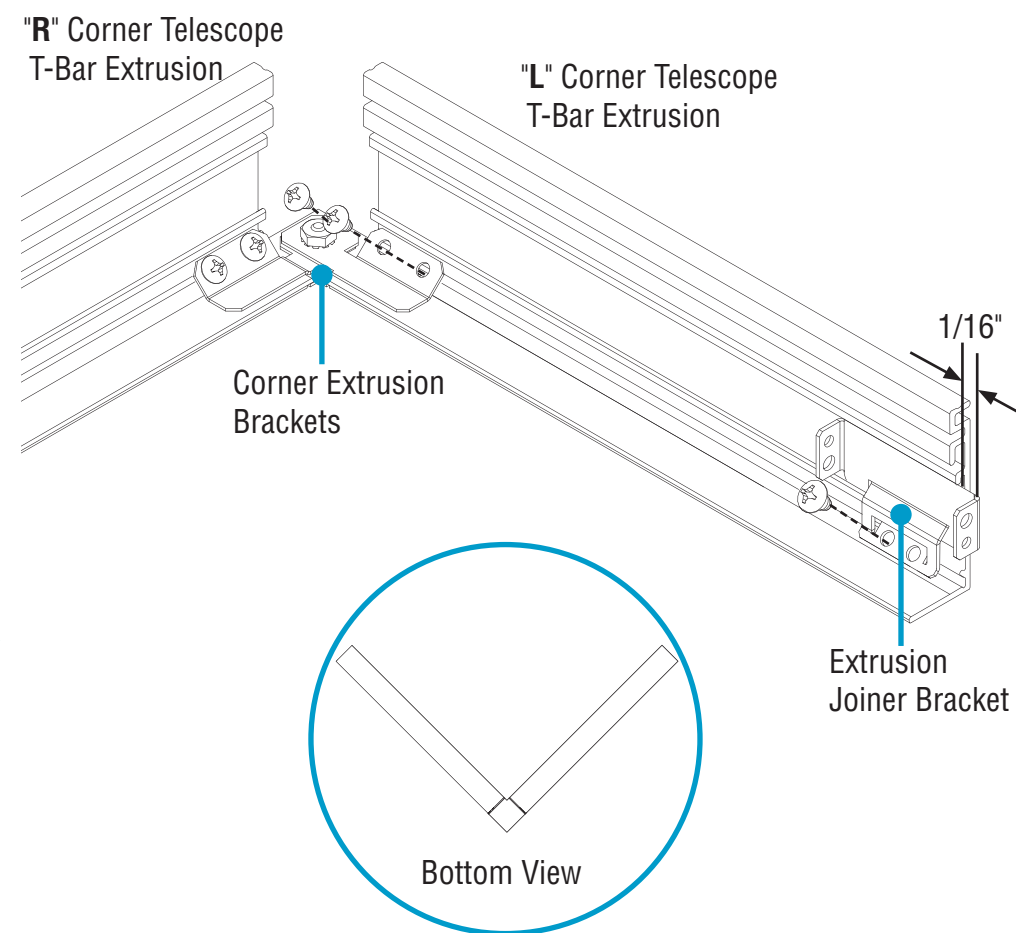

- Make sure the corner extrusion bracket is fastened to both pieces of the telescope T-Bar extrusion by lining up the bracket to the edge of the extrusion.
- Fasten using #8-18 x 1/4" screws.
- Slide the extrusion joiner bracket into the telescope T-Bar extrusion as shown.
- Pin with #8-18 x 1/4" screws.
- Make sure to leave a 1/16" gap from the extrusion joiner bracket to the end of the telescope T-Bar extrusion.

### I. Install Telescoping T-Bar Extrusion Top View

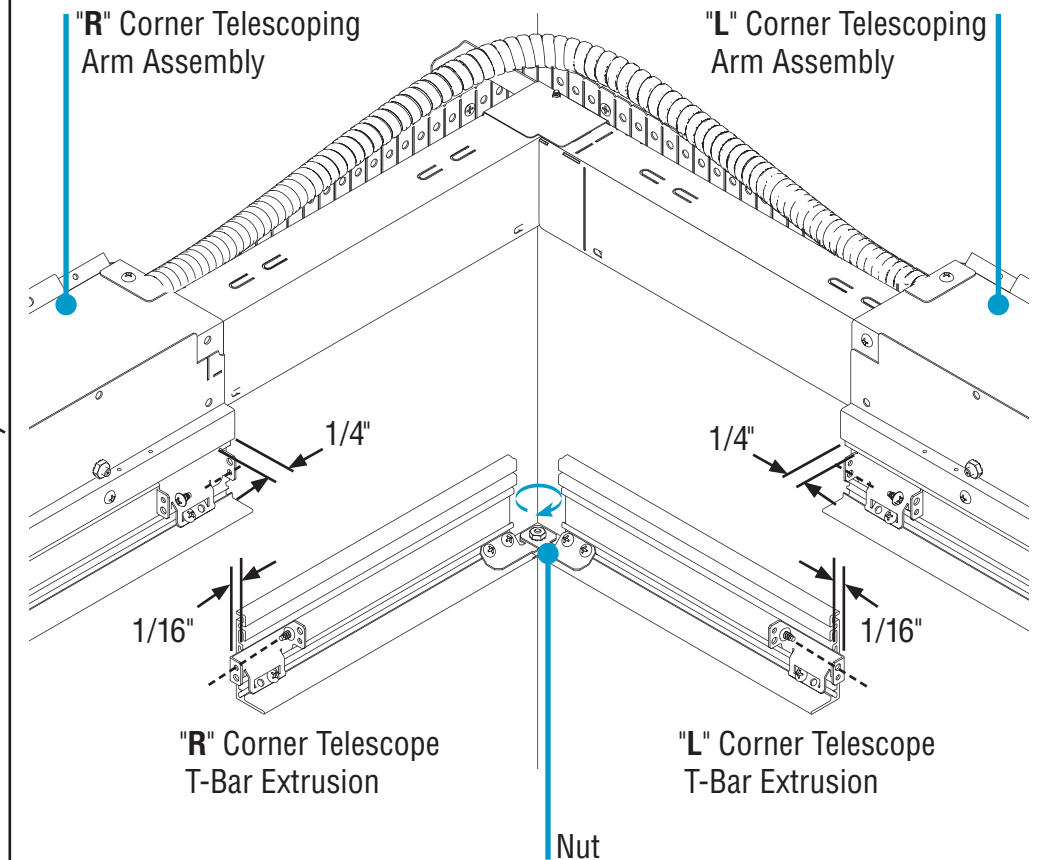

- Join the telescope T-Bar extrusions to the luminaire T-Bar extrusions using #8-18 x 1/4" screws to pull together the adjacent extrusion joiner brackets.
- Leave a 1/16" gap between the two extrusion joiner brackets.
- Tighten nut to solidify telescope T-Bar extrusion corner joint.

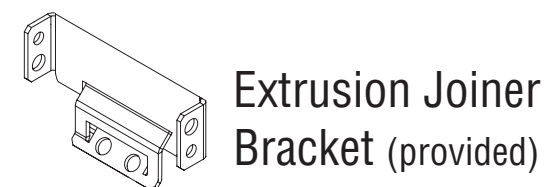
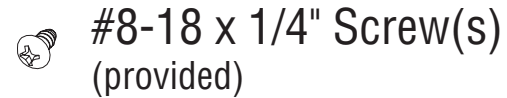

CONTINUED

# HP-WS Perimeter Slot Post-Ceiling T-Bar Installation Instructions

## Step 6A - Inside Corner

**J. Telescope Vertical Cover** Top View

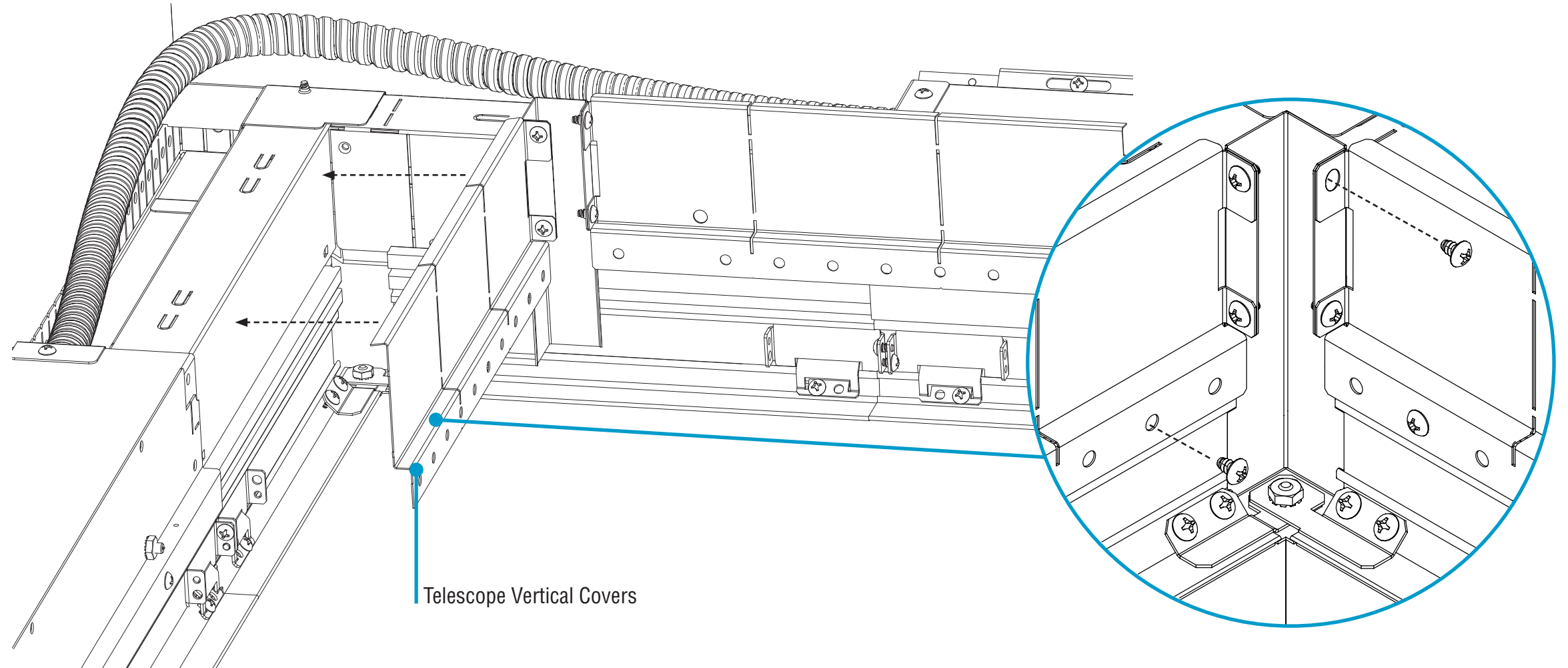
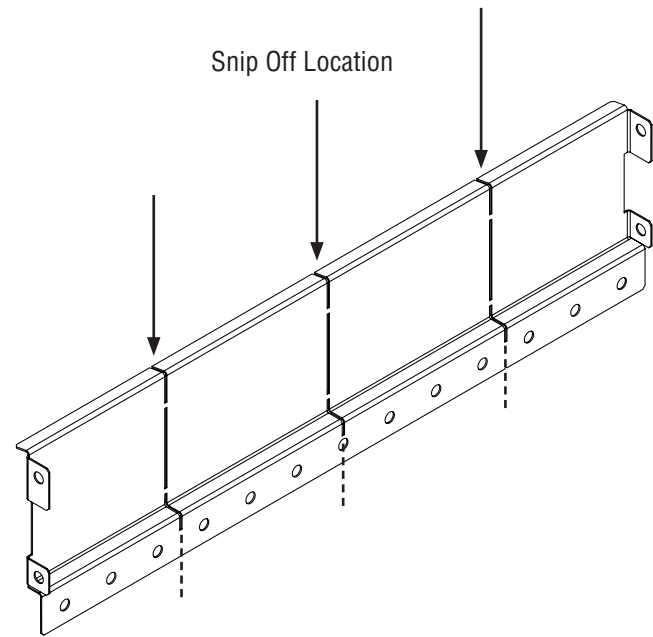

- Place telescope vertical cover subassembly over telescope T-Bar extrusions as shown.
- Fasten to telescope T-Bar extrusions using #8-18 x 1/4" screws.
- Repeat Step 6A for all inside corners.

- If necessary, snip off perforated sections of the vertical cover.

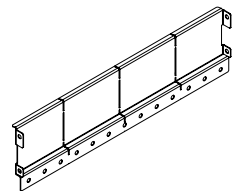

Telescope Vertical Cover (provided)



#8-18 x 1/4" Screw (provided)

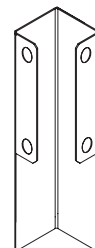

Inside Corner Cover Bracket (provided)

# HP-WS Perimeter Slot Post-Ceiling T-Bar Installation Instructions

## Step 6B - Outside Corner

### A. Outside Corner Support Bracket Bottom-Up View

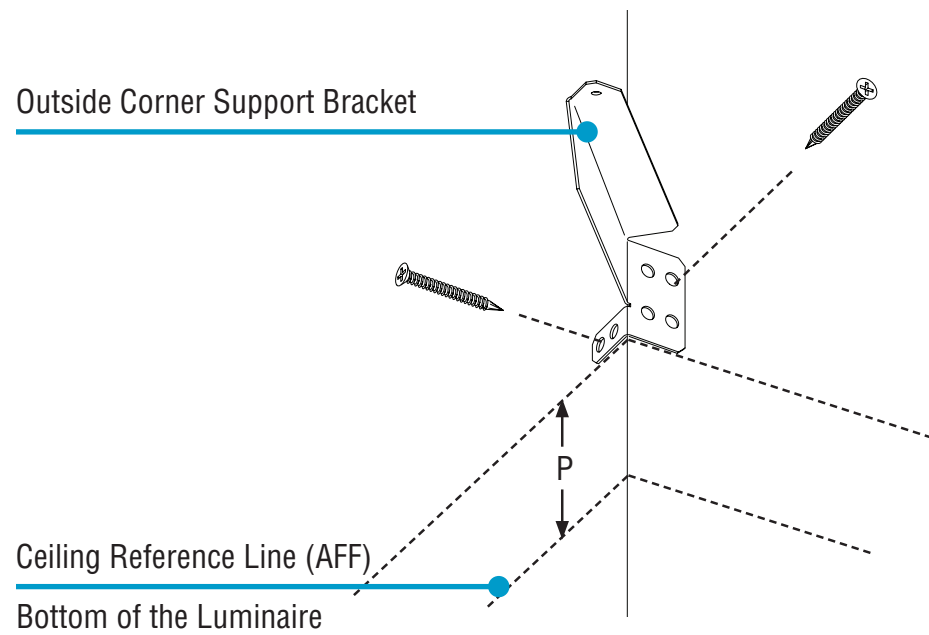

Luminaire Depth	P (in)
2"	AFF ceiling height + 3-5/16
4"	AFF ceiling height + 5-5/16
6"	AFF ceiling height + 7-5/16

- Fasten outside corner support bracket at distance **D** from the ceiling reference line A.F.F.\*.
- Fasten bracket using appropriate #10 screws.

\*A.F.F. - Above Finished Floor

### B. Connect Corner Joint Bottom-Up View

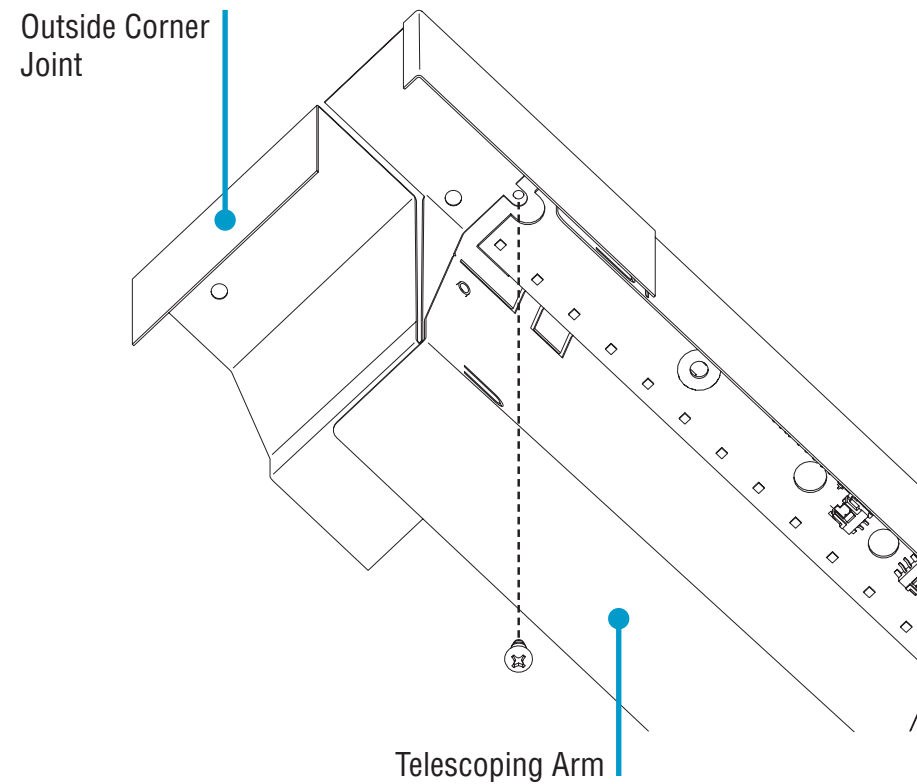

- Connect the corner joint to the right telescope arm using #8-18 x 1/4" screw.

### C. Connect Flex Conduit Bottom-Up View

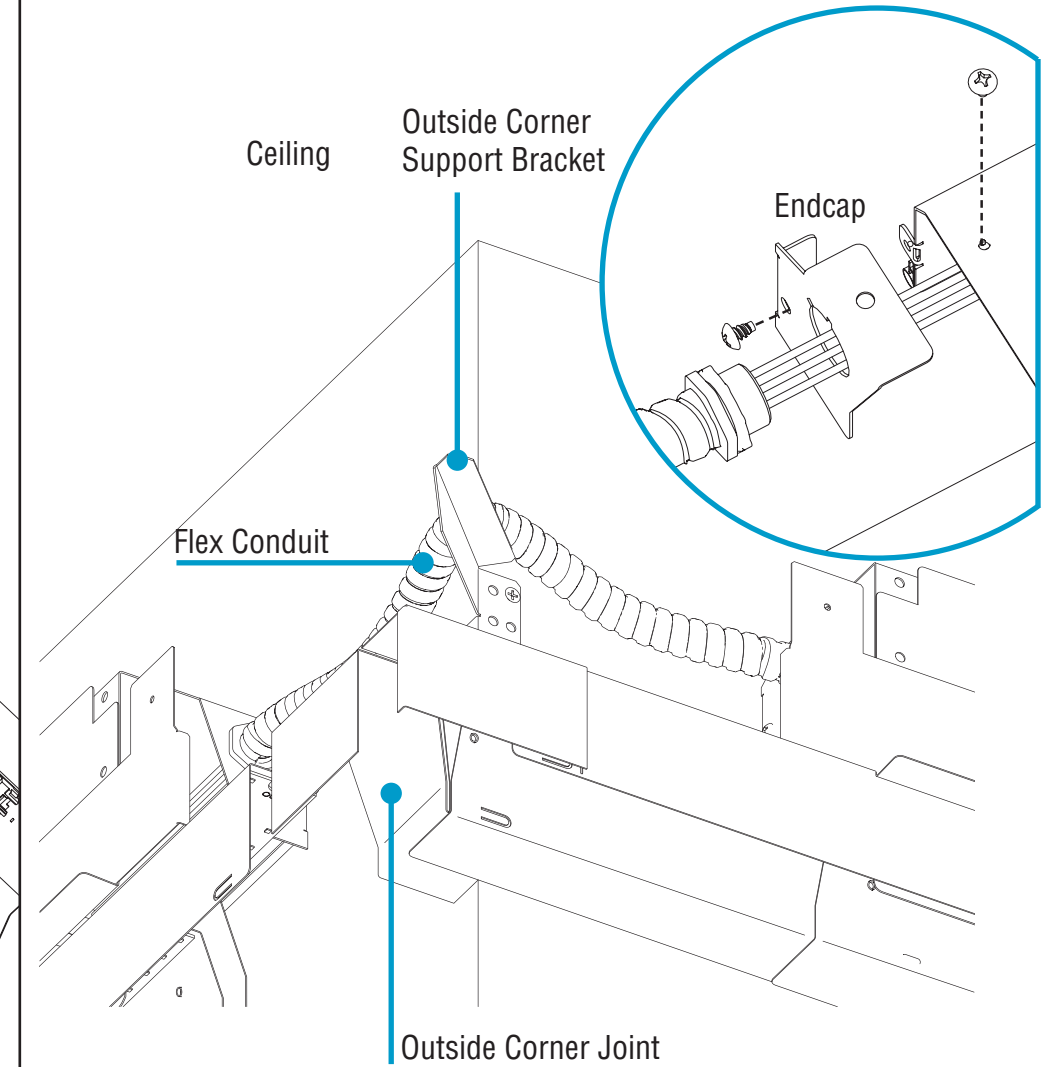

- Connect the through wiring using flex conduit. Be sure the flex conduit goes above the corner support bracket.
- To connect flex conduit, remove telescope endcap by removing two #8-18 x 1/4" screws for access.

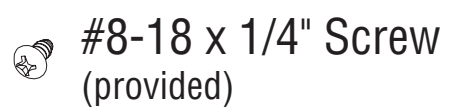
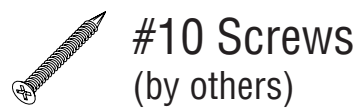

CONTINUED

# HP-WS Perimeter Slot Post-Ceiling T-Bar Installation Instructions

## Step 6B - Outside Corner

### D. Connect Telescoping Arms Bottom-Up View

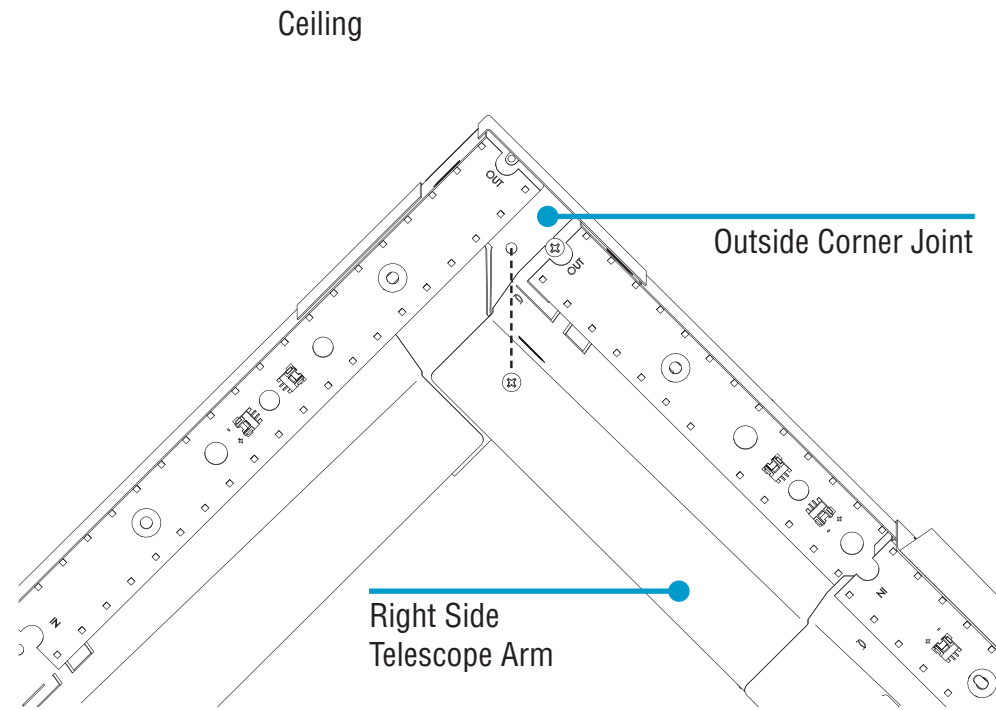

- Mount right side telescope arm to corner support bracket.
- Connect left telescope arm and fasten to right telescope arm with #8-18 x 1/4" screw.

### E. Install Gaskets Top View

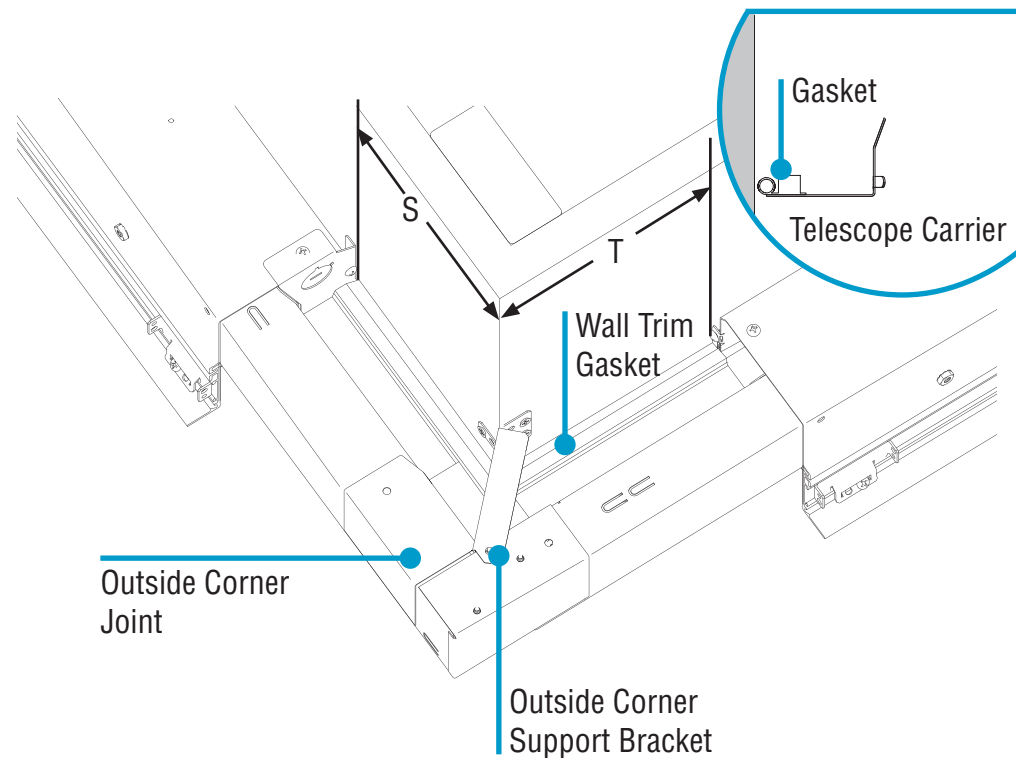

- Locate wall trim gasket and cut to lengths **S** & **T**.
- When telescope arms are extended, remove liner to expose adhesive.
- Attach gaskets to telescope carriers as shown.

### F. Using The Extrusion Cut Guide Bottom-Up View

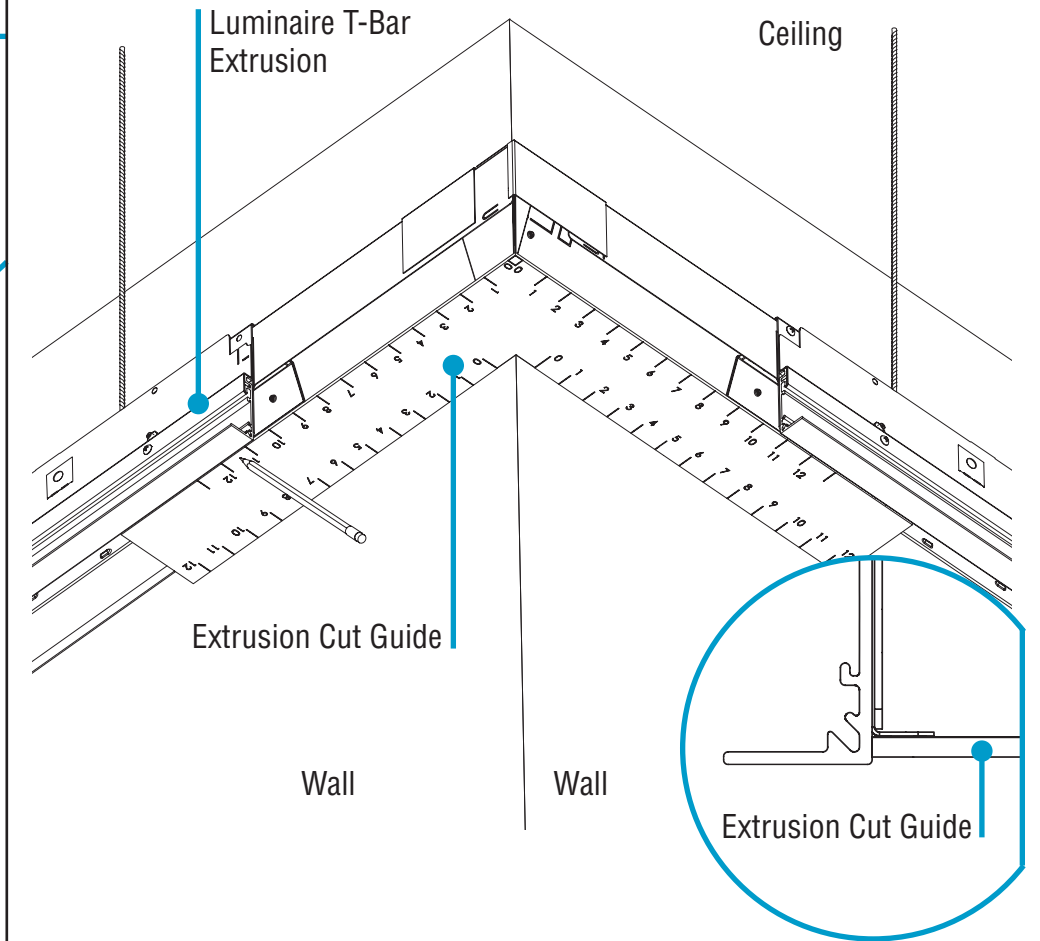

- Use the extrusion cut guide by placing it on the inner-side of the luminaire T-Bar extrusion just above the T-Bar flange.
- Mark where the extrusion ends for both sides.

 #8-18 x 1/4" Screw  
(provided)

 Wall Trim Gaskets  
(provided)

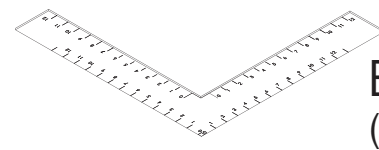
 Extrusion Cut Guide  
(provided)

**CONTINUED**

# HP-WS Perimeter Slot Post-Ceiling T-Bar Installation Instructions

## Step 6B - Outside Corner

### G. Cut the Telescope T-Bar Extrusion Bottom-Up View

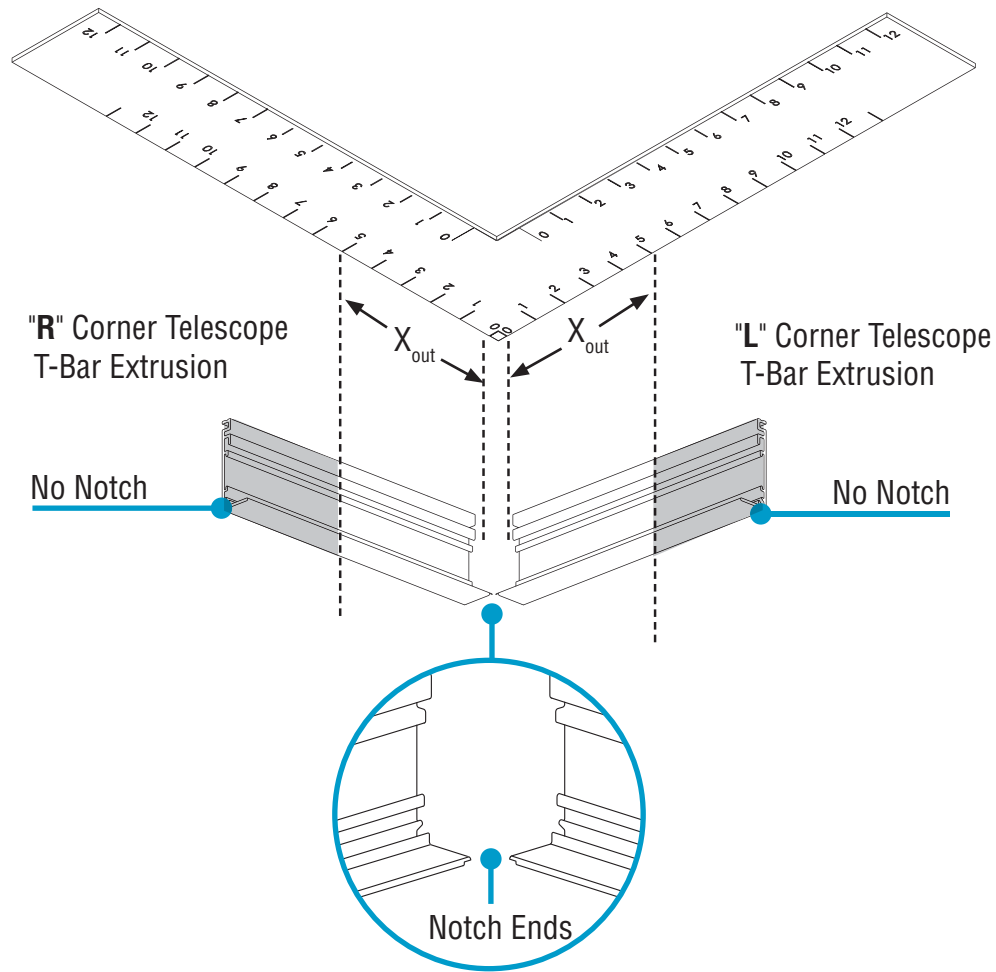

- Use the measurements found in previous step to cut the telescope T-Bar extrusions to length.

### H. Secure Extrusion Bracket Top View

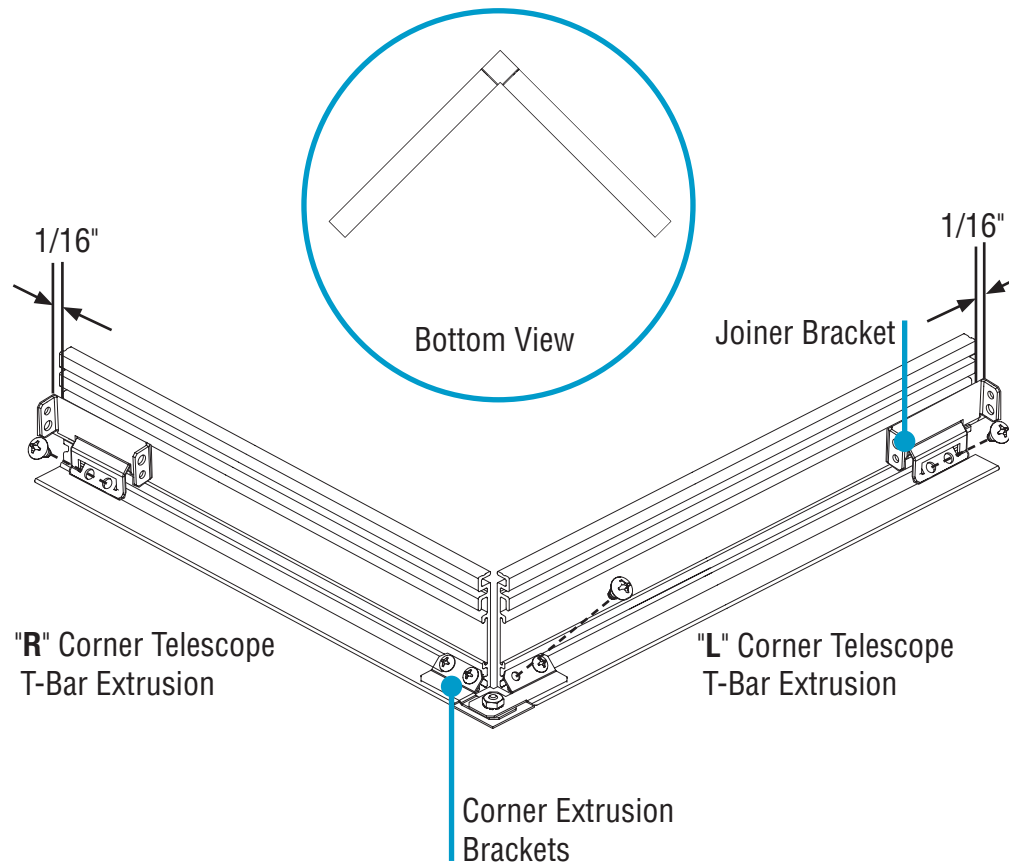

- Make sure the corner extrusion bracket is fastened to both pieces of the telescope T-Bar extrusion by lining up the bracket to the edge of the extrusion.
- Fasten using #8-18 x 1/4" screws.
- Slide the joiner bracket into the telescope T-Bar extrusion as shown.
- Pin with #8-18 x 1/4" screws.
- Make sure to leave a 1/16" gap from the extrusion joiner bracket to the end of the telescope T-Bar extrusion.

### I. Install Telescope T-Bar Extrusion Top View

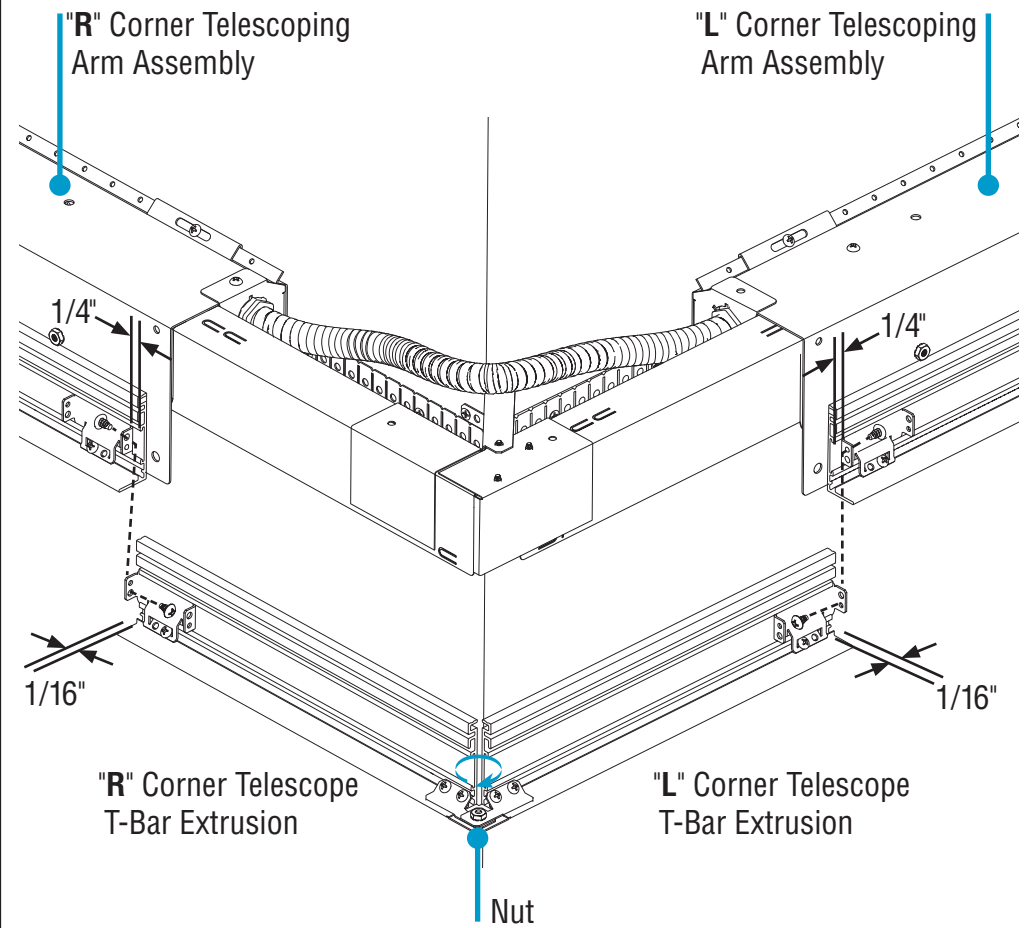

- Join the telescope T-Bar extrusions to the luminaire T-Bar extrusions by using #8-18 x 1/4" screws to pull together the adjacent extrusion joiner brackets.
- Leave a 1/16" gap between the two extrusion joiner brackets.
- Tighten nut to solidify telescope T-Bar extrusion corner joint.

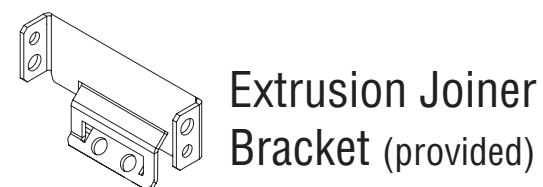
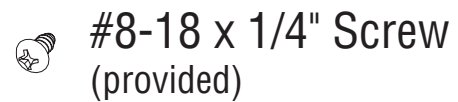

CONTINUED

# HP-WS Perimeter Slot Post-Ceiling T-Bar Installation Instructions

## Step 6B - Outside Corner

**J. Telescope Vertical Cover** Top View

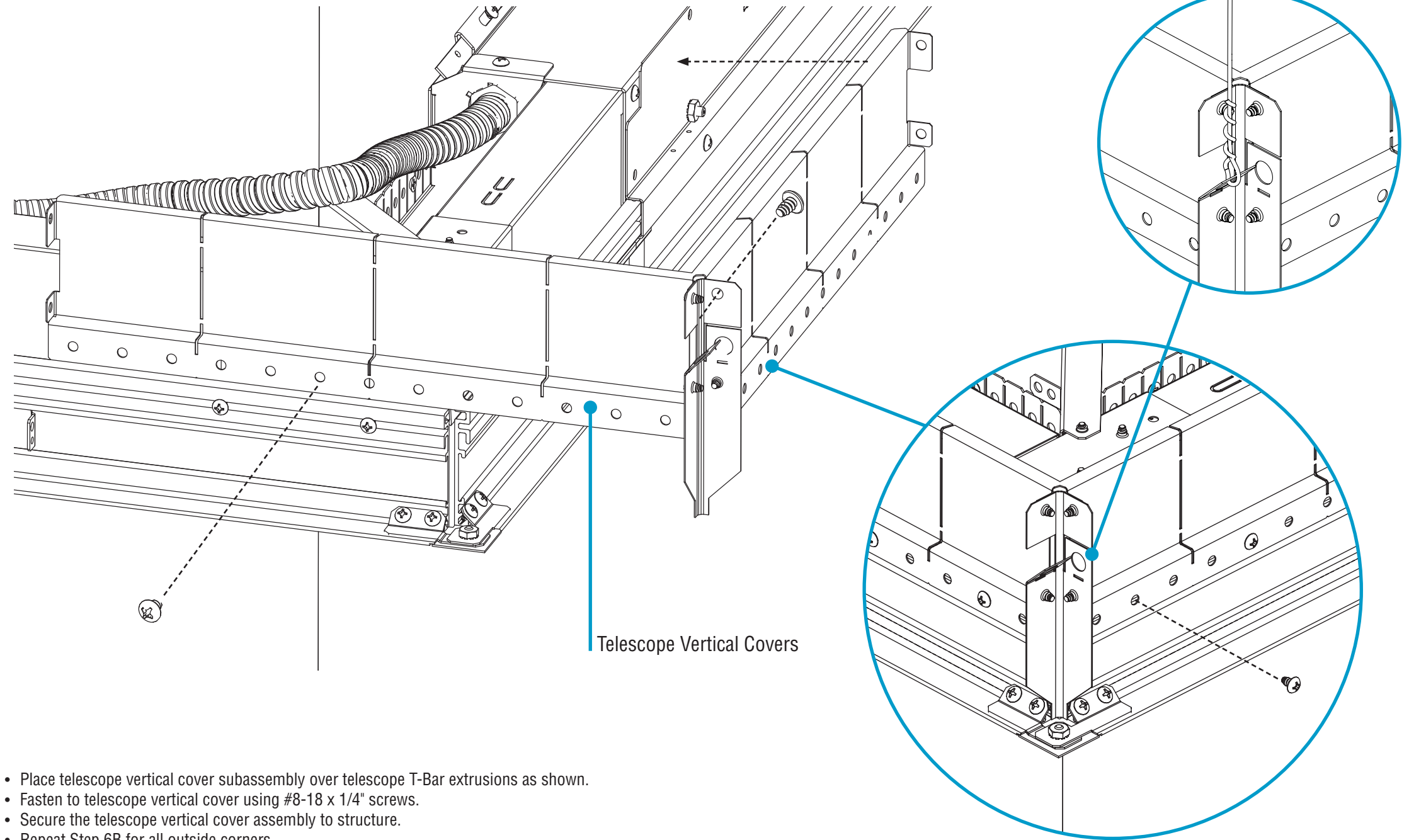
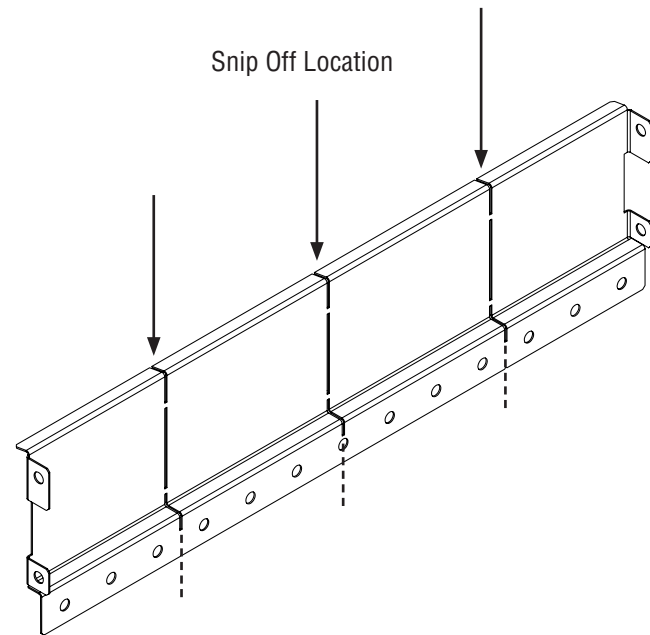

- Place telescope vertical cover subassembly over telescope T-Bar extrusions as shown.
- Fasten to telescope vertical cover using #8-18 x 1/4" screws.
- Secure the telescope vertical cover assembly to structure.
- Repeat Step 6B for all outside corners.

- If necessary, snip off perforated sections of the vertical cover.

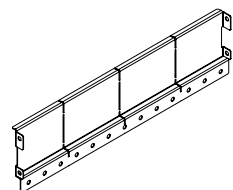

Telescope Vertical Cover (provided)



#8-18 x 1/4" Screw (provided)

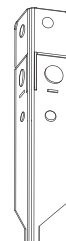

Outside Corner Cover Bracket (provided)



# HP-WS Perimeter Slot Post-Ceiling T-Bar Installation Instructions

## Step 7 - Straight Telescope

**A. Extend Straight Telescope** Bottom-Up View

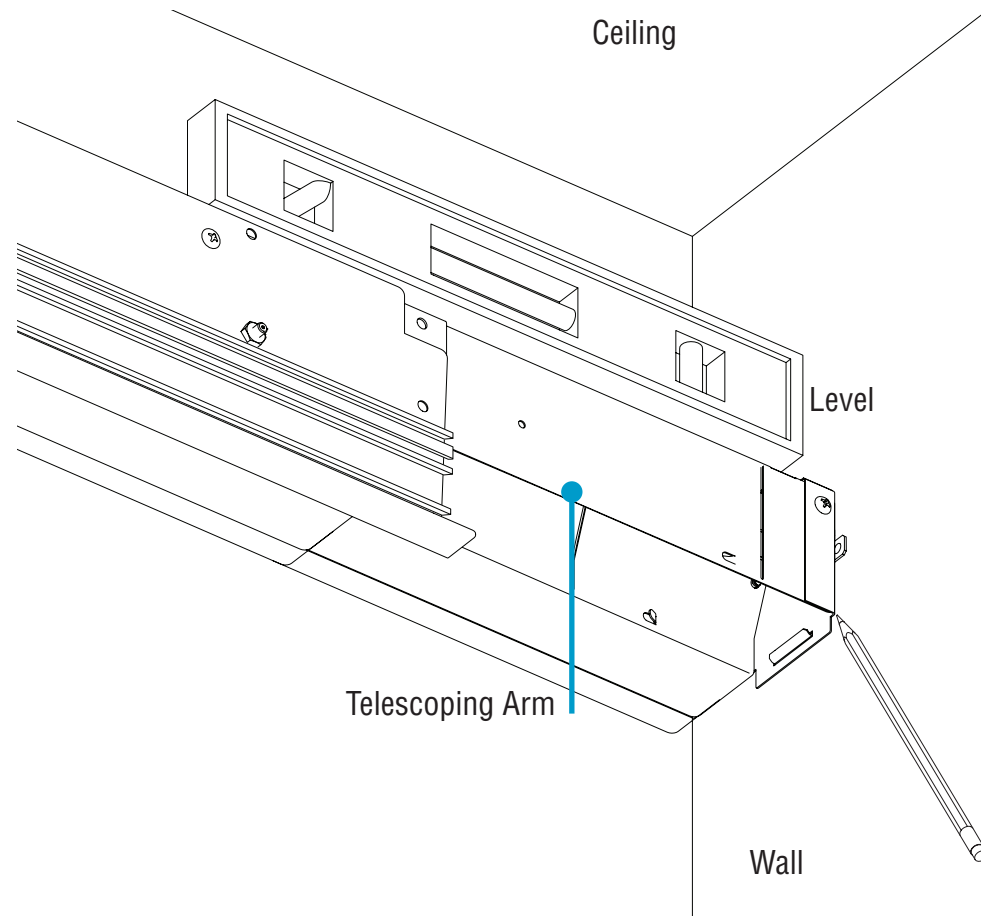

- Extend telescope arm to wall, ensuring it is level.
- Mark where the telescope wall support bracket will be mounted.

**B. Mount Support Bracket** Bottom-Up View

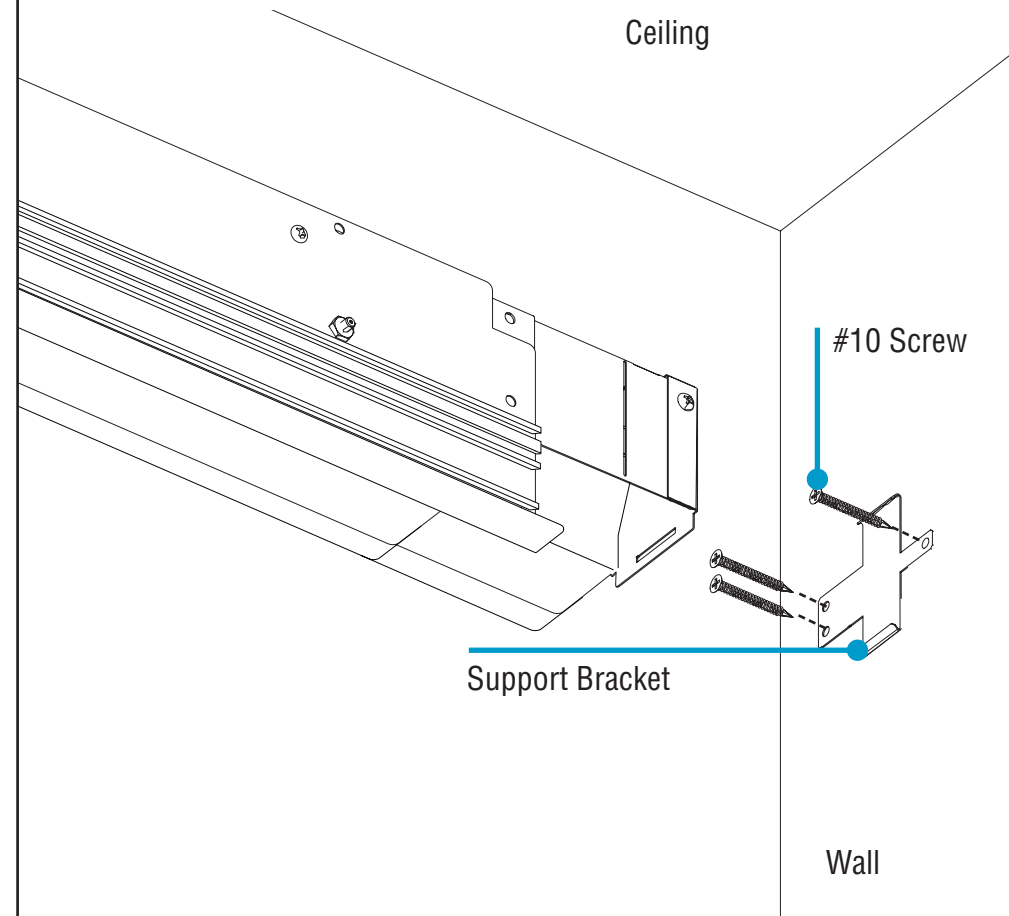

- Mount support bracket to wall using appropriate #10 screws.

**C. Hook Telescope** Bottom-Up View

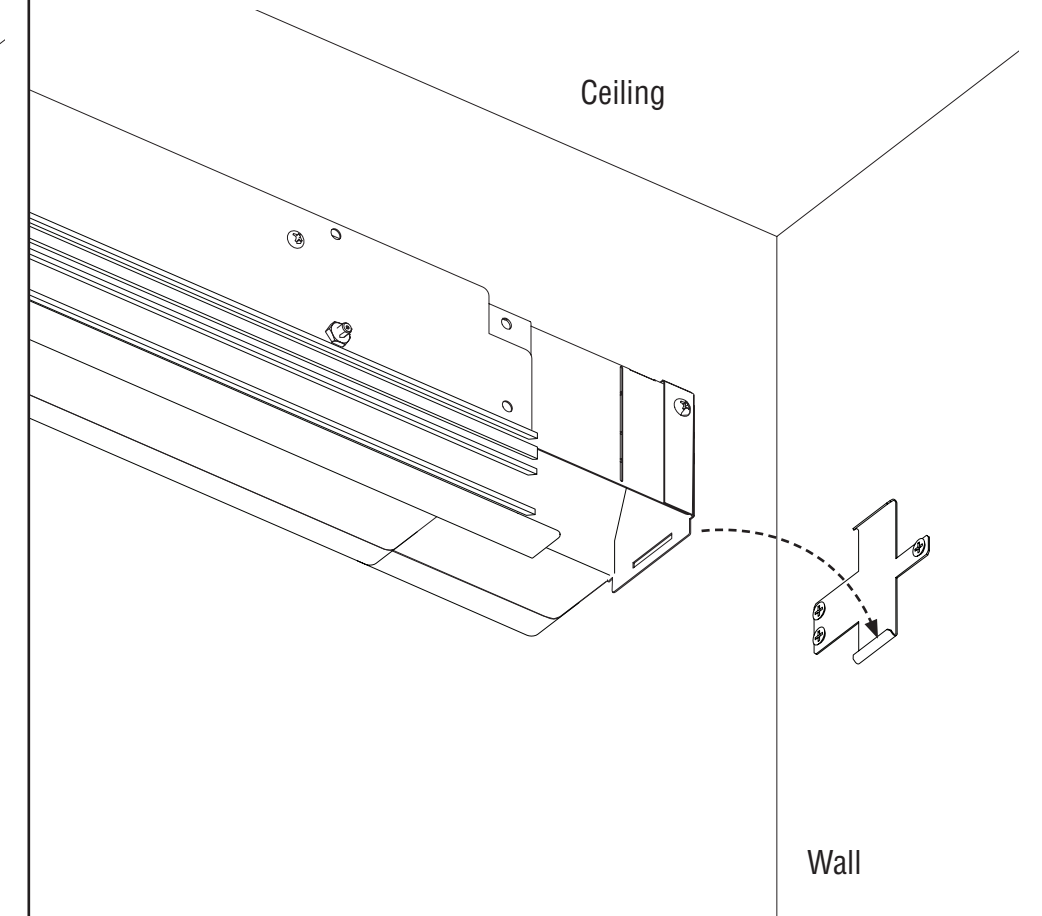

- Hook the telescope arm onto the support bracket using the slot provided.

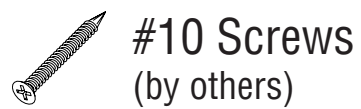

**CONTINUED**

# HP-WS Perimeter Slot Post-Ceiling T-Bar Installation Instructions

## Step 7 - Straight Telescope

### D. Cut Telescope T-Bar Extrusion Top View

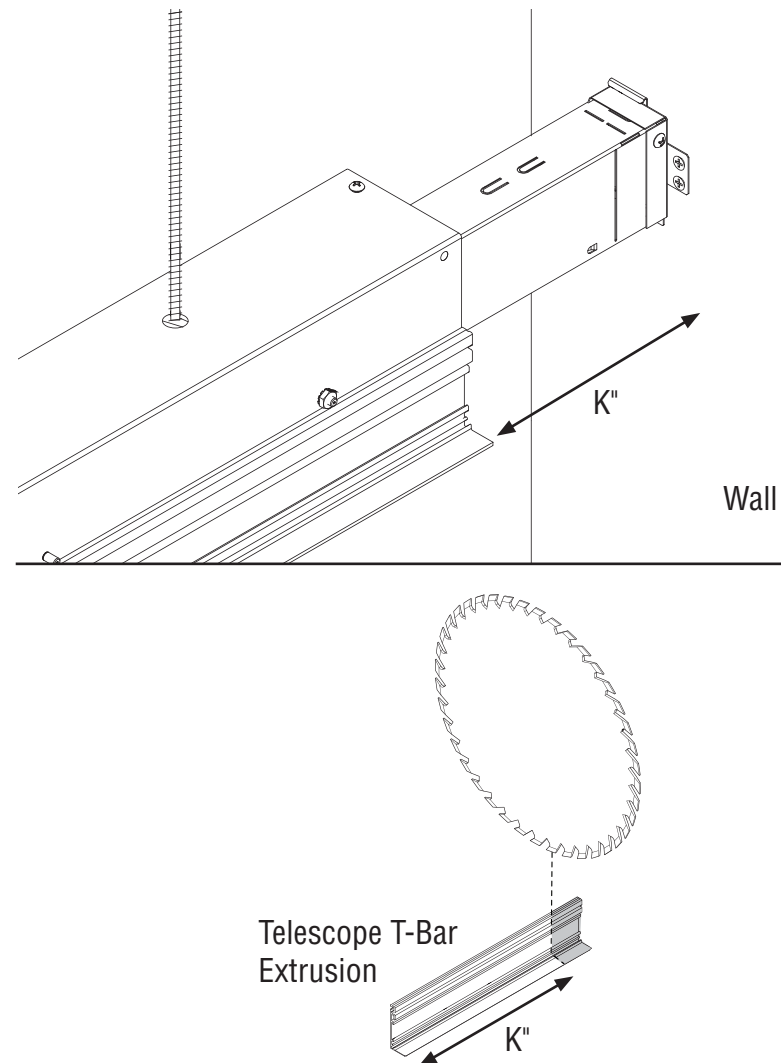

- Measure distance from extrusion to wall. Cut telescope T-Bar extrusion to **K**.

### E. Install Telescope T-Bar Extrusion Top View

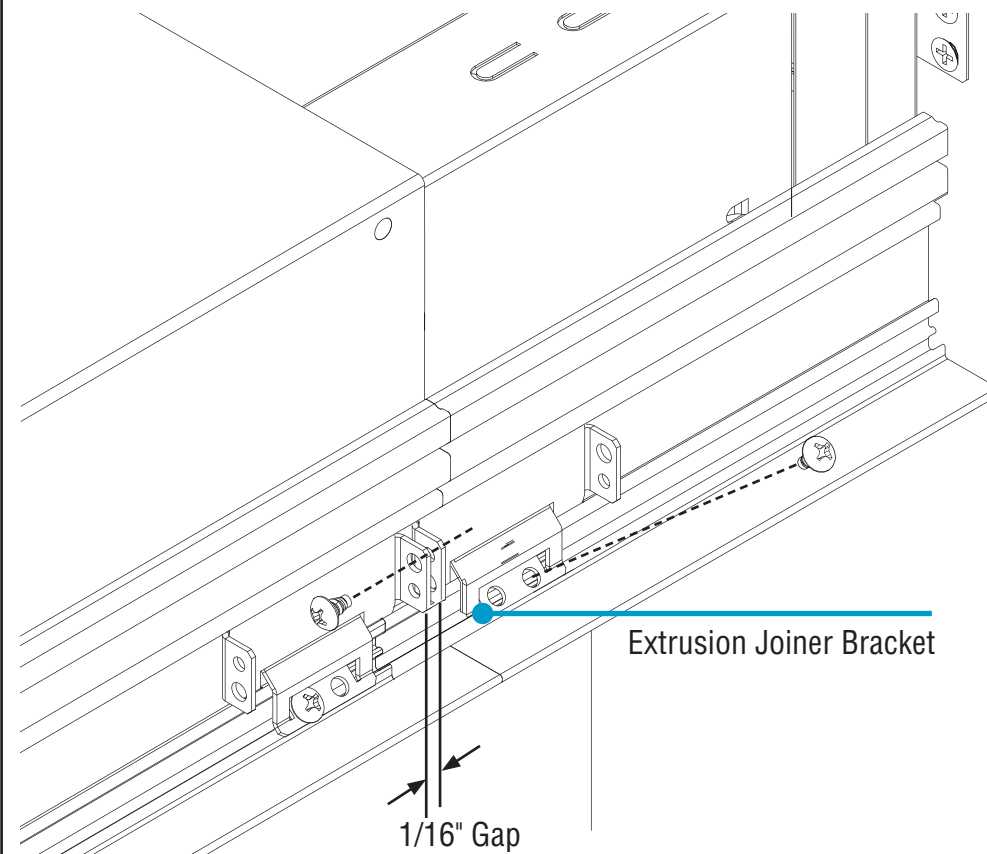

- Insert extrusion joiner bracket into telescope T-Bar extrusion.
- Attach extrusion joiner bracket to telescope T-Bar extrusion using #8-18 x 1/4" screw.
- Make sure to leave 1/16" gap between two extrusion joiner brackets.
- Mount telescope T-Bar extrusion to adjacent extrusion piece using extrusion joiner bracket and #8-18 x 1/4" screw.

### F. Install Telescope Vertical Cover Top View

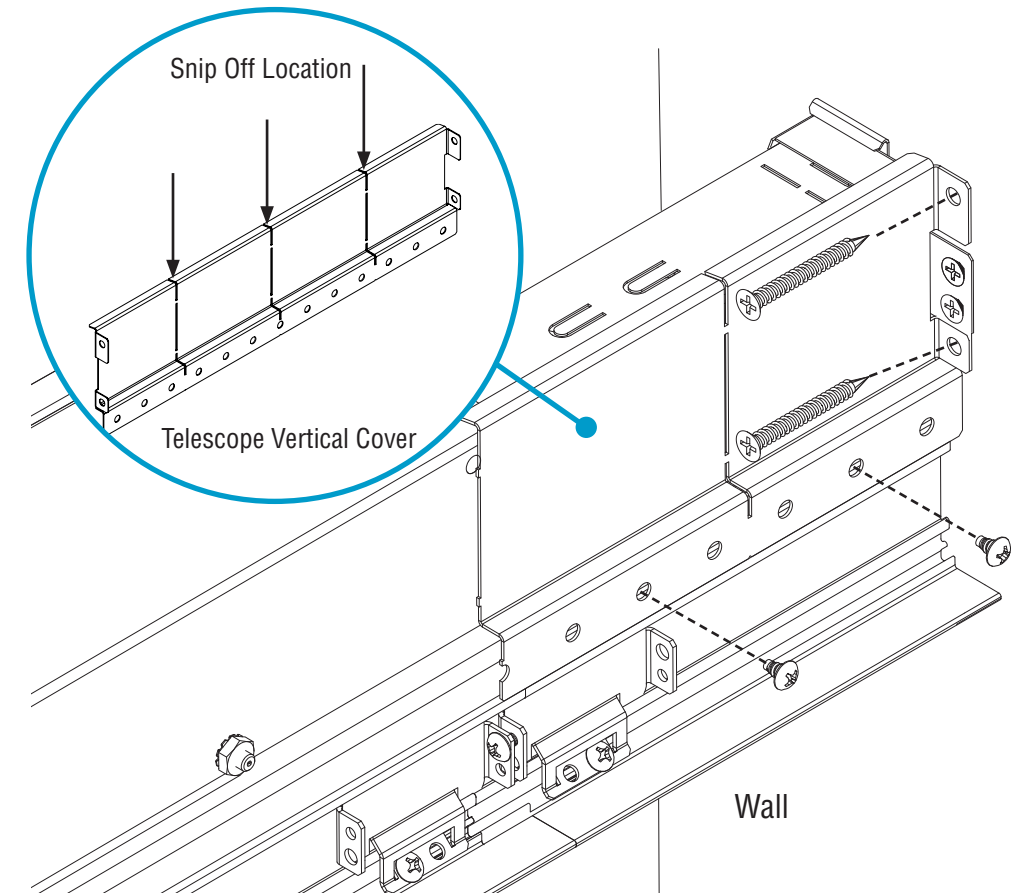

- Cut the necessary sections off of the telescope vertical cover.
- Remove enough of telescope vertical cover so it doesn't overlap nearest stud/nut.
- Tin snips are recommended to snip then break off sections as necessary.
- Fasten telescope vertical cover to telescope T-Bar extrusion using #8-18 x 1/4" screws as necessary.
- Secure to wall using appropriate #10 screws.

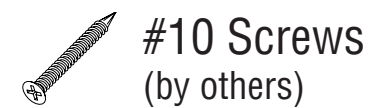
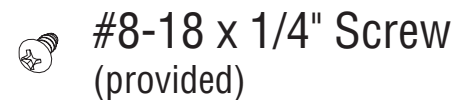

# HP-WS Perimeter Slot Post-Ceiling T-Bar Installation Instructions

## Step 8 - Closing Luminaires

### A. Connect to T-Bar Top View

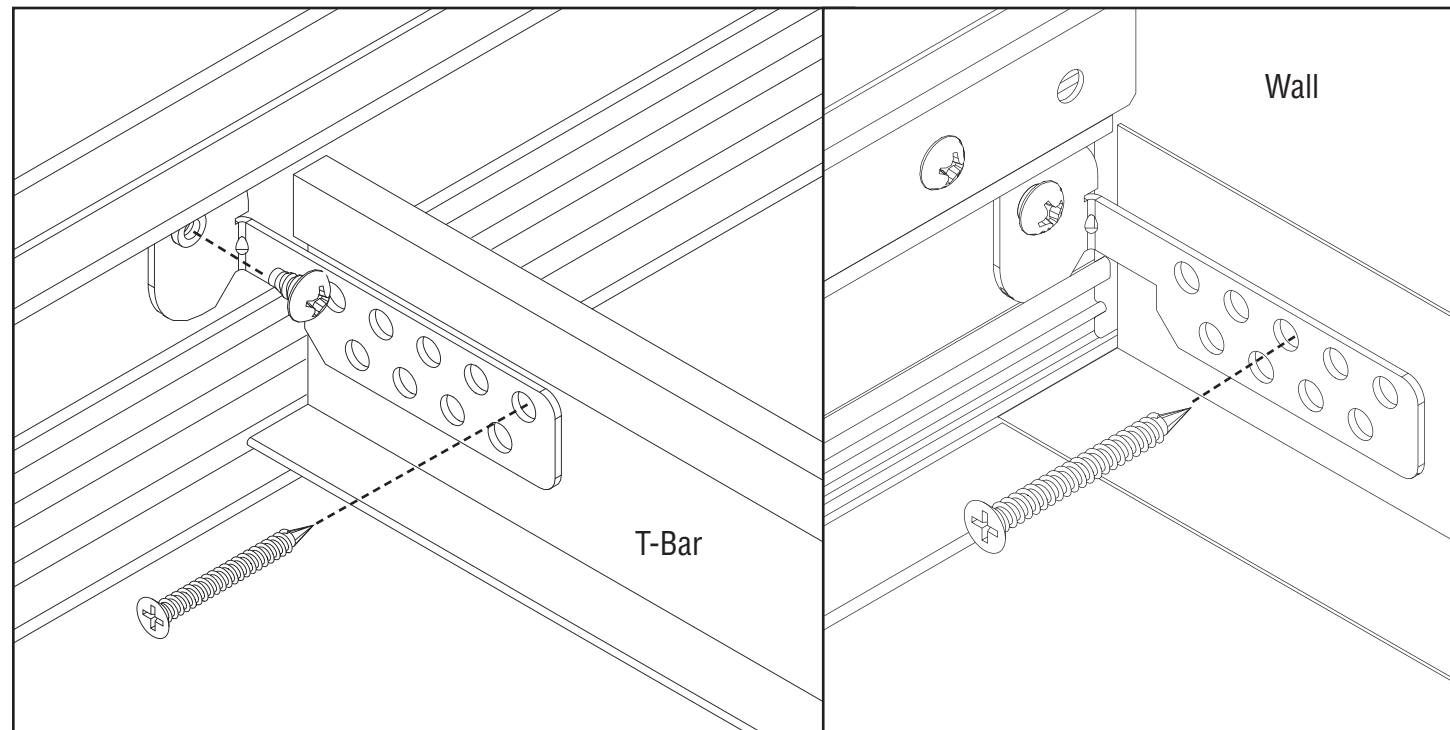
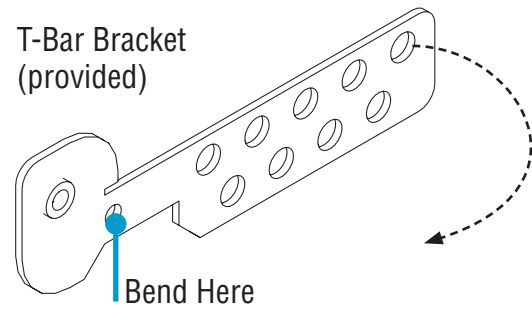

- Fasten T-Bar to T-Bar extrusion using T-Bar brackets.
- Twist brackets into extrusion and pin them to the T-Bar extrusion using #8-18 x 1/4" screws.
- Secure T-Bar to T-Bar brackets using self-drilling screws.
- For edging at the wall, use appropriate #10 screws through brackets and edging into wall (this also supports the telescope T-Bar extrusion to the wall).

### B. Measure Diffusers Bottom-Up View

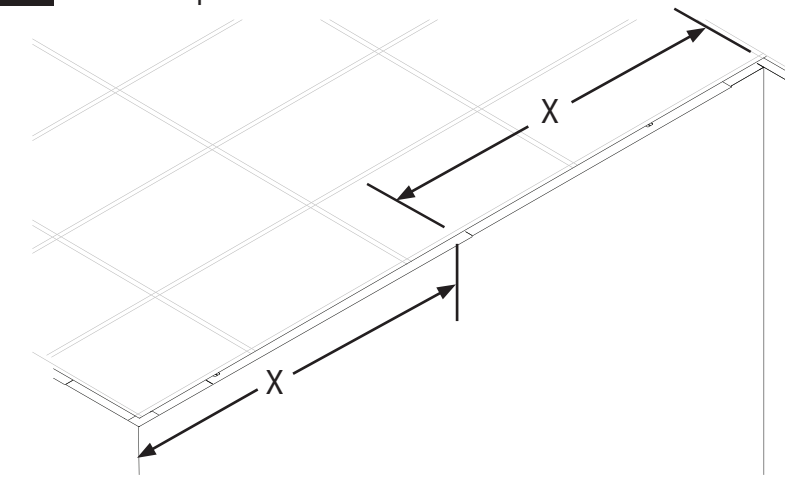

- Diffuser measurement "X" will vary.

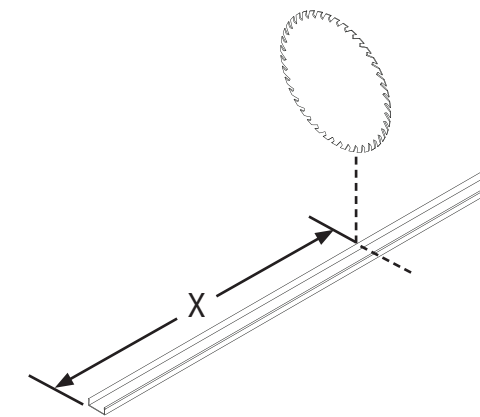

- Diffuser length **X** is always measured along the longest edge.
- Measure the overall length for square-edged lengths.
- Measure from the square edge to the tip of a mitered edge.
- Cut the diffuser to **X** minus 1/16". For example, if **X** is 8'6", cut the diffuser to 8' 5-15/16".
- This difference accounts for thermal expansion and helps to avoid light leaks.
- Diffusers should be cut at room temperature between 70°F and 73°F.
- Contact the factory if cutting at a temperature outside that range.

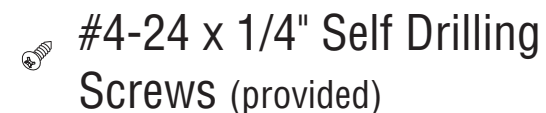
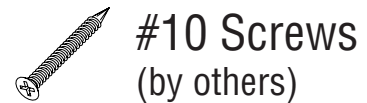
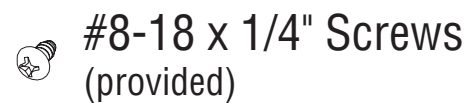

CONTINUED

# HP-WS Perimeter Slot Post-Ceiling T-Bar Installation Instructions

## Step 8 - Closing Luminaires

**C. Replace Diffusers** Side View

4W Only

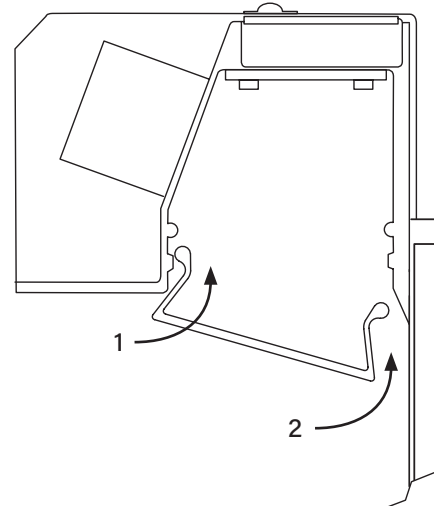

6W Only

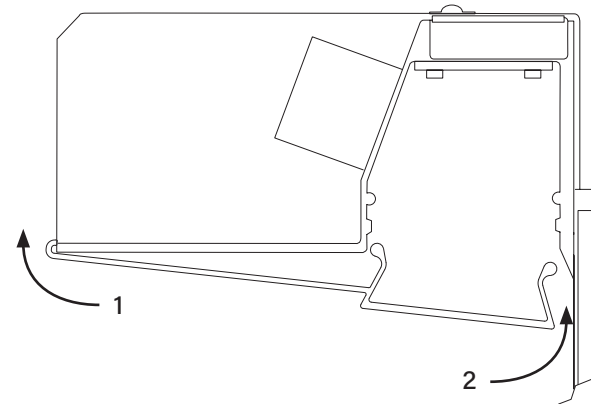

- Replace diffusers

**Install Tapered Optic to Inside Corner** Bottom-Up View

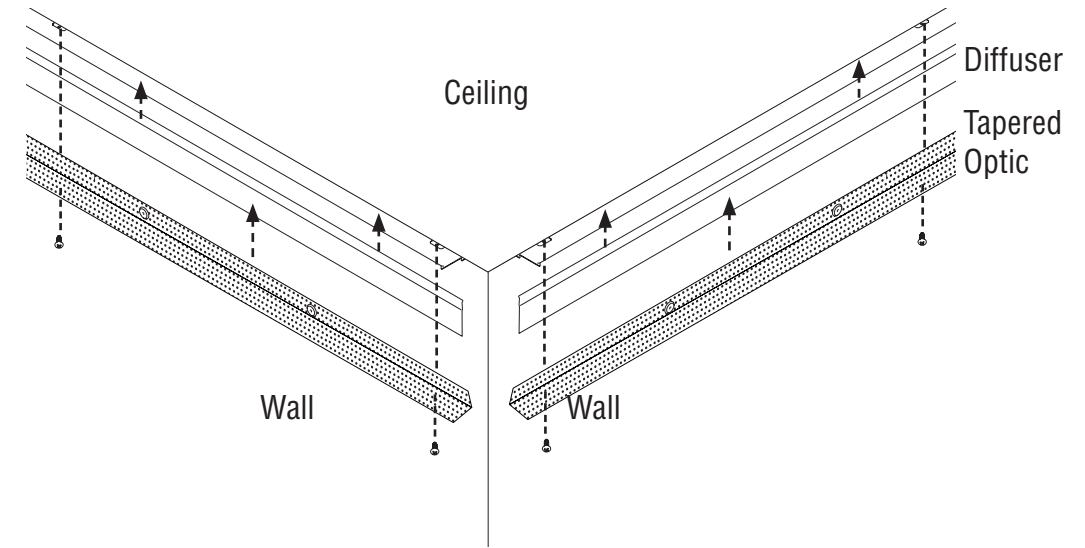

Bottom-Up View

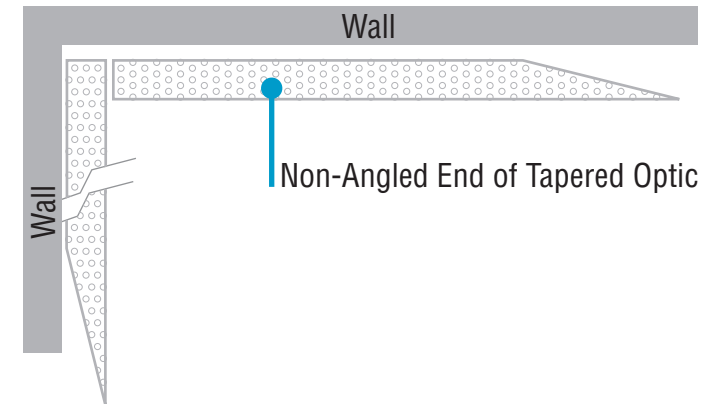

**For Inside Corner Only**

- Install diffusers and tapered optics using #4-24 x 1/4" screws at inside corner
- Non-angled end of tapered optic to be placed at ends of luminaire closest to perpendicular wall.
- Turn power on to luminaire.