

**FINELITE®**  
*Better Lighting*



# High Performance Recessed Collection

## HPR LED Luminaires

Project: Burlington Coat Factory HQ • Architect: KSS Architects • Burlington, NJ





Project: Microsoft, WA  
Architect: ZGF Architects LLP  
Location: Redmond, WA



# High Performance Recessed LED

HPR LED delivers outstanding performance in a refined and flexible format. Available in a variety of styles, sizes and outputs, this recessed luminaire rises to meet most challenges.

## Tailored Output

- Static White options: Standard (**S**), Boosted Standard (**B**), High (**H**), and Very High (**V**)
- Tunable White options: Boosted Standard (**B**) and Very High (**V**)

## Tailored Color

- Static White options at 3000K, 3500K and 4000K CCT
- Tunable White option for two-source Tunable White light between 2700K and 6500K CCT
- 80+ and 90+ CRI options available

## Tailored Control

- Dimming from 100% to 10%, standard; 1% available
- Industry-leading pre-qualified drivers and controls options available
- Integrated or networked daylight and occupancy sensors options available
- Simplified white light color tuning design and installation with the FineTune™ controls system

## Flexible

LED and fluorescent light engines, mounting, and diffuser options.

## Serviceable

Drop-down doors and quick-connects for drivers and light engines simplify repairs.

## Declare 2.0

This product is enrolled in the International Living Future Institute (ILFI) Declare 2.0 Program and is third-party verified.

Declare.







# Wave Door

The undulating curves of Wave (WAV) provide an organic look and solid performance.

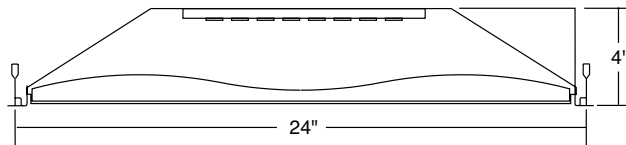

## Available Sizes



2x2

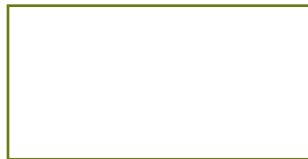

2x4

- CCT** 3000K, 3500K, 4000K, or Tunable White (2700K – 6500K)
- CRI** 80+ (standard) or 90+
- Output** 3470 to 7069 total lumens
- Efficacy** 113 to 142 LPW





# Curved Slotted Door

The perforated sides of the center optic give the Curved Slotted (CS) door a subtle glow.

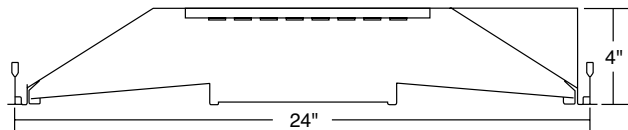

## Available Sizes



1x4



2x2

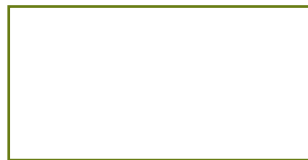

2x4

**CCT** 3000K, 3500K, 4000K, or Tunable White (2700K – 6500K)

**CRI** 80+ (standard) or 90+

**Output** 3236 to 6602 total lumens

**Efficacy** 112 to 132 LPW

## Additional Options

- Enhanced Performance (EP)
- Fluorescent







# Double Diffusing Door

The Double Diffusing (DD) door presents a clean ceiling line with a flat panel aesthetic.

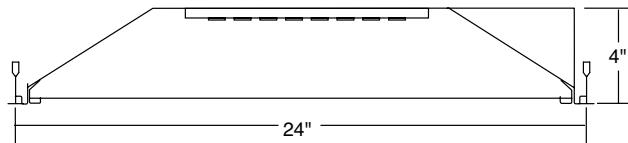

## Available Sizes



1x1



1x2



1x4



2x2

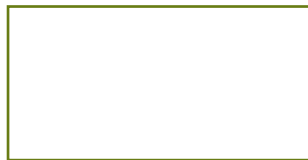

2x4

**CCT** 3000K, 3500K, 4000K, or Tunable White (2700K – 6500K)

**CRI** 80+ (standard) or 90+

**Output** 1489 to 5691 total lumens

**Efficacy** 93 to 114 LPW

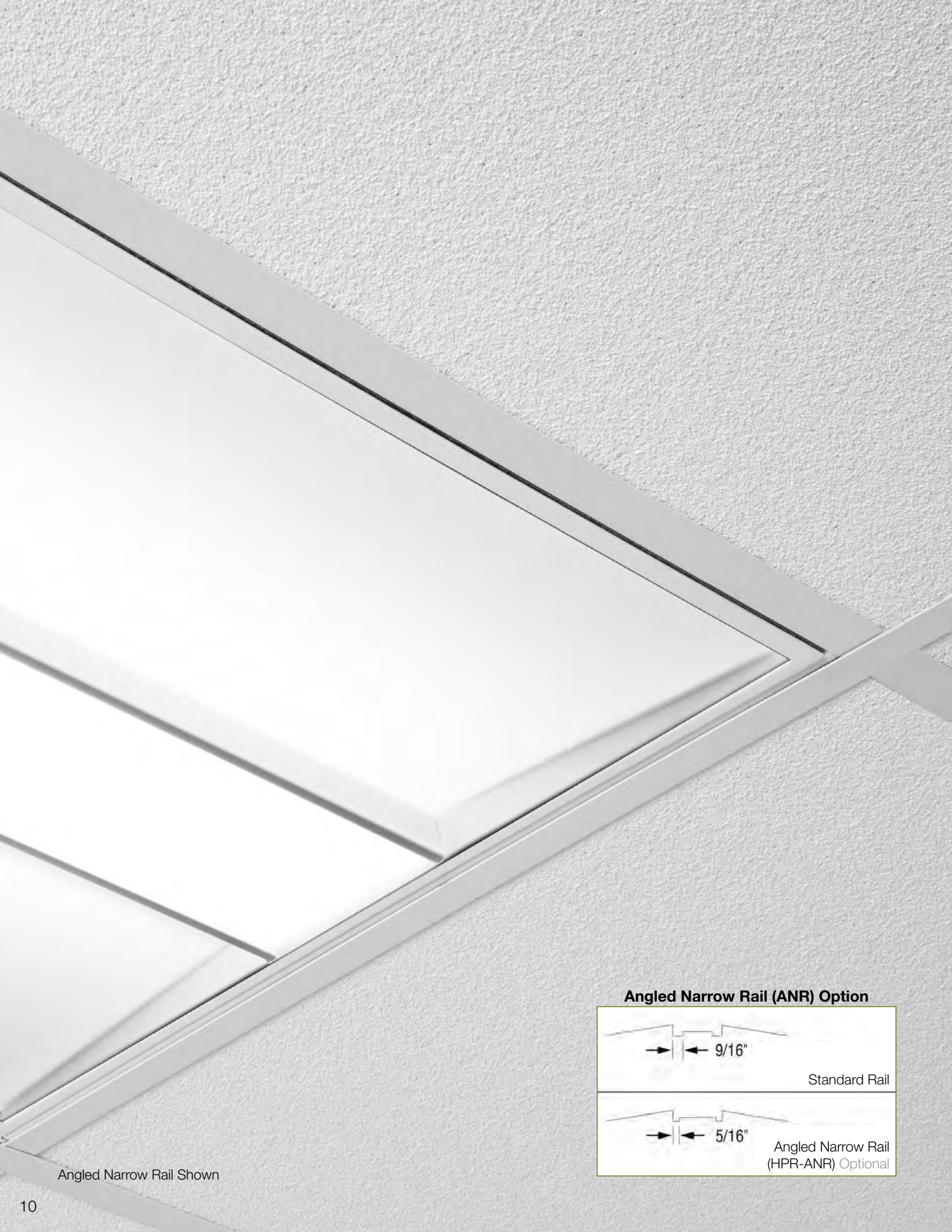

**Angled Narrow Rail (ANR) Option**

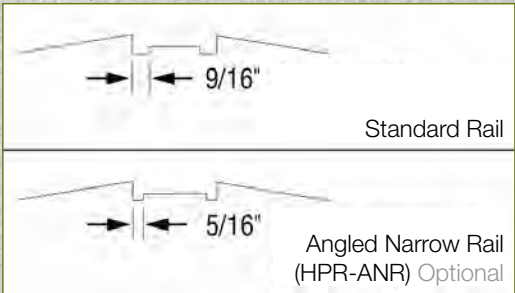

Angled Narrow Rail Shown



# Angled & Flat Door

HPR with the Angled (A) and Flat (F) doors offers a variety of center optic options.

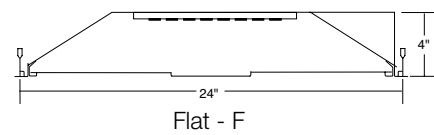
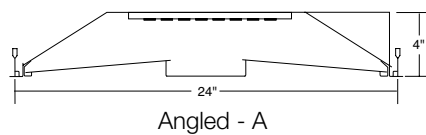

## Available Sizes



1x1



1x2



1x4



2x2

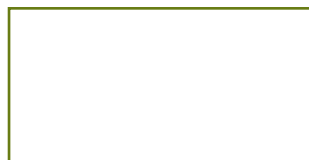

2x4

**CCT** 3000K, 3500K, 4000K, or Tunable White (2700K – 6500K)

**CRI** 80+ (standard) or 90+

**Output** 1489 to 6979 total lumens

**Efficacy** 93 to 140 LPW

## Additional Options

- Enhanced Performance (EP)
- Angled Narrow Rail
- Diffuse, Slotted and Round Center Optics
- Fluorescent



# HPW

The High Performance Wall (HPW, HPW LED) is a recessed, asymmetric wall wash that delivers uniform vertical illumination.

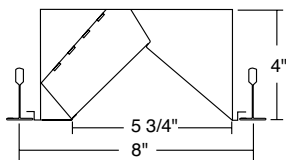

## Available Sizes

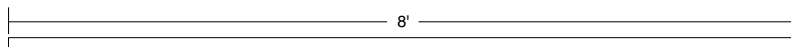
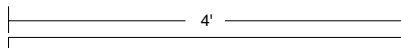
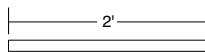

**CCT** 3000K, 3500K, 4000K, or Tunable White (2700K – 6500K)

**CRI** 80+ (standard) or 90+

**Output** 800 to 7812 total lumens

**Efficacy** 106 to 109 LPW

## Additional Options

- Fluorescent



Daylight Sensor



Occupancy Sensor

# Integrated Sensors

The High Performance Recessed (HPR, HPR LED) Static White and Fluorescent collections accommodate daylight and occupancy sensors in the luminaire's center optic. Tunable White luminaires using the FineTune™ controls system have simple plug-and-play integration with area sensors. The daylight sensor and controls provide continuous dimming within a controlled zone.



## Integrated Daylight Sensor

- Measures the combined light levels of the daylight and electric light
- Dims the light based on available daylight
- 3000K, 3500K, or 4000K
- Low voltage 0-10V control wires



## Integrated Occupancy Sensor

- Multi-cell, multi-tier Fresnel lens with a 360° view
- Detects small motions when mounted within 8' of occupants
- 14' diameter range
- Low voltage 0-10V control wires

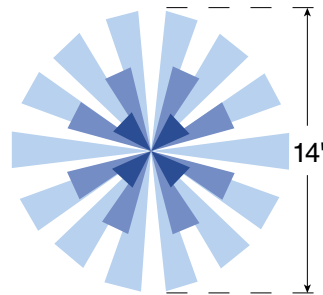
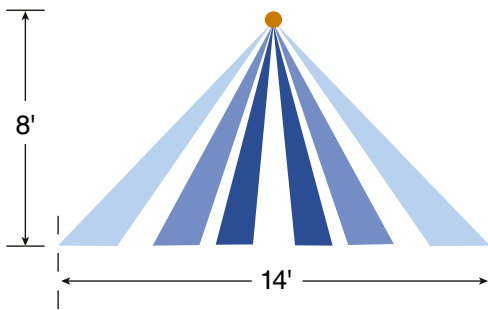

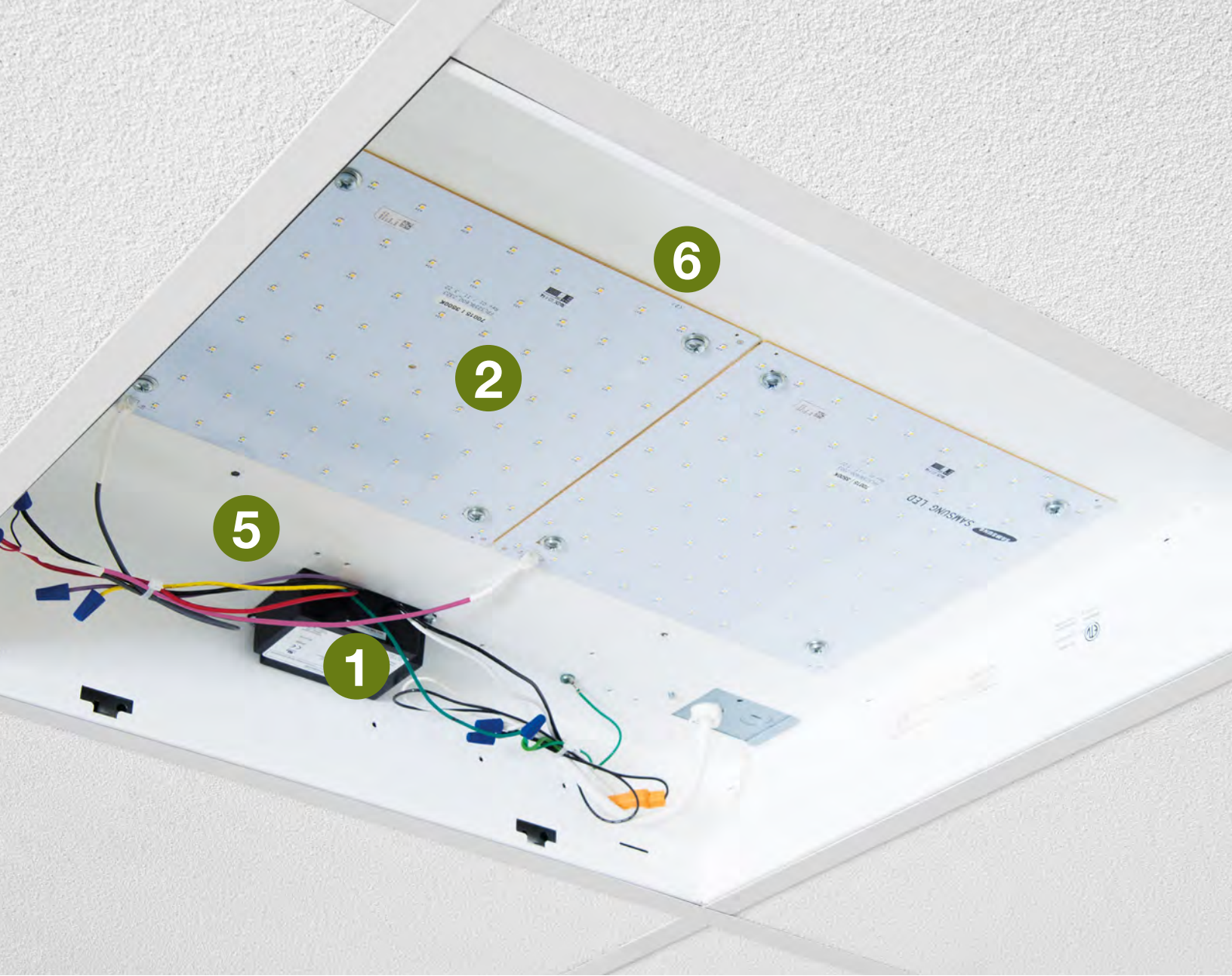

# Anatomy of a **100,000+** Hour Luminaire

## ① Cool Running LED Driver

Often, the driver is the weak link in the LED luminaire. Using mid-power LEDs run at a low current keeps driver case temperatures below 55°C. This results in LED drivers that easily last 100,000+ hours.

## ② Mid-Power LEDs

Like the driver, mid-power LEDs are run at low current, keeping them cool and resulting in lifetimes of at least 100,000 hours.

## ③ Plush Pile Gaskets

Standard rubber gaskets do not stand up to the long life time of Finelite LED luminaires. We use plush pile gaskets that do not breakdown over time.

## ④ Diffusers

Acrylic diffusers paired with LEDs that do not emit UV radiation means there will be no yellowing or cracking and diffusers will easily last more than 100,000 hours.

## ⑤ Durable Powder Coat

Finitelite luminaires are finished with a robust powder coat finish that can withstand many years of occasional cleaning.

## ⑥ Serviceable

Sometimes things break. The HPR collection has replaceable LED arrays, drivers, even doors. With a unique ID# inside every luminaire, parts are easy to order and easy to install.



Project: Public Utility Company  
Architect: IA Interior Architects  
Location: CA



# Application Guide

The High Performance Recessed collection is ideal for illuminating any interior application.

	2x2			2x4		
Luminaire Spacing	Light Level (fc)	LPD (w/ft <sup>2</sup> )	Tailored Level*	Light Level (fc)	LPD (w/ft <sup>2</sup> )	Tailored Level*
8'x8'	39.3	0.34	50%	34.0	0.25	40%
8'x10'	48.8	0.41	75%	31.6	0.24	45%
10'x10'	40.8	0.35	75%	44.3	0.33	75%
10'x12'	46.6	0.40	100%	37.9	0.28	75%

\* Represents % of maximum output.

Ceiling Height: 9'0"

2x2 - High Output, 80+ CRI, 3500K

2x4 - High Output, 80+ CRI, 3500K

Reflectance: 80/50/20

Light levels are initial

Based on Angled door with DCO center optic

# Collection At A Glance

Center Optics (DCO/SCO/RCO)							Lens: Open or Frosted
Sizes	Angled Door	ANR Door	Flat Door	CS Door	DD Door	WAVE Door	HPW
2x4	•	•	•	•	•	•	
2x2	•	•	•	•	•	•	
1x4	•	•	•	•	•		
1x2	•	•	•		•		
1x1	•		•		•		
<b>Light Engine</b>							
LED	•	•	•	•	•	•	•
1, 2T8/2T5/T5HO	•	•	•	•			1 Lamp Only
3T8/T5/T5HO	•	•	•	•			
1FT40/50/55W	2x2 Only	2x2 Only	2x2 Only	2x2 Only			
2FT40/50/55W	2x2 Only	2x2 Only	2x2 Only	2x2 Only			
<b>Mounting</b>							
Surface Mount*	•	•	•	•	•	•	
Grid Ceiling	•	•	•	•	•	•	•
Drywall Kit	•	•	•	•	•	•	•
Pendant*	•	•	•	•	•	•	•
<b>Special Features</b>							
Enhanced Performance (EP)	•	•	•	•			
DLC Qualified	2x4, 2x2, 1x4		2x4, 2x2, 1x4				
Air Return	2x4, 2x2, 1x4		2x4, 2x2, 1x4				
Integrated Sensors	2x4, 2x2, 1x4, 1x2	•	2x4, 2x2, 1x4, 1x2	•		•	
ICLS Compatibility	•	•	•	•	•	•	•
Master/Satellite**	•	•	•	•	•	•	•
Tunable White	•	•	•	•	•	•	•
IC Rated	•	•	•	•	•	•	•

\* Not compatible with 1x1 or HPW. Not IC rated.

\*\* Not available with 1x1

# Door Styles & Optics

## Door Styles



A - Angled  
ANR - Angled Narrow Rail



F - Flat



WAV - Wave

## Door Styles



CS - Curved Slotted

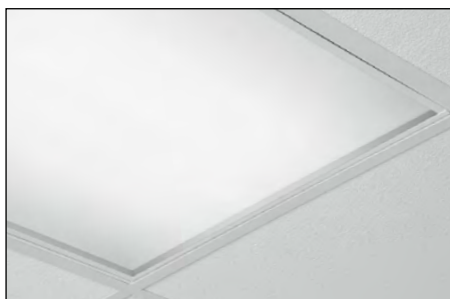

DD - Double Diffuse

## Optics



DCO - Diffuse Center



SCO - Slotted Center

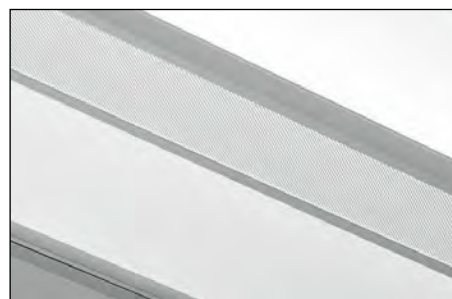

RCO - Round Center

DCO, SCO, and RCO only available on Angled (A), Angled Narrow Rail (ANR), and Flat (F) doors.

# Performance

	<b>(S) Lumen Output - 3500K, 80 CRI</b>					
	<b>2x2 Standard Output (S)</b>			<b>2x4 High Output (H)</b>		
	Lumens	Watts	Efficacy (lpw)	Lumens	Watts	Efficacy (lpw)
<b>HPR - F/A - DCO</b>	3397	28.5	119	5416	40.6	133
<b>HPR - ANR - DCO</b>	3276	28.6	115	5283	40.5	130
<b>HPR - WAV</b>	3470	28.5	122	5486	40.6	135
<b>HPR - CS</b>	3236	28.5	114	5124	40.6	126
<b>HPR - DD</b>	2720	28.5	95	4417	40.6	109

	<b>EP Standard Angled Rail Lumen Output - 3500K, 80 CRI</b>					
	<b>2x2 Standard Output (S)</b>			<b>2x4 High Output (H)</b>		
	Lumens	Watts	Efficacy (lpw)	Lumens	Watts	Efficacy (lpw)
<b>HPR - F/A - DCO</b>	3099	28.5	109	5501	40.6	123
<b>HPR - ANR - DCO</b>	3059	28.6	107	5238	40.7	129

## Enhanced Performance (EP)

HPR LED-EP available in Angled (A), Angled Narrow Rail (ANR), and Flat (F) luminaire style. HPR LED-EP features excellent performance, long life and an optical design that delivers twice the luminance uniformity of standard products.



Project: Microsoft, WA  
Architect: ZGF Architects LLP  
Location: Redmond, WA

# **FINELITE<sup>®</sup>**

---

## *Better Lighting*

### The Finelite LED Difference



10-year performance-based warranty



90% of initial light output at 100,000+ hours



Dimming standard



Replaceable LED light arrays

### Finelite Commitment To You



Ships in 10 working days for standard orders



Focus on sustainability