

H04 Driver Replacement Installation Instructions

Overview

NOTES

- Ensure that reflectors do not get dirty or damaged.
- All power connections should be installed according to local/national codes by a Certified Electrician.



HELPFUL
VIDEOS



0-10V
Dimming



Reflector
Installation

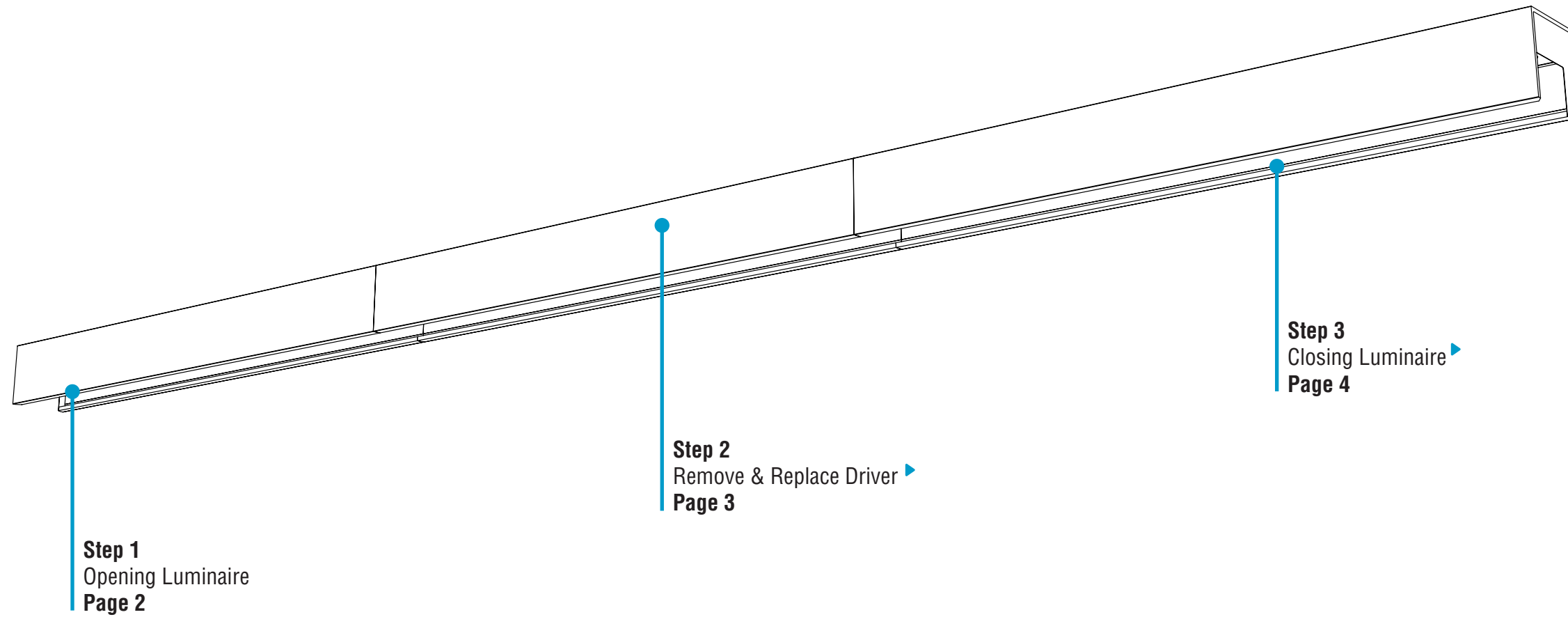

H04 Driver Replacement Installation Instructions

Step 1 - Opening Luminaire

A. Remove Reflector

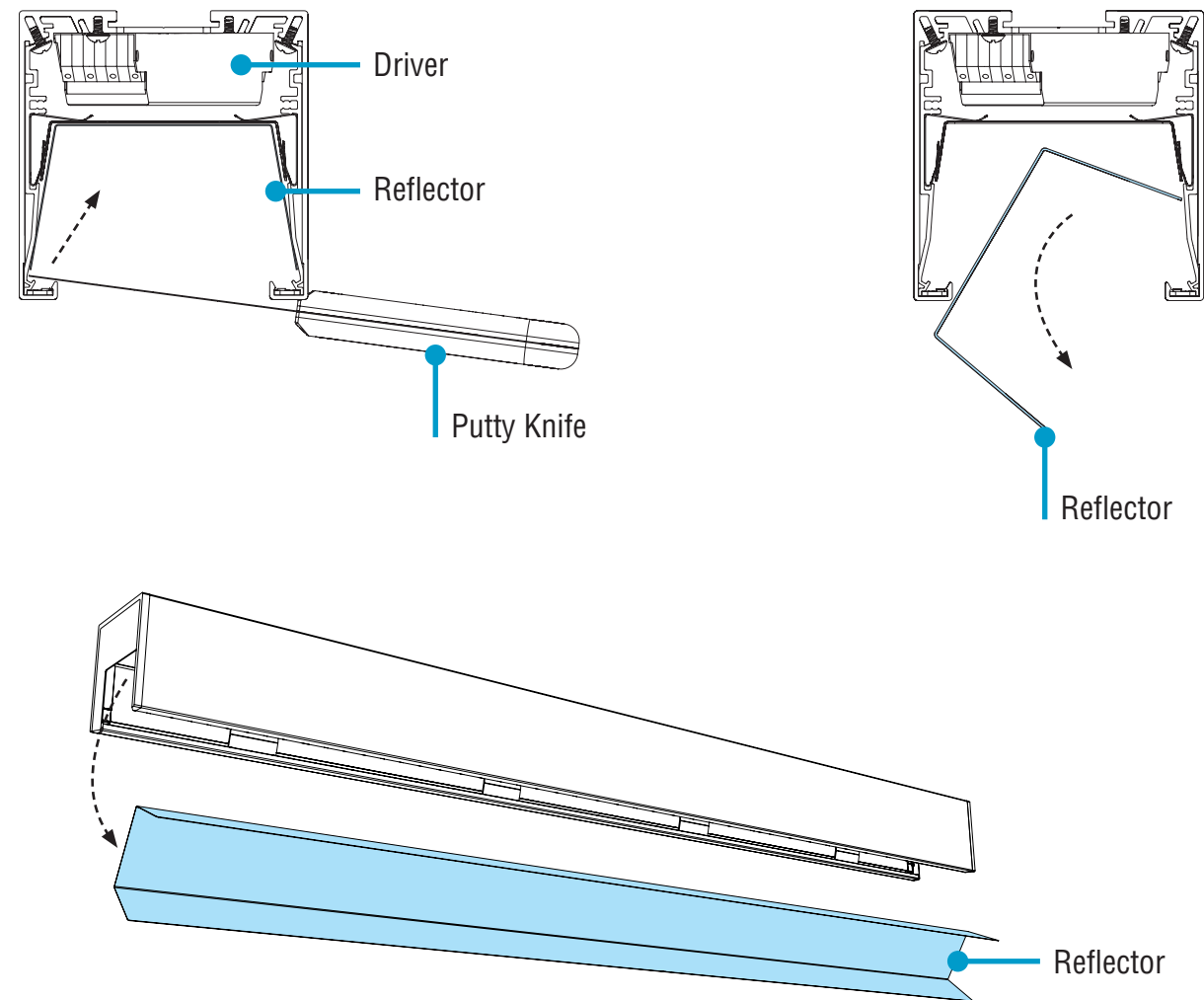

- Turn power off to luminaire.
- **CAUTION:** Wear gloves to keep reflector surface clean.
- Remove reflector by carefully placing a flat edge (such as a clean putty knife) between the reflector and luminaire body.
- Push slightly up, and angle out.

B. Remove Backplate

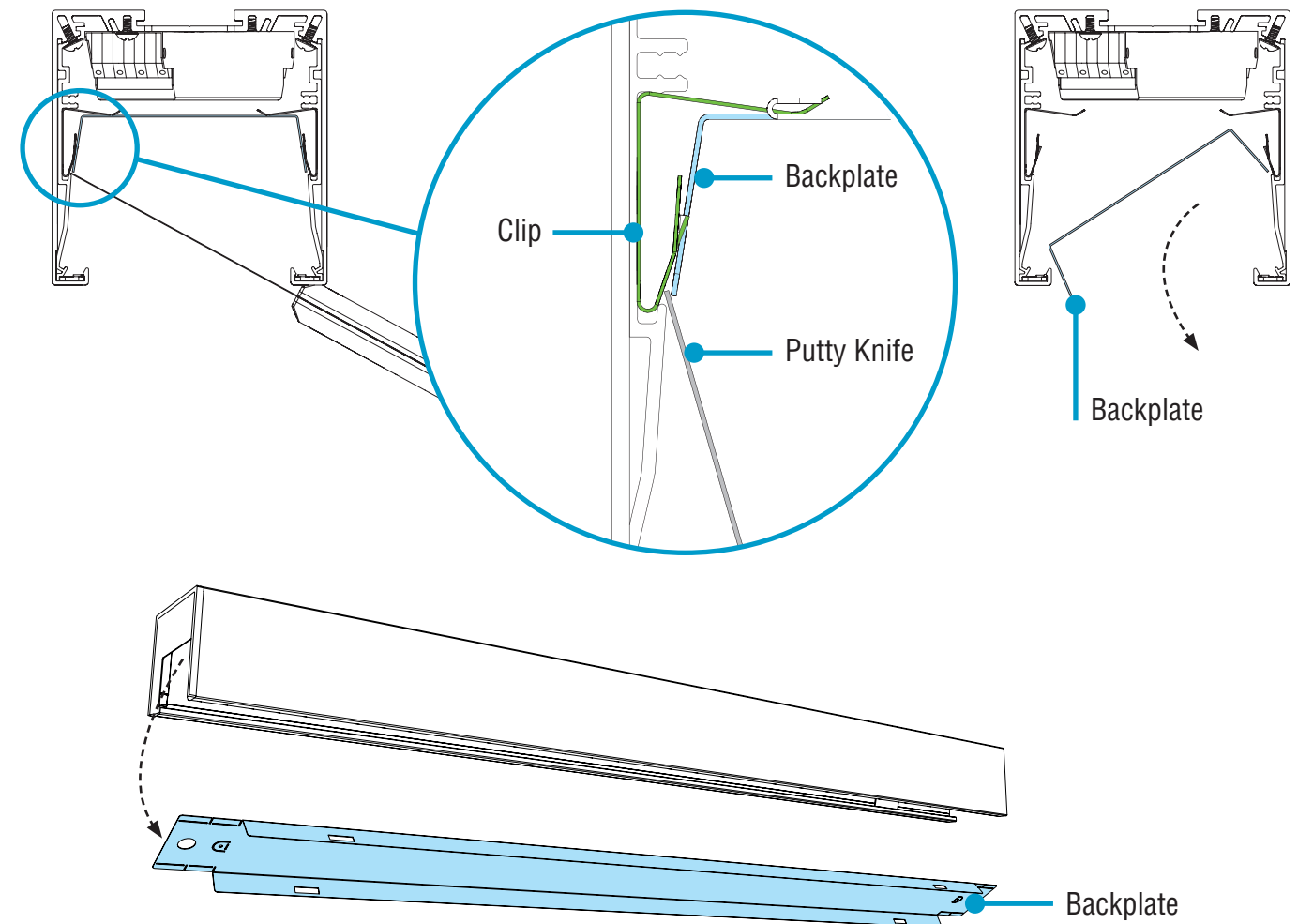

- Use putty knife to slip behind backplate edges and release backplates from clips (4 clips per backplate).

H04 Driver Replacement Installation Instructions

Step 2 - Remove & Replace Driver

Remove & Replace Driver

Standard

WIRING LEGEND		
Black	Hot	Line Voltage
White	Neutral	Line Voltage
Green	Ground	
Pink	Dimming	0-10V DC
Purple	Dimming	0-10V DC

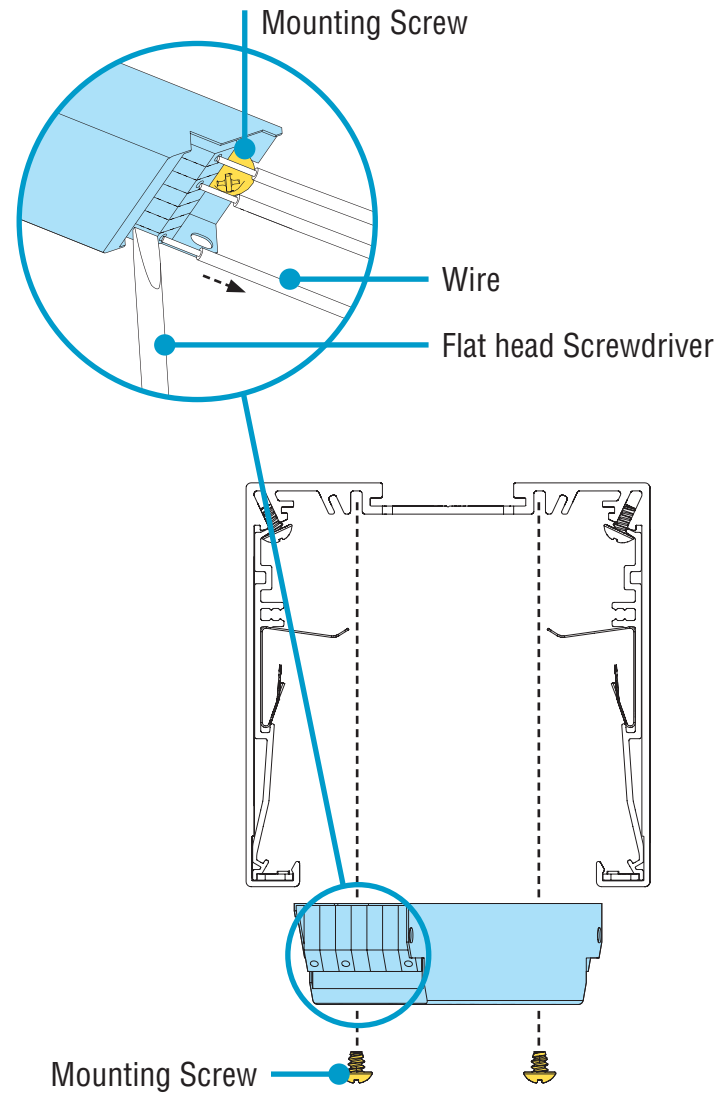

- Disconnect electrical connections from driver.
- Release driver from luminaire body by removing mounting screws.
- Remove old driver and replace with new driver.
- Replace mounting screws.
- Reconnect electrical connections to driver.

 **Mounting Screws**
#8-18 x 1/4"

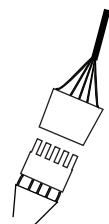

Driver Harness
Part # 15501

Mitered Corner

WIRING LEGEND		
Black	Hot	Line Voltage
White	Neutral	Line Voltage
Green	Ground	
Pink	Dimming	0-10V DC
Purple	Dimming	0-10V DC

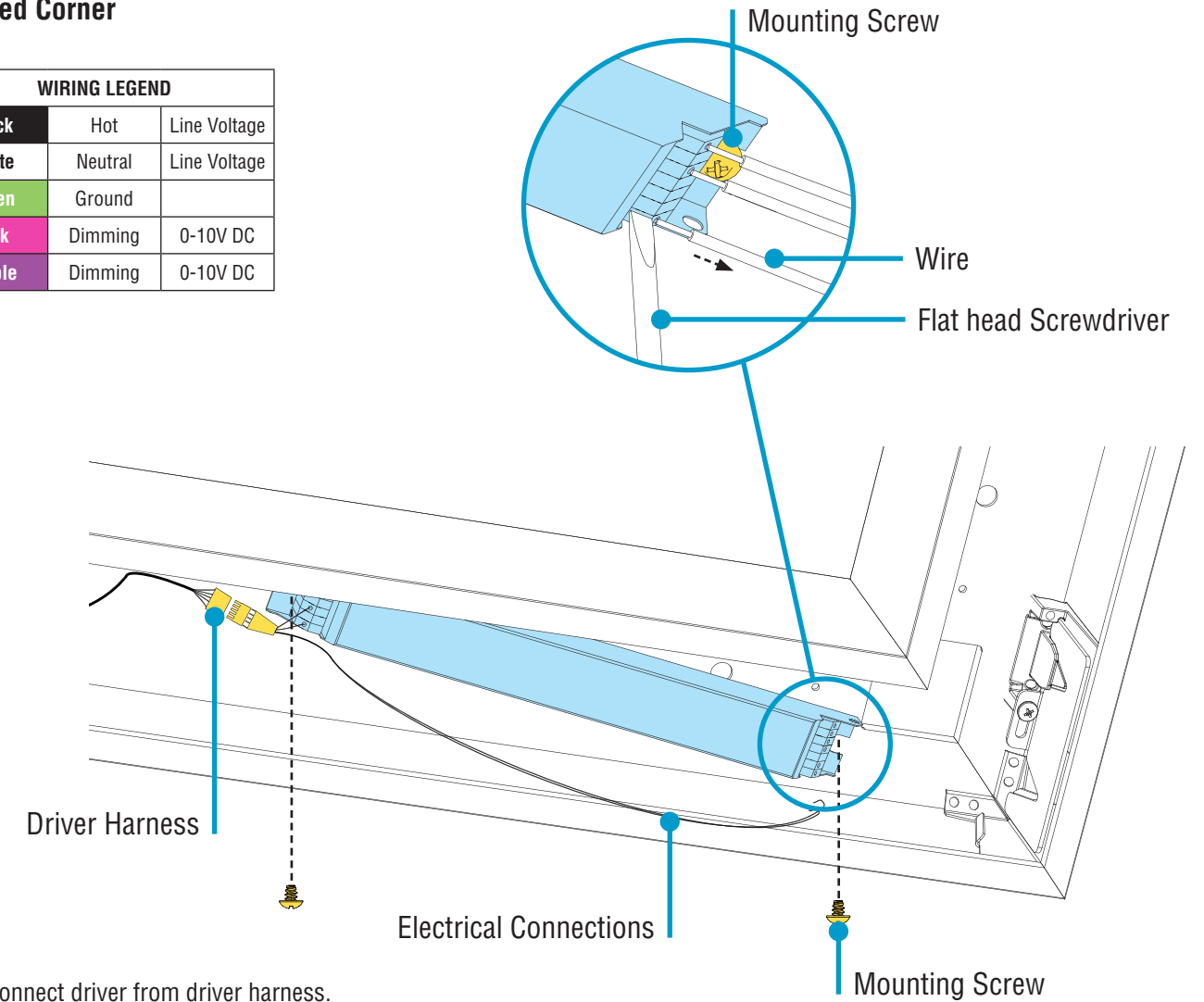

- Disconnect driver from driver harness.
- Disconnect electrical connections from driver.
- Release driver from luminaire body by removing mounting screws.
- Remove old driver and replace with new driver.
- Replace mounting screws.
- Reconnect electrical connections to driver.
- Reconnect driver to driver harness.



0-10V
Dimming

H04 Driver Replacement Installation Instructions

Step 3 - Closing Luminaire

A. Replace Backplate

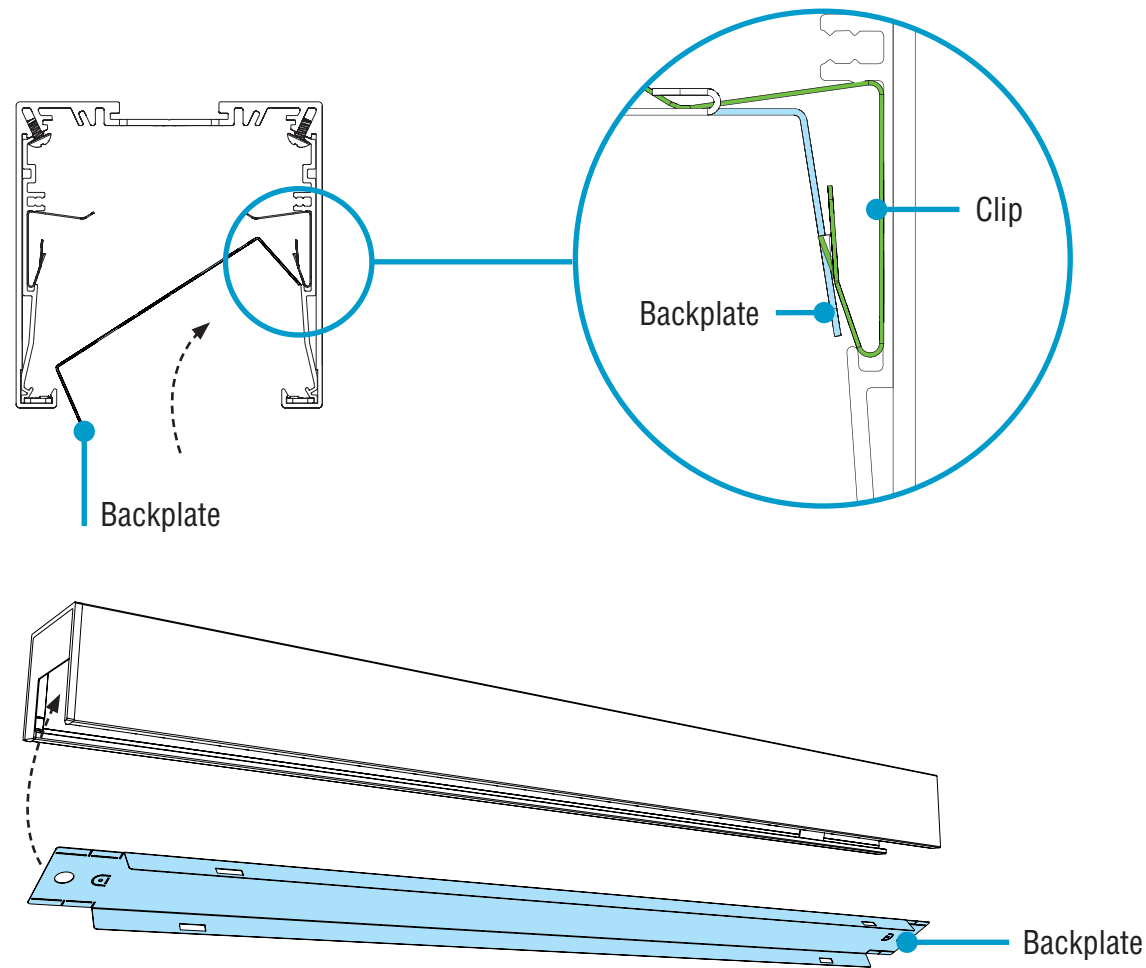

- Replace backplate by rotating back into luminaire body and snapping into clips.

B. Final Step - Replace Reflector

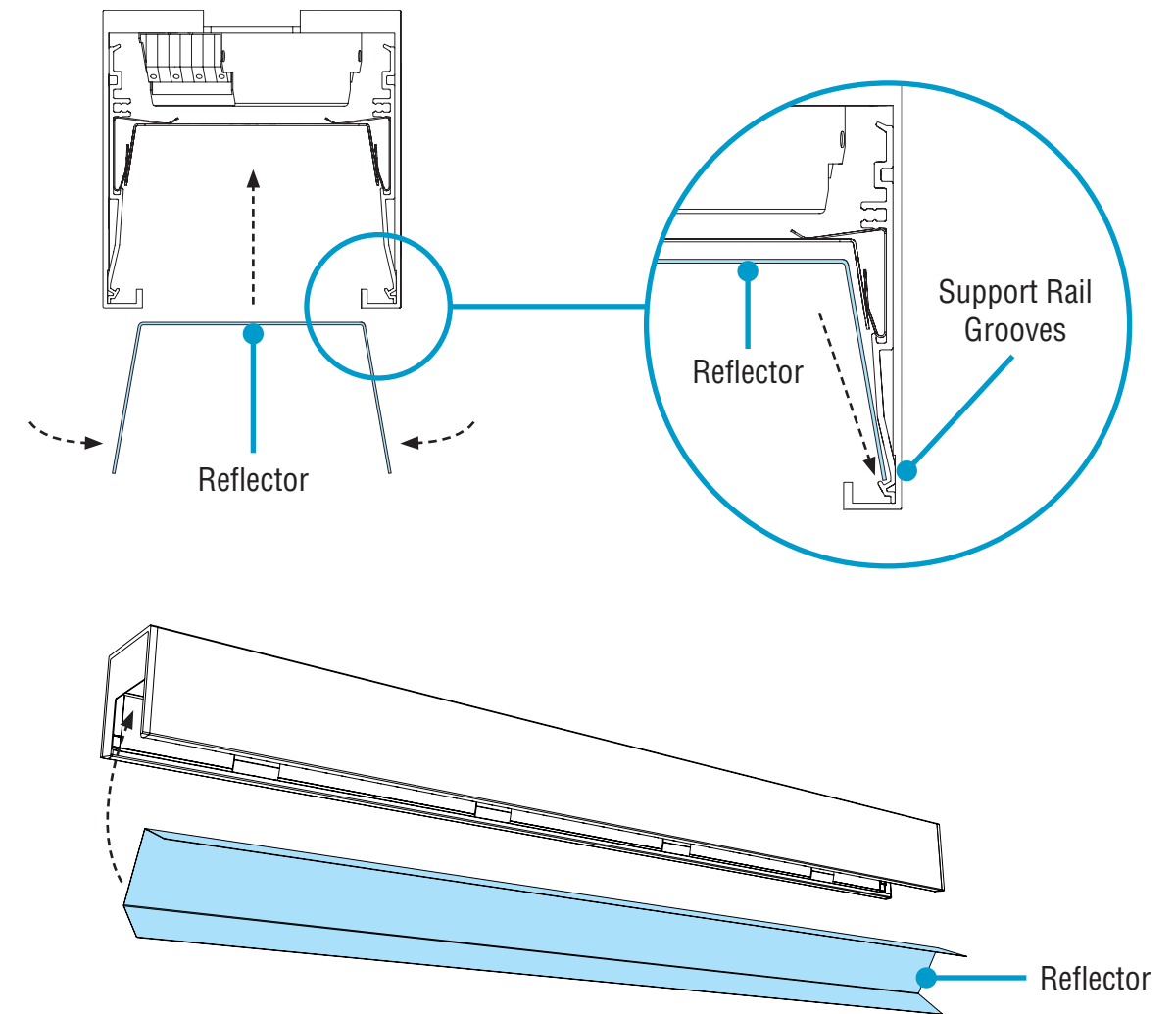

- **CAUTION:** Wear gloves to keep reflector surface clean.
- Carefully replace reflector by squeezing sides and inserting into luminaire body.
- Ensure reflector is pulled down so that the bottom edges catch the groove of the support rail.
- **NOTE:** Reflectors installed in joiner and ender luminaires are 1/4" longer. When installing the reflectors, overlap the reflector of the previous luminaire section by 1/4".
- Turn power on to luminaires.



Reflector
Installation